

Boardwalk

Park Street

TOTTERDOWN, BRISTOL

Park Street TOTTERDOWN

APPROXIMATE FLOOR AREA
73 SQM / 785 SQFT

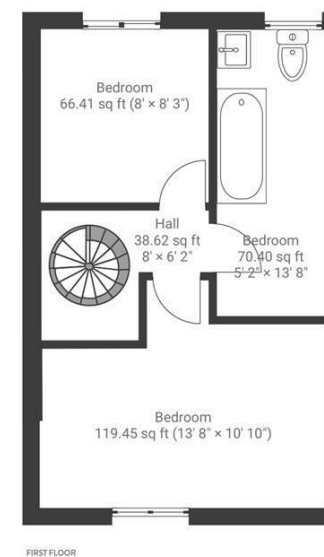
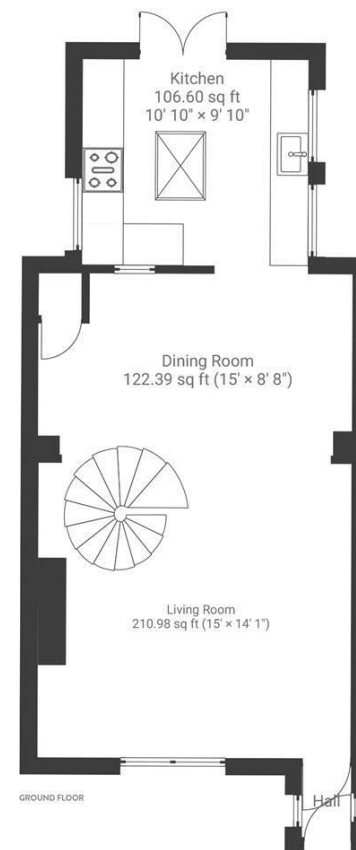

Boardwalk

Park Street

TOTTERDOWN, BRISTOL

£

£400,000

zzz

2 Bedrooms



BS4 3BJ



1 Bathrooms

"Park Street has such a lovely community, with events from Easter egg rolls to orchard parties. Our neighbours have been wonderful, and our daughter has loved exploring the garden, which is always full of birds and gets a real 'wow' from visitors."

