

St Peter's Court

BEDMINSTER

APPROXIMATE FLOOR AREA
64.5 SQM / 695 SQFT

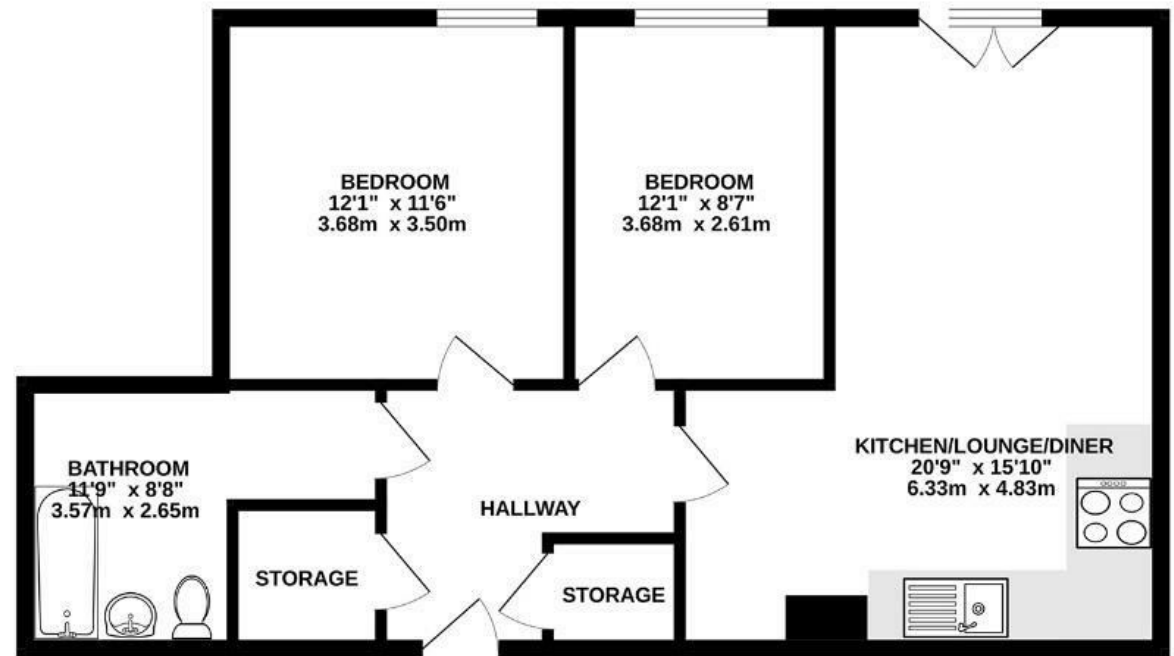

Illustrations are for reference purposes only, measurements are approximate, not to scale.

Boardwalk

New Charlotte , BRISTOL

£

£270,000



BS3 4AS

zzz

2 Bedrooms



1 Bathrooms

"This flat has been an amazing first home for us. It is a great size, with the second bedroom being an ideal double office where guests can also stay. Having the gym opposite and the library just next door has been so convenient. We regularly enjoy the local markets at Windmill Hill City Farm and the Tobacco Factory, as well as eating out along East Street, North Street, and Wapping Wharf."

