

Brentnall Way

FISHPONDS

APPROXIMATE FLOOR AREA
73 SQM / 786 SQFT



GARAGE
0 sq.ft. (0.0 sq.m.) approx.



GROUND FLOOR
399 sq.ft. (37.1 sq.m.) approx.

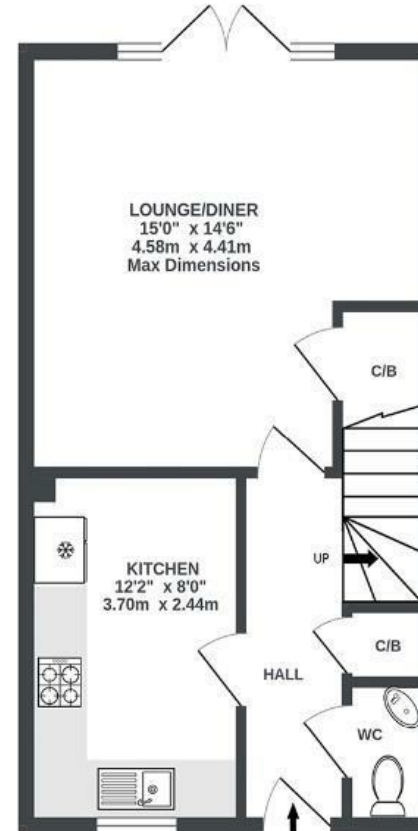

1ST FLOOR
386 sq.ft. (35.9 sq.m.) approx.

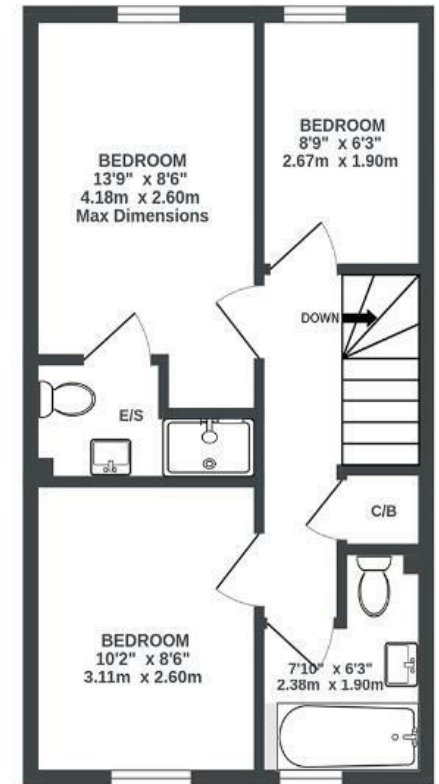

Illustrations are for reference purposes only, measurements are approximate, not to scale.

Boardwalk

Brentnall Way

FISHPONDS, BRISTOL



£390,000



3 Bedrooms



BS16 2FS



2 Bathrooms

"We love our home, being mere steps from the beautiful Oldbury Court, and a short walk to Fishponds Road to grab a coffee or a pint. There is a real sense of community, a neighbour is always on hand to borrow the odd tool from or take a delivery."

