

Bathwell Road

TOTTERDOWN

APPROXIMATE FLOOR AREA
49.1 SQM / 528 SQFT



FIRST FLOOR
528 sq.ft. (49.1 sq.m.) approx.

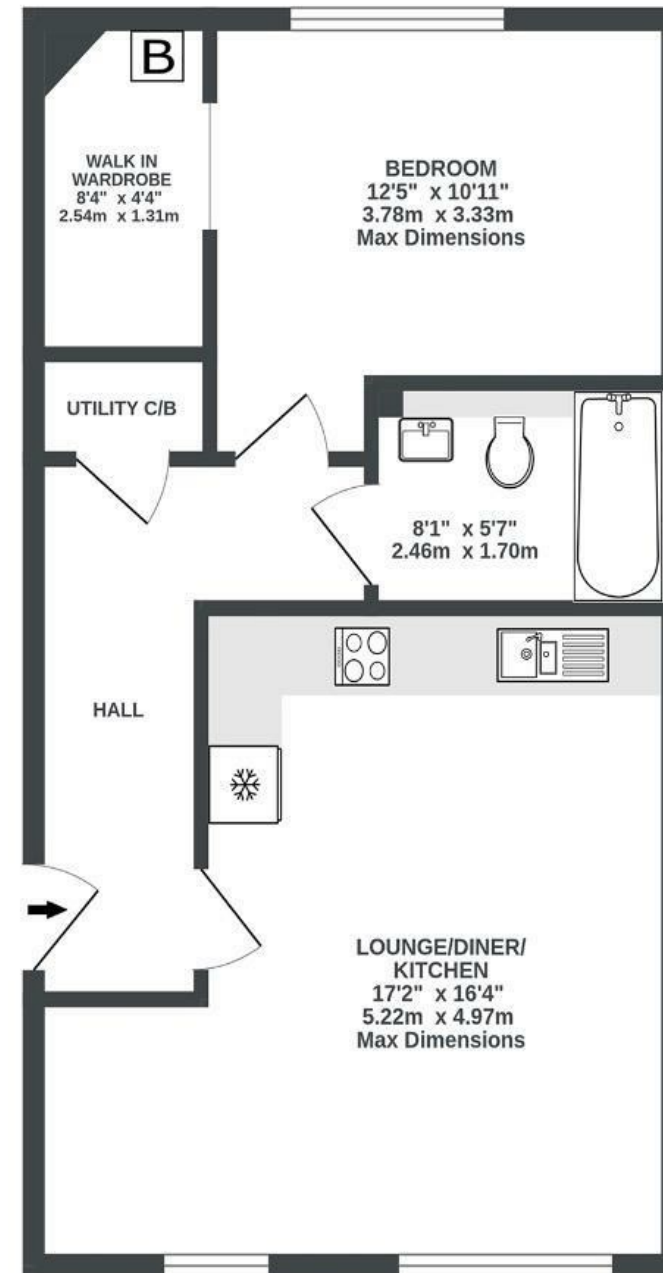

Illustrations are for reference purposes only, measurements are approximate, not to scale.

Boardwalk

Bathwell Road , BRISTOL



£240,000



BS4 3AN



1 Bedrooms



1 Bathrooms

"I bought this flat from a new build in September 2021, and it has been a dream to live in - I'm only moving because of starting a family, so I have to! The place is so energy efficient with the white goods, boiler and solar panels it came with that my bills are really low, and the shower pressure is awesome. I will probably miss my huge windows the most - morning sunlight floods my bedroom each morning, and I have a sweeping view of the St. Phillip's Marsh area that is set to be redeveloped around Temple Meads. The place feels secure but intimate/homey with the separate stairwell shared with two other flats (lovely neighbours)."

