



enfields

Enfields Hythe
3 Marsh Parade,
Hythe, Southampton
Hampshire, SO45 6AN
023 8084 9210
sa.hythe@enfields.co.uk

54 Linacre Road,
Guide Price £100,000

🛏 1 🚿 1 🚿 1



- Immediate 'exchange of contracts' available
- 2 bedrooms
- spacious lounge
- Modern kitchen
- Easy access to major road networks including the M27
- Being sold via 'Secure Sale'
- A three-piece bathroom suite
- Balcony
- Positioned on a quiet road
- Offering a variety of local amenities



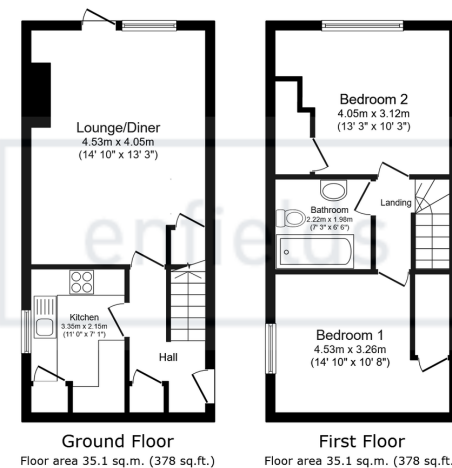

Total floor area: 70.2 sq.m. (755 sq.ft.)

This floor plan is for illustrative purposes only. It is not drawn to scale. Any measurements, floor areas (including any total floor area), openings and orientations are approximate. No details are guaranteed, they cannot be relied upon for any purpose and do not form any part of any agreement. No liability is taken for any error, omission or misstatement. A party must rely upon its own inspection(s). Powered by www.Propertybox.io

enfields

**Sold via Secure Sale online bidding. Terms & Conditions apply.
Starting Bid £100,000**

Nestled in the tranquil setting of Linacre Road, Thornhill, this first-floor flat offers a peaceful retreat from the bustle of city life.

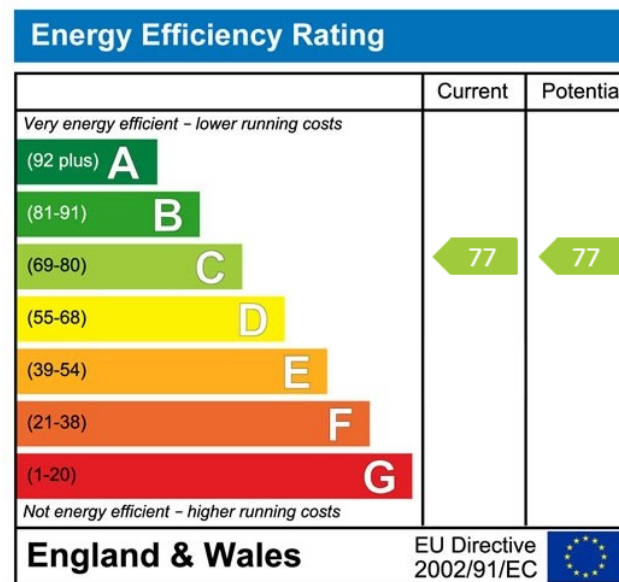

www.enfields-southampton.co.uk



It is Enfields policy to respect any sole agency currently in force and we would not be able to commence marketing until this has expired or been terminated. If you fail to terminate any previous agreement you could be liable for two sets of fees. Enfields Hythe is a trading name of YTF LTD Registered office: 345 Shirley Road, Southampton, Hampshire, England, SO15 3JD. Company Registration No: 10459987. VAT Registration No: 281 2975 81.

Enfields Lettings - Embley Management LTD T/A Enfields. Registered Address: 345 Shirley Road, Southampton, Hampshire, England, SO15 3JD. Company Registration No: 14847604. VAT Registration No: 439 8546 45.