

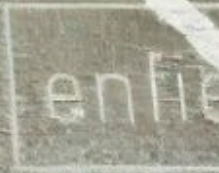

Enfields Hythe
3 Marsh Parade,
Hythe, Southampton
Hampshire, SO45 6AN
023 8084 8210
sales-hythe@enfields.co.uk



Pevensey Close, Southampton, S016

Asking Price £140,000

🛏 2 🚿 1 🛋 1



- Expansive top floor two-bedroom flat
- Freshly decorated in neutral tones to suit a wide audience
- Long Lease Remaining (176 years)
- Family bathroom with a modern, neutral finish
- Quiet, well-maintained residential setting
- Ready to move into with no forward chain
- Well-designed layout maximising space and functionality
- Large windows offering ample natural light
- Off-road communal parking for convenience
- Excellent access to Southampton city centre, transport links and local amenities



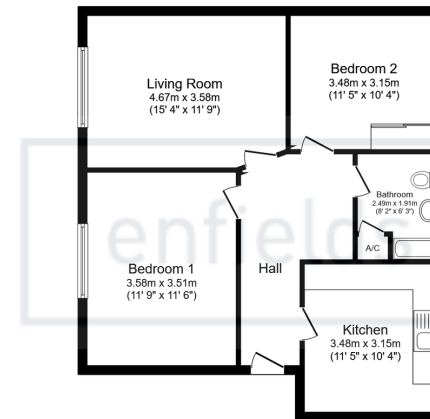

Second Floor
Floor area 71.3 sq.m. (768 sq.ft.)

Total floor area: 71.3 sq.m. (768 sq.ft.)

This floor plan is for illustrative purposes only. It is not drawn to scale. Any measurements, floor areas (including any total floor area), openings and orientations are approximate. No details are guaranteed, they cannot be relied upon for any purpose and do not form part of any agreement. No liability is taken for any error, omission or misstatement. A party must rely upon its own inspection(s). Powered by www.Propertybox.io

enfields

NO FORWARD CHAIN

An expansive two-bedroom top floor flat, freshly decorated in neutral tones, with open plan living, large windows and communal parking. Ready to move into and with 176 Lease remaining, this no-chain property is perfect for first-time buyers or investors.

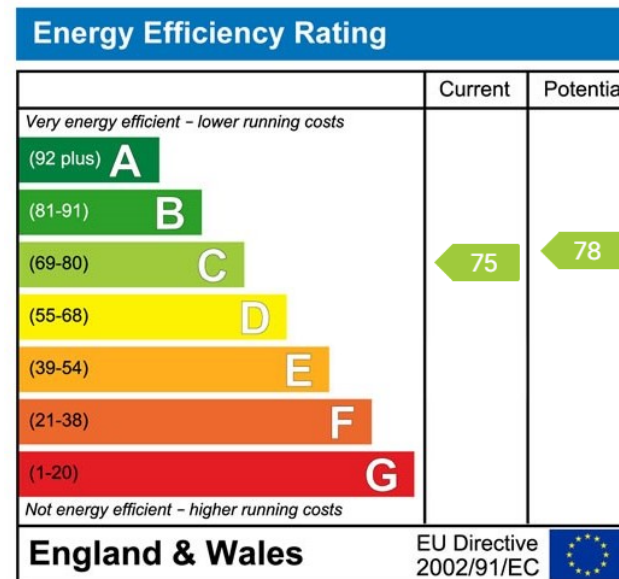

www.enfields-southampton.co.uk



It is Enfields policy to respect any sole agency currently in force and we would not be able to commence marketing until this has expired or been terminated. If you fail to terminate any previous agreement you could be liable for two sets of fees. Enfields Hythe is a trading name of YTF LTD Registered office: 345 Shirley Road, Southampton, Hampshire, England, SO15 3JD. Company Registration No: 10459987. VAT Registration No: 281 2975 81.

Enfields Lettings - Embley Management LTD T/A Enfields. Registered Address: 345 Shirley Road, Southampton, Hampshire, England, SO15 3JD. Company Registration No: 14847604. VAT Registration No: 439 8546 45.