



3 Bed  
House - Terraced  
located in

£1,150 Per month



**SMART STREET**  
THE PROPERTY PEOPLE



## DIRECTIONS

## CONTACT

14 Withambrook Park  
Grantham  
NG31 9ST

E: [info@smartstreetproperty.com](mailto:info@smartstreetproperty.com)  
T: 01476 247107

### Ground Floor

Approx. 37.1 sq. metres (399.1 sq. feet)

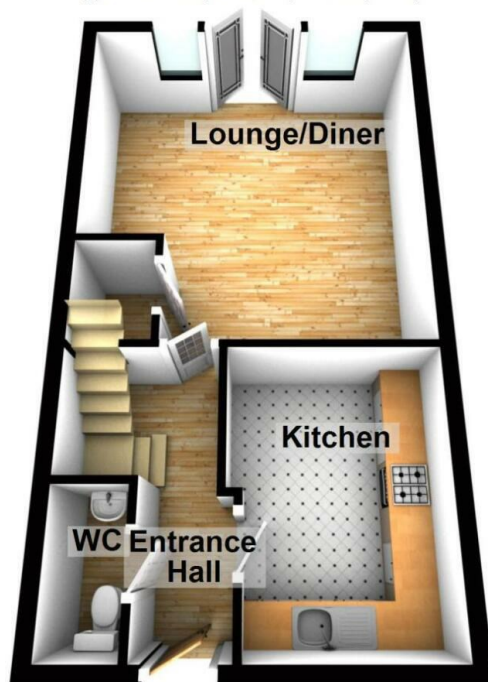

### First Floor

Approx. 37.1 sq. metres (399.1 sq. feet)

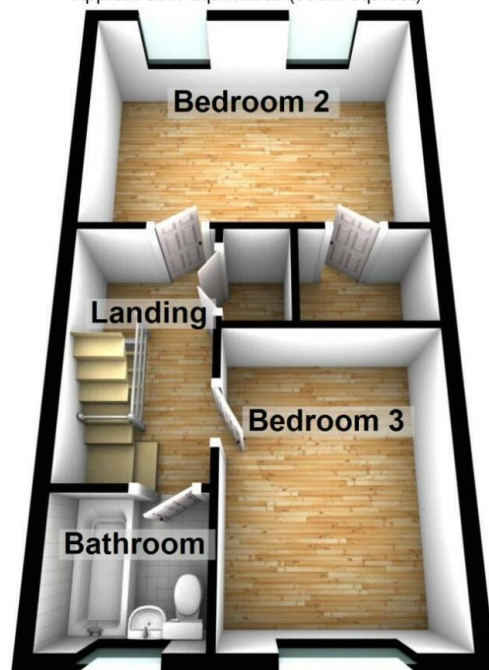

### Second Floor

Approx. 27.0 sq. metres (290.2 sq. feet)



Total area: approx. 101.1 sq. metres (1088.5 sq. feet)

Energy Efficiency Rating		
	Current	Potential
Very energy efficient - lower running costs		
(92 plus) <b>A</b>		
(81-91) <b>B</b>		
(69-80) <b>C</b>		
(55-68) <b>D</b>		
(39-54) <b>E</b>		
(21-38) <b>F</b>		
(1-20) <b>G</b>		
Not energy efficient - higher running costs		
EU Directive 2002/91/EC		
England & Wales		

79