

ASKING PRICE

£290,000

Belmont Road

London, N15 3LS

EPC RATING: C    COUNCIL TAX BAND: B

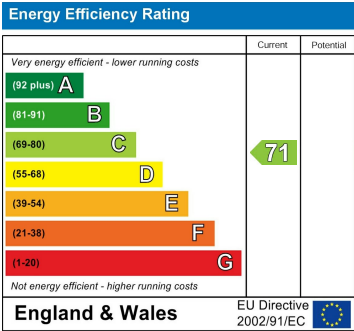
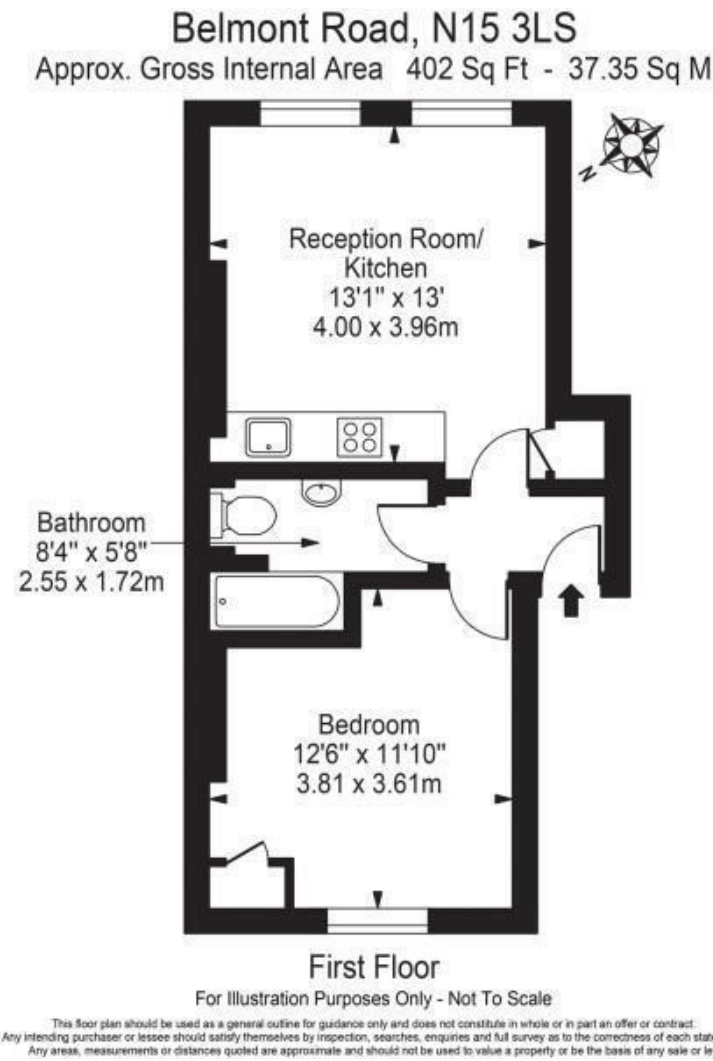

Agents Note: Whilst every care has been taken to prepare these particulars, they are for guidance purposes only. All measurements are approximate and are for general guidance purposes only and whilst every care has been taken to ensure their accuracy, they should not be relied upon and potential buyers/tenants are advised to recheck the measurements.

**Christopher Mark**  
ESTATE AGENTS

OFFICE ADDRESS

25 Heddon Court Parade  
London  
EN4 0DB

OFFICE DETAILS

02033 690989  
Hello@christophermark.co.uk