



FITZJOHN
SALES & LETTINGS

76 Central Avenue,
Dogsthorpe, Peterborough,
PE1 4LH

Tel 01733 921700
info@fitzjohnstateagents.com
www.fitzjohnstateagents.com



Oakfields 74-76 Bradwell Road Peterborough PE3 9QL

Asking price £120,000



A fantastic opportunity to acquire this well-presented one-bedroom first floor apartment, situated in the highly sought-after Netherton area of Peterborough. This property is ideal for first-time buyers, downsizers, or buy-to-let investors, offering a comfortable and practical living space



The accommodation comprises an entrance hall leading to a lounge/diner, a modern fitted kitchen, a generously sized double bedroom, and a well-maintained bathroom. Externally, the property benefits from a single garage and communal resident parking to the rear.

In our valuers' opinion, this property is perfectly suited to First Time Buyers, Downsizers & Buy-To-Let Investors with a potential rental income of £850 per calendar month.

The apartment has a remaining lease of 957 years and a service charge of £175 per month. Council Tax is Band B and the Energy Performance Rating is C.

This is an excellent chance to secure a property in a prime location in Peterborough. Early viewing is highly recommended.

Entrance Hall - 8'11 x 4'0

Wood flooring, wooden doors to all accommodation, three storage cupboards, airing cupboard.

Lounge - 15'0 x 11'4

Wood flooring, electric storage heater, uPVC double glazed window to the rear.

Kitchen - 7'6 x 9'4

Vinyl flooring, uPVC double glazed window facing the rear, fitted wall and base units, one and half bowl sink with mixer tap and drainer, integrated electric oven with four ring electric hob and extractor hood over, space for washing machine and fridge/freezer, part tiled walls.

Bedroom One - 14'10 x 8'9

Carpeted flooring, uPVC double glazed window facing the side, two electric panel heaters.

Bathroom - 5'10 x 8'11

Vinyl flooring, electric heater, standard WC, panelled bath with electric shower over, pedestal mounted wash hand basin, extractor fan, part tiled walls.

Garage -

Up and over door.

Area Map



Floor Plans

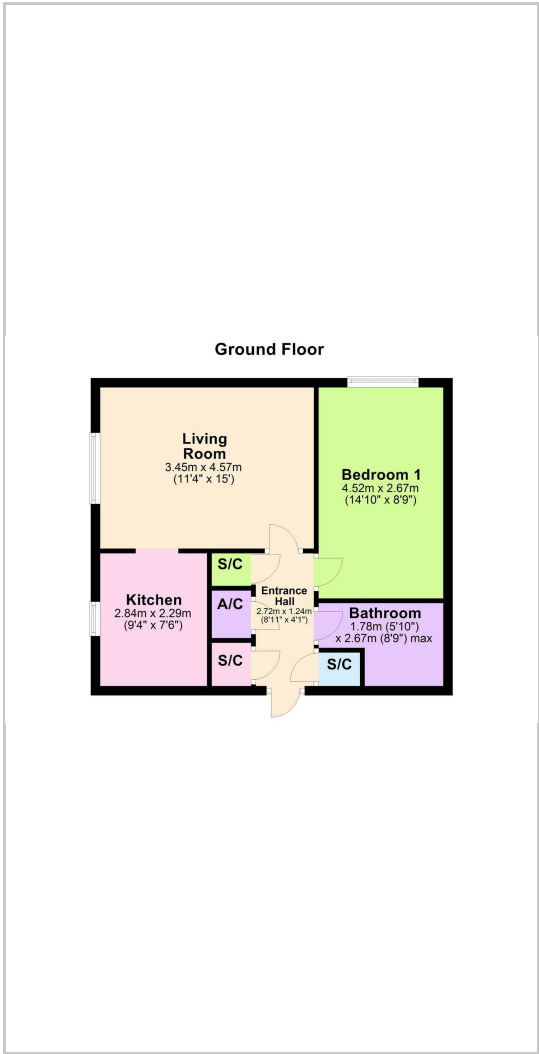

Energy Efficiency Graph

