



Sheppard
& Bear

Heath Mead | Heath | Cardiff | CF14 3PJ

£150,000



Sheppard & Bear

Heath Mead | Heath
Cardiff | CF14 3PJ
£150,000

Nestled in the charming area of Heath Mead, Cardiff, this two-bedroom semi detached house presents an exciting opportunity for cash buyers seeking a refurbishment project. While the property requires significant work, it holds immense potential to become a delightful home for a small family or a couple once completed.

The house features a spacious lounge/dining room, a kitchen, and a bathroom, providing a solid foundation for your renovation ideas. The property also boasts a driveway and a rear garden, offering outdoor space for relaxation or gardening enthusiasts.

Conveniently located just a stone's throw away from the University Hospital of Wales, this home benefits

- Ideal for cash buyers
 - Two bedrooms
 - Close to University Hospital
 - Near A48 and M4
 - Driveway and garden
- Needs refurbishment
 - Semi detached
 - Great transport links
 - No onward chain
 - Perfect project opportunity

Entrance hall

Kitchen

8'7 x 7'1 (2.62m x 2.16m)

Lounge/dining room

17'3 x 12'7 (5.26m x 3.84m)

First floor landing

Bedroom one

11'4 plus door recess x 12'6
(3.45m plus door recess x
3.81m)

Bedroom two

13'0 max x 6'8 max (3.96m max x
2.03m max)

Bathroom

7'0 x 5'5 (2.13m x 1.65m)

Outside and parking

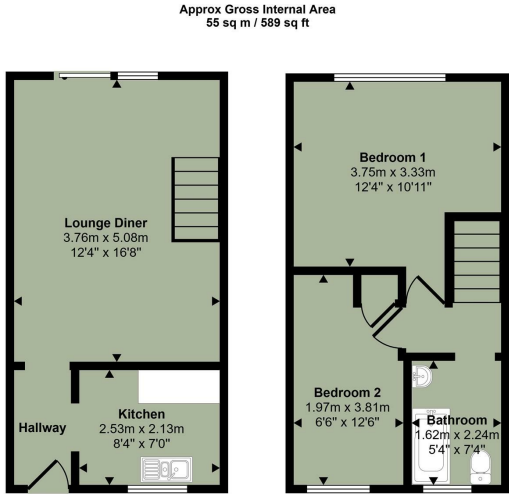

Ground Floor
Approx 27 sq m / 295 sq ft

First Floor
Approx 27 sq m / 294 sq ft

This floorplan is only for illustrative purposes and is not to scale. Measurements of rooms, doors, windows, and any items are approximate and no responsibility is taken for any error, omission or mis-statement. Icons of items such as bathroom suites are representations only and may not look like the real items. Made with Made Snappy 360.

Energy Efficiency Rating		
	Current	Potential
Very energy efficient - lower running costs		
(92 plus) A		
(81-91) B		
(69-80) C		
(55-68) D		
(39-54) E		
(21-38) F		
(1-20) G		
Not energy efficient - higher running costs		
England & Wales	EU Directive 2002/91/EC	

Council Tax Band D
EPC Rating

Cyncoed
Cardiff
CF23 6SZ
02921 051927
gavin@sheppardandbear.com