

FREEHOLD



House - Detached (EPC Rating: )

# 3 REVESTON STEADINGS, WHITBURN, EH47 9AN

Offers in the region of  
**£550,000**

## FEATURES

- 4 spacious bedrooms
- Detached house in Whitburn
- Family-friendly location
- Easy access to transport
- 3 modern bathrooms
- Bright reception room
- Close to local amenities
- Images for illustration only

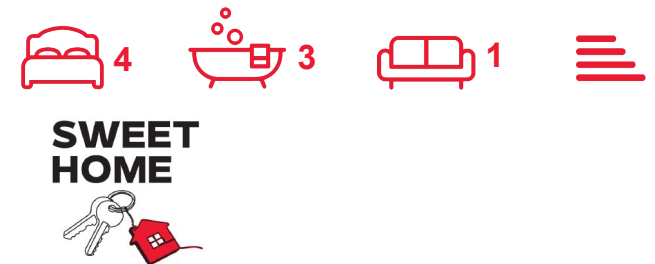

# 4 Bedroom House - Detached located in Whitburn

Caroline Morrison from Sweet Home is delighted to present this stunning new-build home, due for completion in Winter 2025

Set in a peaceful rural setting Heartlands near Whitburn, this beautifully designed 4-bedroom detached property perfectly blends modern comfort with country charm. With spacious interiors and luxurious finishes, it's ideal for family life.

Step inside to a welcoming hallway leading to a stylish open-plan lounge, dining, and Luxurious kitchen with integral appliances —perfect for relaxed family living or entertaining guests. Also on the ground floor is a flexible bedroom, great as a guest room or home office, alongside a sleek modern shower room.

Upstairs, the generous master bedroom boasts its own en-suite shower room, creating a private retreat. Two further well-sized bedrooms offer ample space for the whole family, while the elegant family bathroom completes the upper level.

Call us on  
**01236677500**  
[sales@sweet-home.co.uk](mailto:sales@sweet-home.co.uk)

Council Tax Band  
**F**

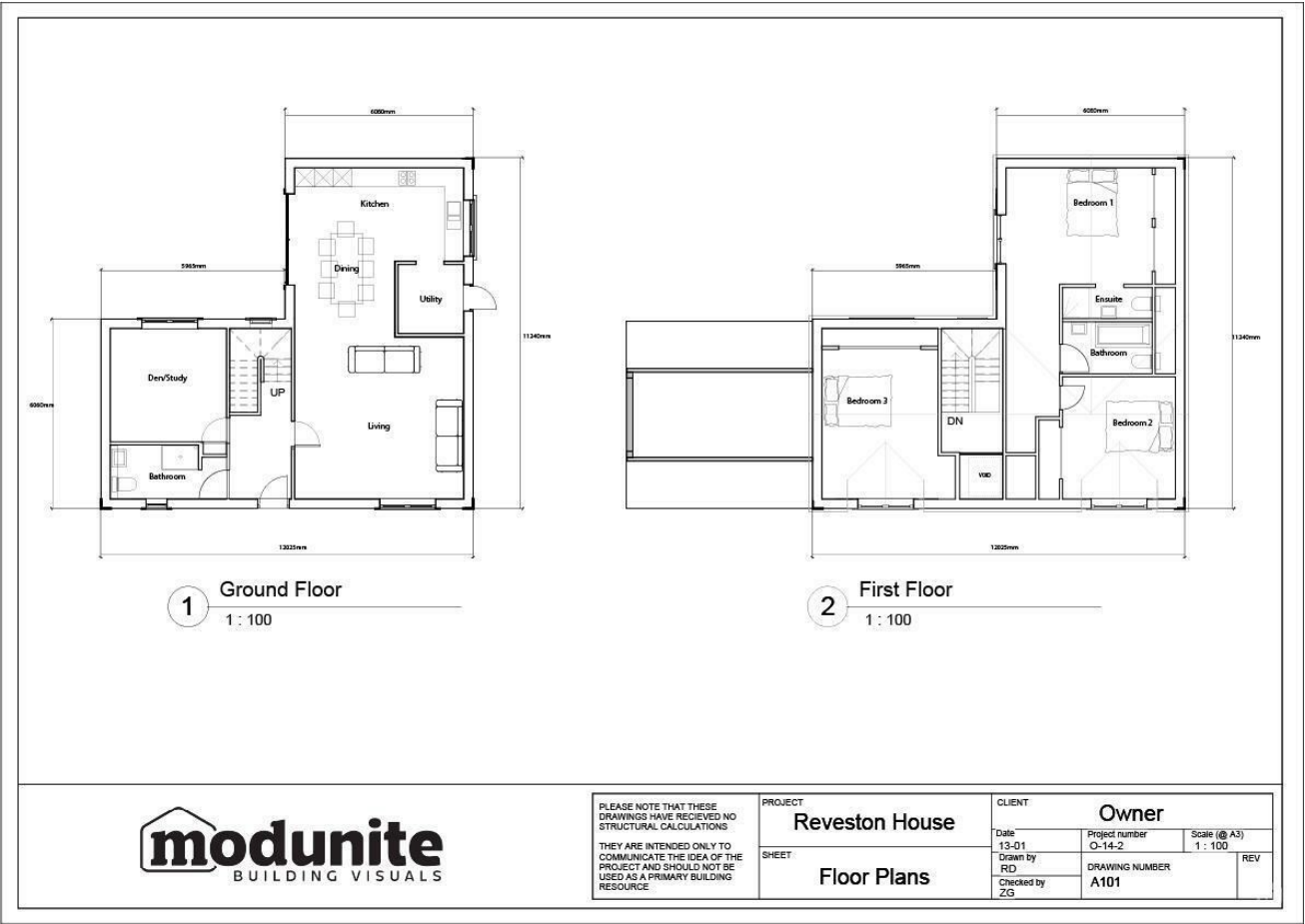

Energy Efficiency Rating		
	Current	Potential
Very energy efficient - lower running costs		
(92 plus) A		
(81-91) B		
(69-80) C		
(55-68) D		
(39-54) E		
(21-38) F		
(1-20) G		
Not energy efficient - higher running costs		
Scotland		EU Directive 2002/91/EC

Agents Note: Whilst every care has been taken to prepare these particulars, they are for guidance purposes only. All measurements are approximate and are for general guidance purposes only and whilst every care has been taken to ensure their accuracy, they should not be relied upon and potential buyers are advised to recheck the measurements.

