



Saxon Road Southport, PR8 2AX £950 Per Month

Flexi-Agent are delighted to present this fantastic two bedroom, apartment to the rental market. Located in the sought after residential area of Birkdale, it is surrounded by a wealth of local amenities, is a short walk from local transport links providing easy access to Southport town centre, & is a stone's throw from the idyllic Birkdale village.

The property briefly comprises: Entrance hallway, spacious living room, fitted kitchen, two good-sized bedrooms, WC and a bathroom.

Externally, the grounds of the property are well maintained, and there is off-road parking and a garage.

Early inspection of this property is strongly recommended to fully appreciate the accommodation on offer.

Viewings are available on request.

Deposit £1096.15

Viewing

Please contact our Flexi-Agent Southport Lettings Office on 01704 889455 if you wish to arrange a viewing appointment for this property or require further information.



Floor Plan

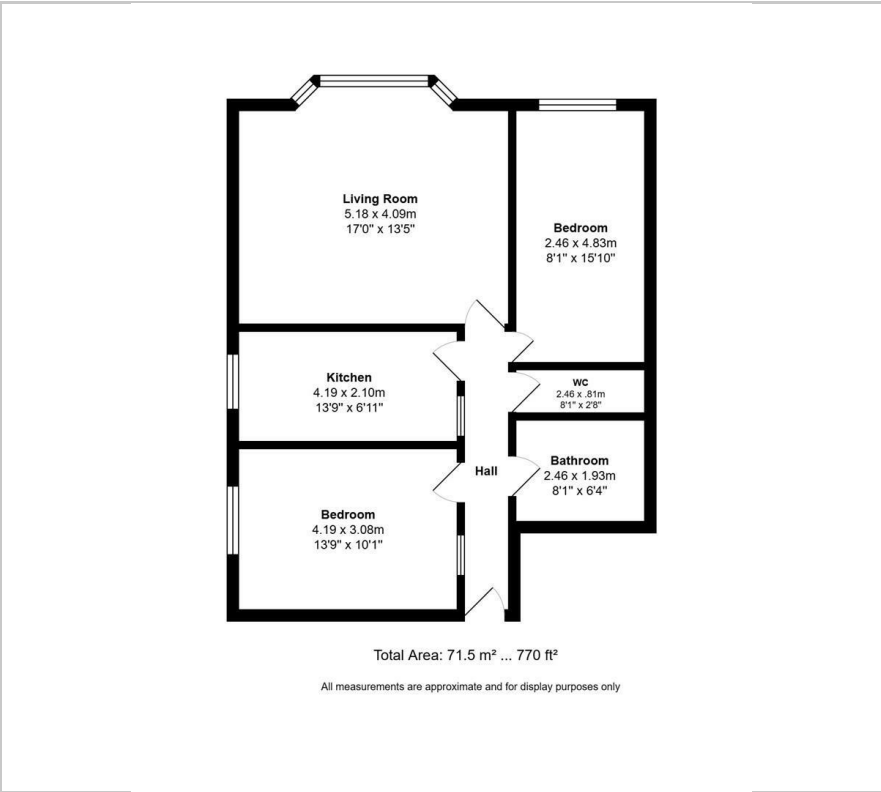

Area Map

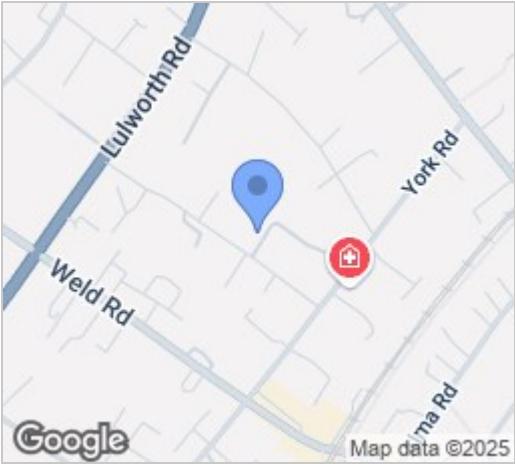

Energy Efficiency Graph



These particulars, whilst believed to be accurate are set out as a general outline only for guidance and do not constitute any part of an offer or contract. Intending purchasers should not rely on them as statements of representation of fact, but must satisfy themselves by inspection or otherwise as to their accuracy. No person in this firms employment has the authority to make or give any representation or warranty in respect of the property.