



Aughton Road Southport, PR8 2AF **£1,200 Per Month**

Flexi-Agent are delighted to present this stunning two bedroom ground floor apartment property to the rental market. Located in the sought after residential area of Birkdale, it is surrounded by a wealth of local amenities, has easy access to local transport links & is a short walk from Birkdale village and plenty of great local schools.

The property briefly comprises: Entrance hallway with a storage cupboard, a spacious open plan living/dining room, modern kitchen with door leading to the rear courtyard garden, two well proportioned bedrooms and a three piece family bathroom.

Externally there access to the sun catching courtyard garden, and off road parking.

Early inspection of this property is strongly recommended to fully appreciate the accommodation on offer.

Viewing is available immediately by appointment.

Viewing

Please contact our Flexi-Agent Southport Lettings Office on 01704 889455 if you wish to arrange a viewing appointment for this property or require further information.



Floor Plan

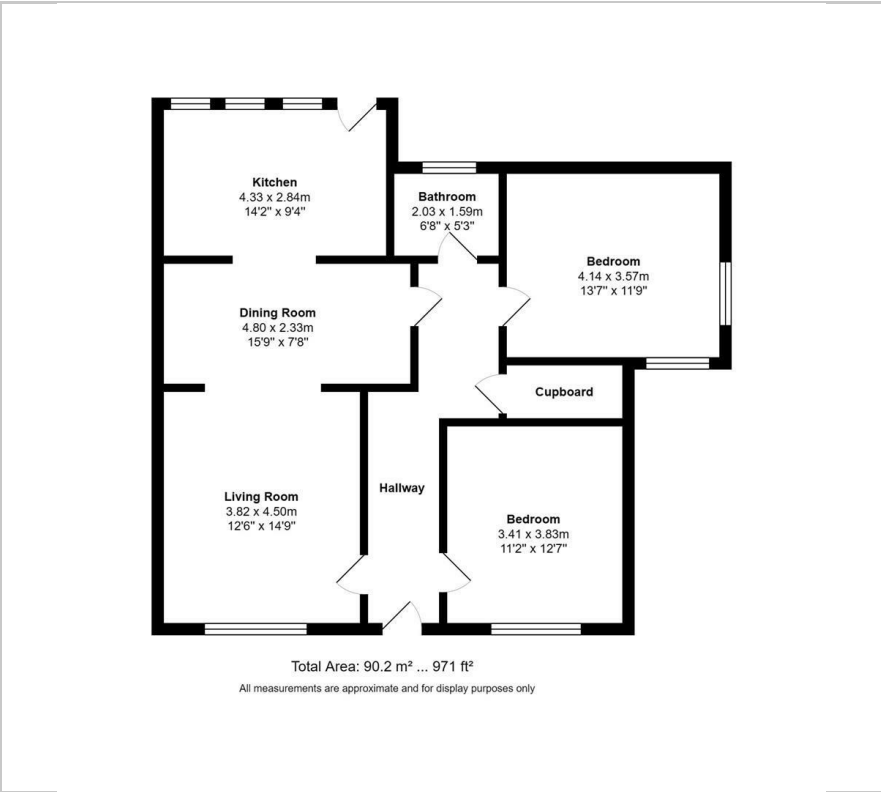

Area Map

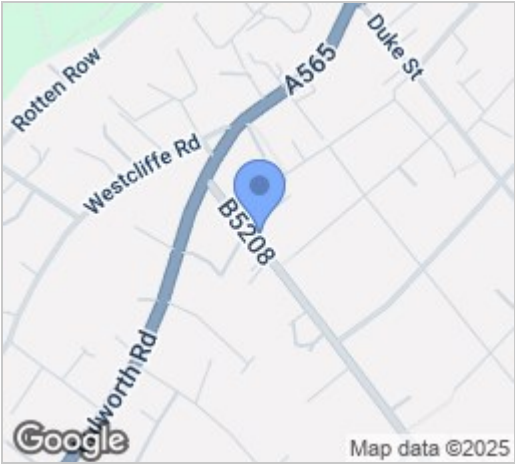

Energy Efficiency Graph



These particulars, whilst believed to be accurate are set out as a general outline only for guidance and do not constitute any part of an offer or contract. Intending purchasers should not rely on them as statements of representation of fact, but must satisfy themselves by inspection or otherwise as to their accuracy. No person in this firms employment has the authority to make or give any representation or warranty in respect of the property.