



SHAKESPEARE ROAD

BARRY

SHAKESPEARE ROAD

BARRY, CF 62 9T P

CHAIN FREE

£230,000 -

FREEHOLD



3 Bed



1 Bath



893.41 sq ft

Located on Shakespeare Road in Barry, this well-presented 3-bedroom semi-detached home offers generous living space, ideal for families or first-time buyers.

Featuring two spacious and versatile reception rooms, a modern family bathroom, and three well-proportioned bedrooms, the property is both comfortable and functional.

With a well-maintained exterior and situated close to local schools, parks, and everyday amenities, this charming home combines convenience with a warm community feel. A fantastic opportunity not to be missed, early viewing is highly recommended.

HALLWAY
6'10" x 12'04"

LIVING ROOM
10'04" x 13'11"

KITCHEN
6'06" x 12'01"

DINING ROOM
10'04" x 10'06"

OUTSIDE HALLWAY
2'11" x 7'02"

UTILITY
5'01" x 6'09"

BEDROOM ONE
14'01" x 9'07"

BEDROOM TWO
10'06" x 10'04"

BEDROOM THREE
7'06" x 9'0"

SHOWER ROOM
6'08" x 7'0"





Energy Efficiency Rating		
	Current	Potential
Very energy efficient - lower running costs		
(92 plus) A		82
(81-91) B		
(69-80) C		
(55-68) D	63	
(39-54) E		
(21-38) F		
(1-20) G		
Not energy efficient - higher running costs		
England & Wales		EU Directive 2002/91/EC 



Shakespeare Road, Barry, CF62 9TP

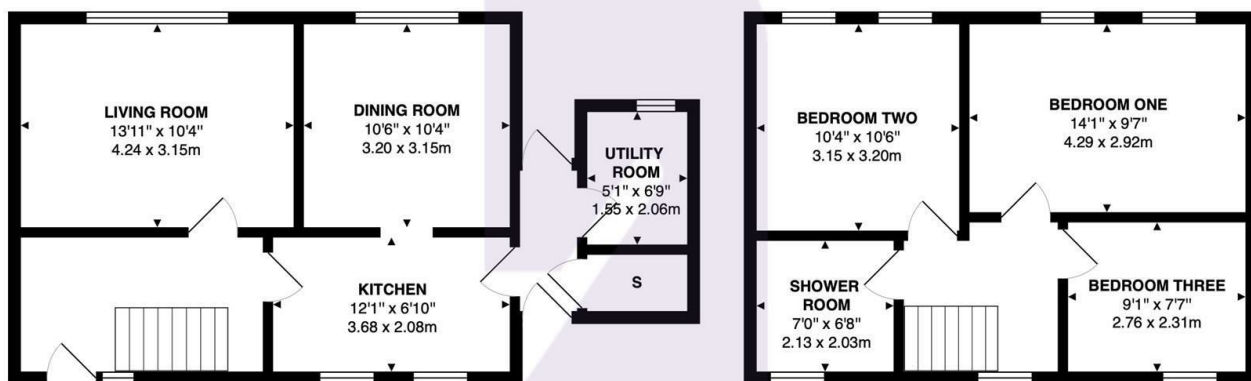

Total Area: 962 ft² ... 89.3 m²

All measurements are approximate and for display purposes only

BARRY & THE VALE'S HOME FOR

STYLISH SALES
& LETTINGS



KNIGHTS