



**Turnpike Lane, London, N8 0PH**

**£2,795 pcm**

**arley**  
property

**Bedrooms:** 3 | **Bathrooms:** 1 | **Receptions:** 1

**Date First Available:** 16/01/2026

**Council Tax Band:** D

**Deposit:** £3,225

- Three double bedrooms
- Open-plan living space
- Private garden
- Modern fitted kitchen
- Furnished or unfurnished
- Available now

A beautifully presented three double bedroom modern garden flat, set within an attractive period conversion in North London, ideally positioned moments from the amenities of Turnpike Lane and Wood Green.

This spacious ground-floor apartment offers a generous open-plan reception room with a fully integrated kitchen, three well-proportioned double bedrooms, a contemporary bathroom suite, and direct access to a private rear garden.

Finished with neutral décor and wood flooring throughout, the property combines modern living with period charm.

It further benefits from excellent transport links, with easy access to central London via Turnpike Lane Underground Station (Piccadilly Line) and Hornsey Railway Station. The open green spaces of Alexandra Palace are also close by.

Available now.







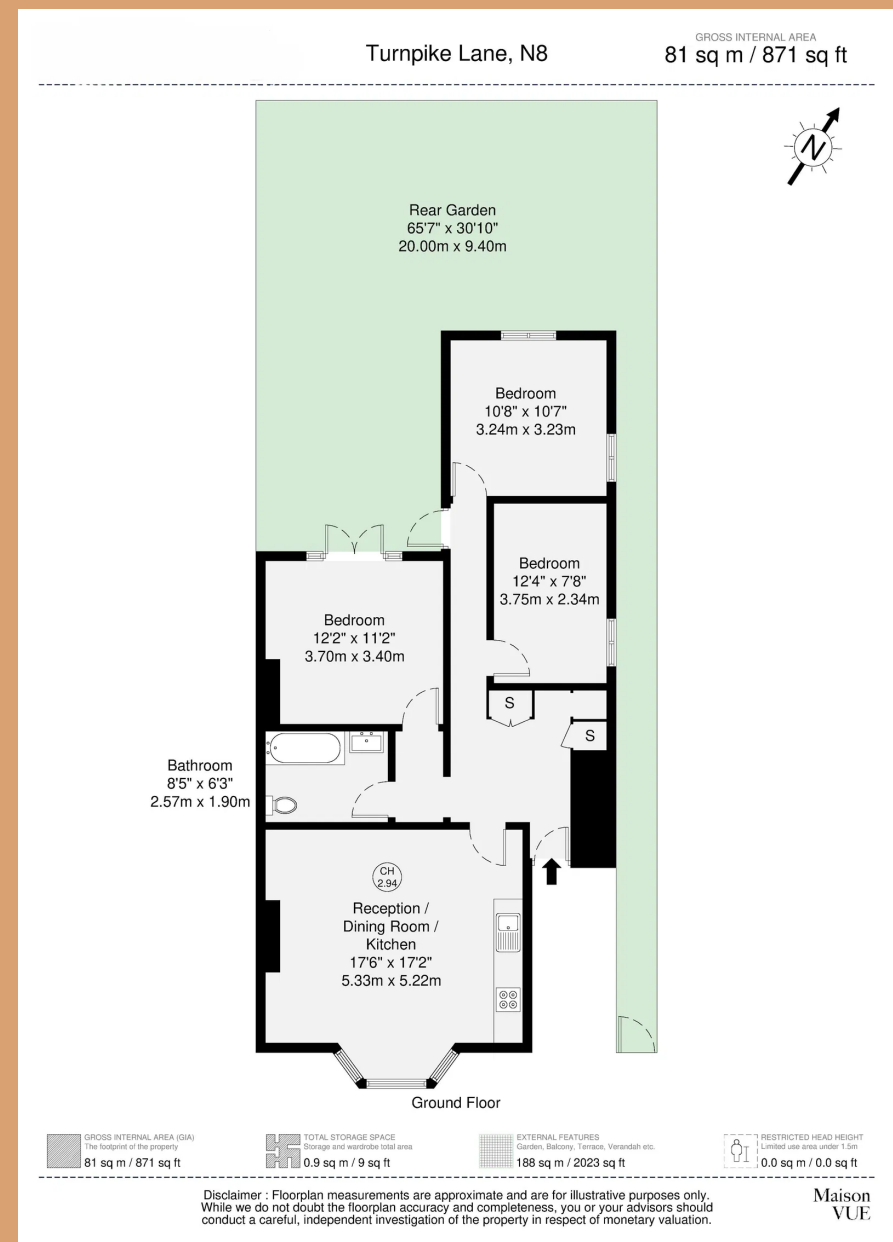
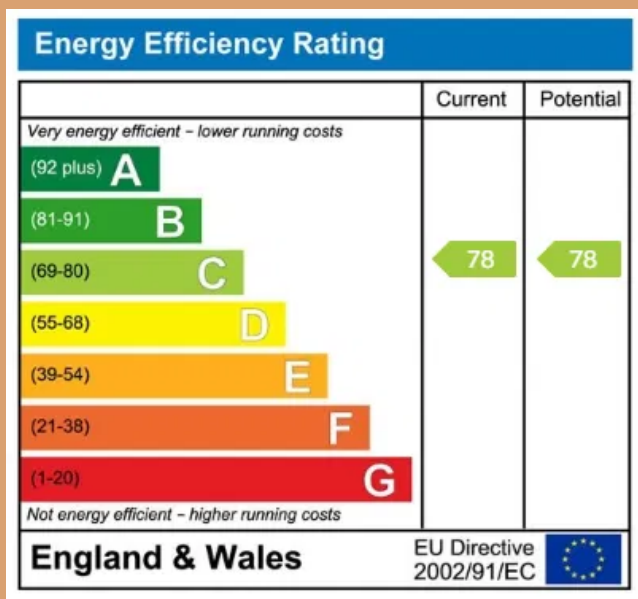

**James Marshall**

James@arleyproperty.com  
07515 448 385

[www.arleyproperty.com](http://www.arleyproperty.com)

**arley**  
property