



WEST RIDING

---

SELLING HOMES

Oldham Road, Lydgate, Saddleworth

£600,000

🛏 4 🚿 2 🛋 4



- 5 Bedroom Property
- Within Walking Distance of Local Primary School
- Within Walking Distance of Local Amenities
- 10 Minute Drive to Greenfield Train Station
- Kitchen Dining Room Extension
- Driveway for Three to Four Cars
- Private Rear Garden
- Energy Rating - D

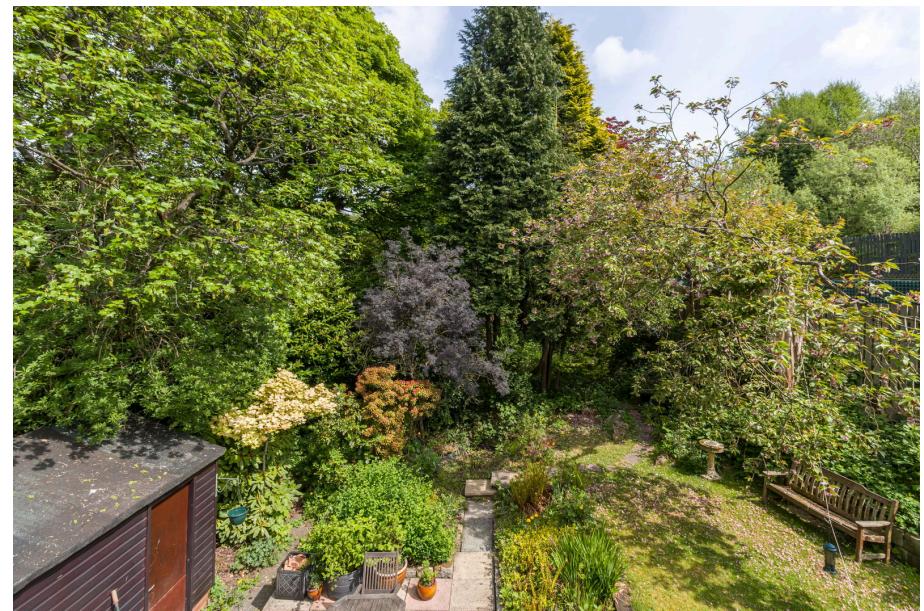

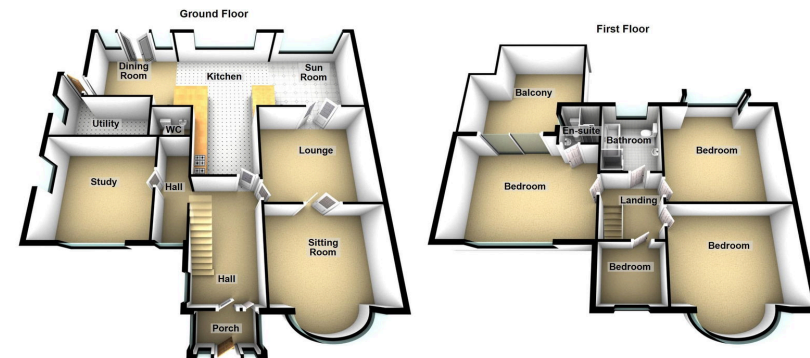

This spacious five-bedroom family home offers breathtaking views of the countryside and the Manchester skyline, and is a dream for nature lovers. The back garden features two ponds and abundant wildlife, with occasional deer sightings. The property is set back from the main road and includes a driveway that accommodates three to four cars, leading to a single-story garage.

Energy Efficiency Rating		
	Current	Potential
Very energy efficient - lower running costs		
(92 plus) <b>A</b>		
(81-91) <b>B</b>		
(69-80) <b>C</b>		79
(55-68) <b>D</b>	62	
(39-54) <b>E</b>		
(21-38) <b>F</b>		
(1-20) <b>G</b>		
Not energy efficient - higher running costs		
<b>England &amp; Wales</b>	EU Directive 2002/91/EC	



hello@west-riding.co.uk

01457 819181

www.west-riding.co.uk