

ALLDAY  
& MILLER



Clyfford Road, Ruislip, HA4 6PS  
£550,000

2 1 1 c





Clyfford Road, Ruislip, HA4 6PS

**£550,000**

- Two Bedroom Terraced Home
- Open Plan Kitchen Diner
- Moments from Ruislip Gardens Station
- Nearby to Highly Regarded Schools
- Bi Folding Doors to Rear Garden
- Extended
- Stylish Interiors Throughout
- Short Drive to A40/M25/M4
- Off Street Parking to Front
- Modern Kitchen & Bathroom

## Description

This beautifully presented family home offers a perfect blend of contemporary living and welcoming charm, ideal for modern family life.

The ground floor boasts a bright and airy reception room, flooded with natural light and providing a relaxing space. To the rear, you'll find a stylish fitted kitchen and dining area, thoughtfully designed boasting an island, ample workspace and bifold doors.

The first floor features two generous double bedrooms, both well-proportioned and tastefully finished, alongside a modern family bathroom.

Externally, the property continues to impress with a front driveway providing convenient off-street parking, while to the rear features a private rear garden.

## Situation

Clyfford Road is well positioned for amenities of South Ruislip, Ruislip Gardens and Eastcote. Local transport links are available from nearby Ruislip Gardens train station offering the Central lines into London. Ruislip Manor station is a short drive or stroll away and is useful for the Metropolitan/Piccadilly line providing reliable links into the City. For the motorist the A40/M25 is a short drive away whilst for families, there are a number of highly regarded schools that cater for children of all ages within close proximity including St Swithun Wells, Ruislip High, Newnham Primary and Queensmead Secondary school.





Floor Plans

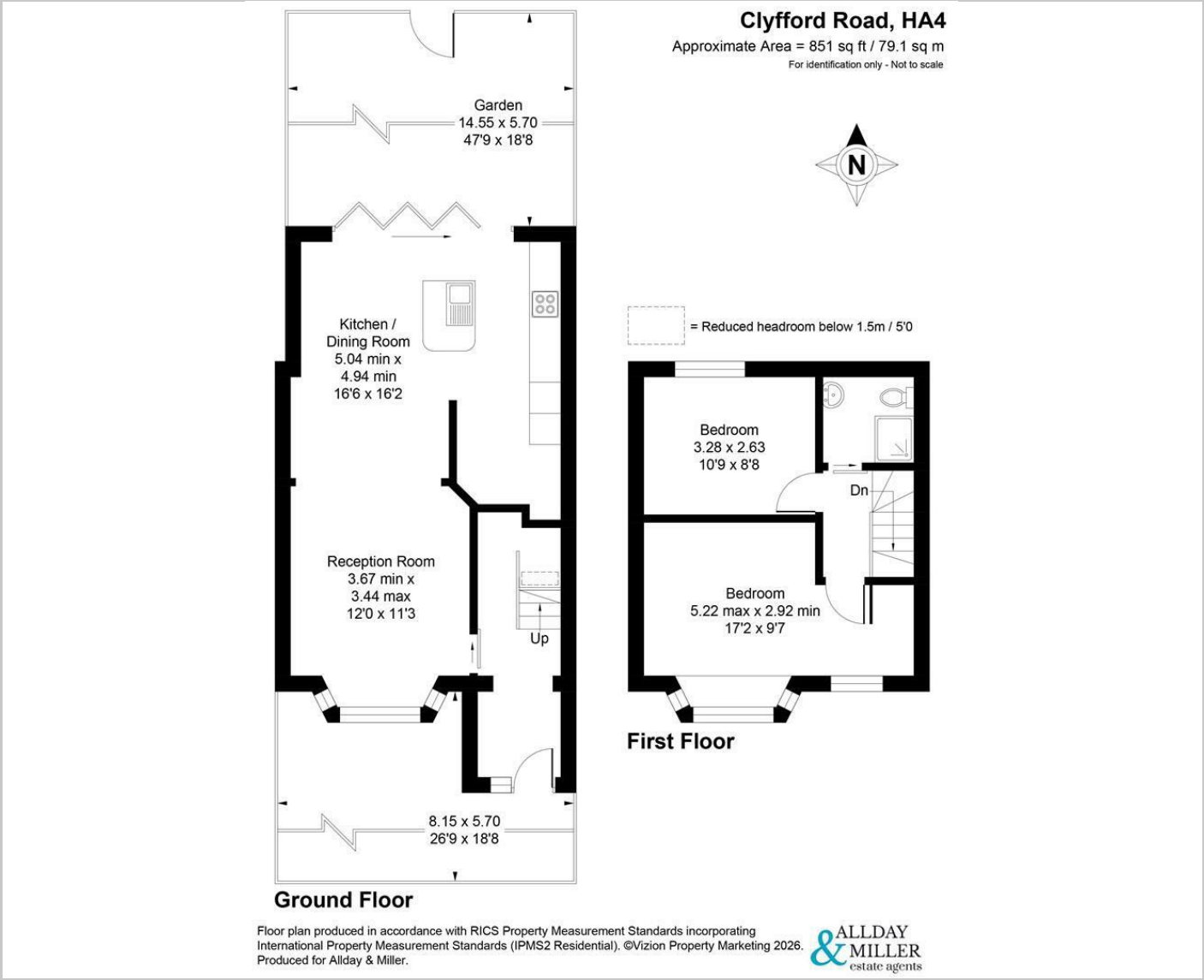

Area Map

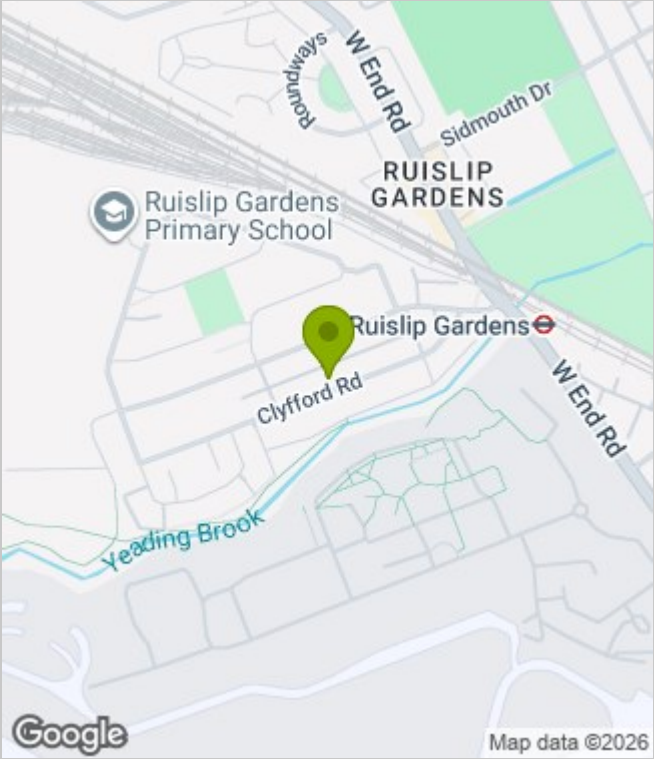

Energy Performance Graph

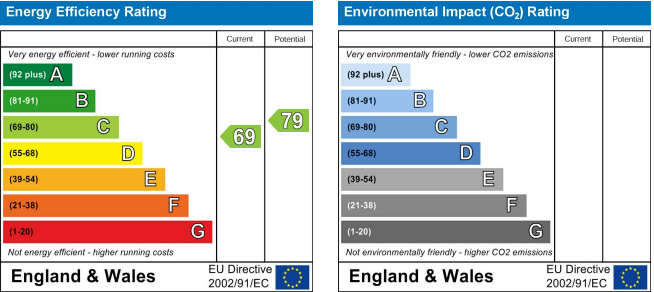

These particulars, whilst believed to be accurate are set out as a general outline only for guidance and do not constitute any part of an offer or contract. Intending purchasers should not rely on them as statements of representation of fact, but must satisfy themselves by inspection or otherwise as to their accuracy. No person in this firms employment has the authority to make or give any representation or warranty in respect of the property.