

ALLDAY
& MILLER



Elliott Avenue, Ruislip, HA4 9UA
£310,000





Elliott Avenue, Ruislip, HA4 9UA

£310,000

- One Bedroom
- Modern Bathroom
- Stunning Condition Throughout
- Modern Fitted Kitchen
- Walking Distance to Ruislip Manor & Eastcote High Streets & Stations
- Ground Floor Apartment
- Allocated Parking
- Quiet Location
- Luxury Apartment
- 573 sq ft

Description

Entering to Elliot Court is via a video entry phone system leading to the communal hallway. The well presented property brought to the market with modern interiors throughout comprises of an inviting entrance and storage cupboard, double bedroom with fitted wardrobes, bathroom suite and a sleek fitted kitchen/ reception room.

With the added advantage of private seating areas for residents within the communal gardens, lift within the development and allocated parking together with visitors parking in the gated car park.

Situation

Elliot Court situated on Elliot Avenue in the heart of Ruislip. Ruislip Manor and Eastcote high street being just a short distance away with its variety of local shops, cafes, coffee shops and restaurants. Both high streets are on the Metropolitan and Piccadilly line making the journey into central London a breeze. For the motorist A40 leading to London and the Home Counties is also close by. A number of highly regarded schools in the local area including Lady Bankes primary school and Ruislip high school.



Floor Plans

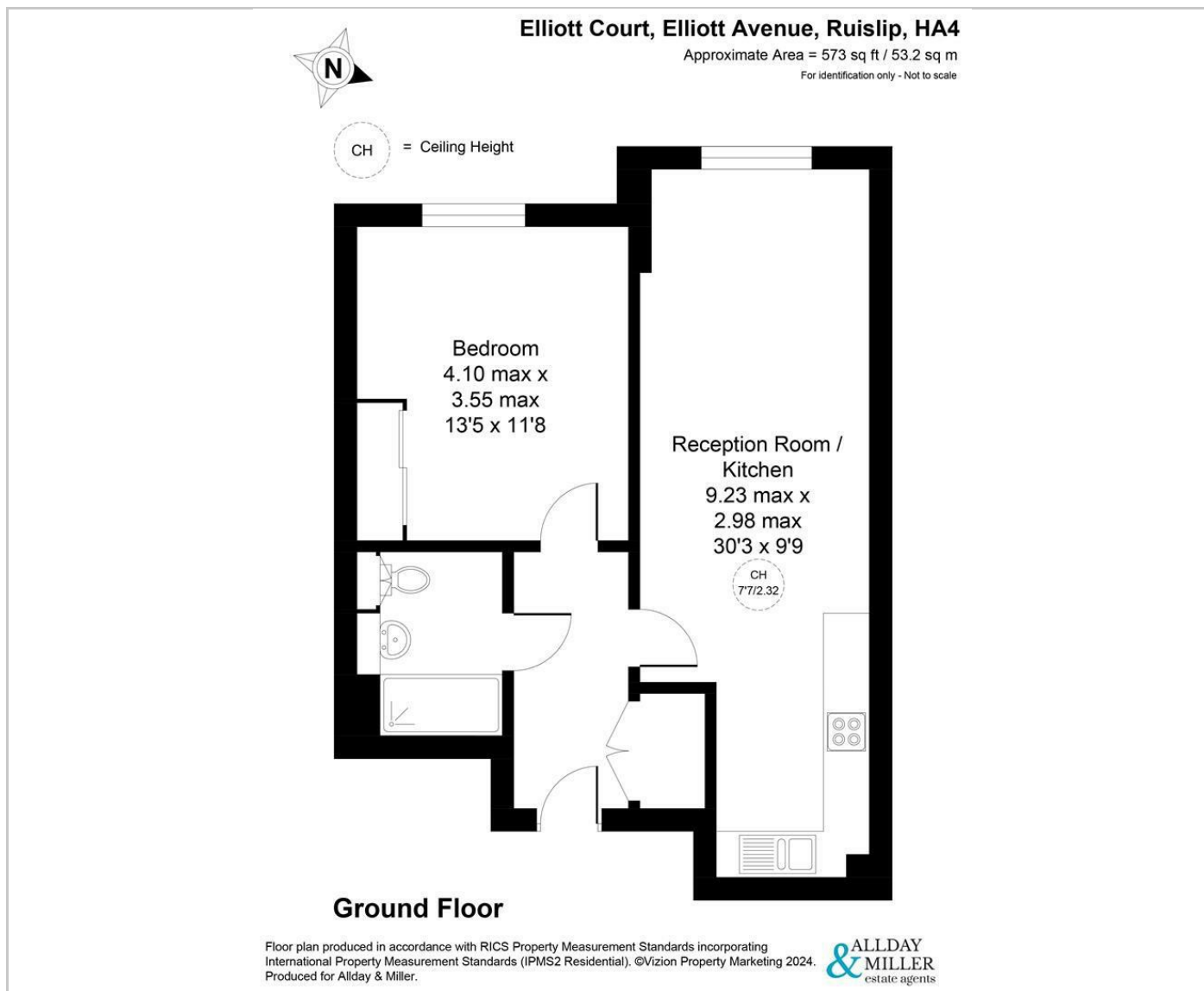

Area Map

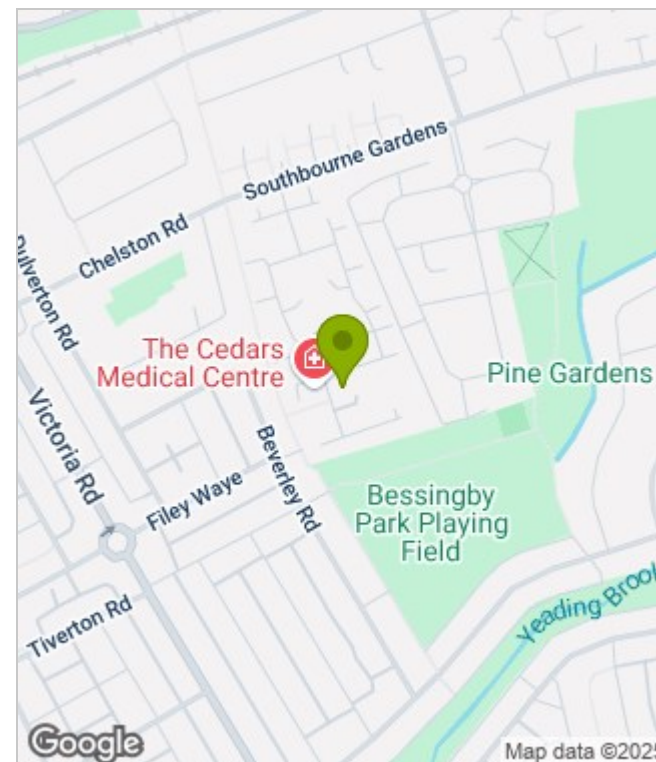

Energy Performance Graph

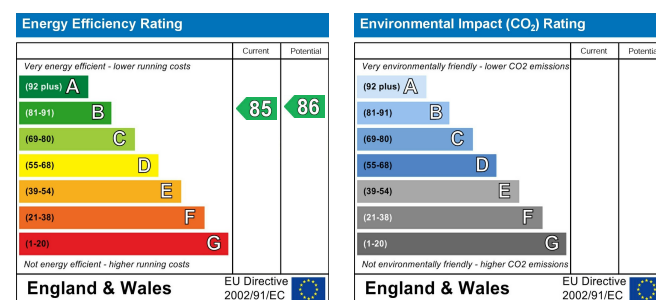

These particulars, whilst believed to be accurate are set out as a general outline only for guidance and do not constitute any part of an offer or contract. Intending purchasers should not rely on them as statements of representation of fact, but must satisfy themselves by inspection or otherwise as to their accuracy. No person in this firm's employment has the authority to make or give any representation or warranty in respect of the property.