

ALLDAY
& MILLER



Windmill Hill, Ruislip, HA4 8PY
£1,200,000

4 3 3 C



Windmill Hill, Ruislip, HA4 8PY

£1,200,000

- Stunning Family Home In The Heart of Ruislip
- Breath-taking Kitchen Extension
- 2206 Sq Ft/ 204 Sq M
- Out Building/ Summer House
- Three Reception Rooms + Utility Room
- Generous Plot With Heated Outdoor Pool
- 0.1 Miles To The High Street & Train Station
- The Ideal Garden For Entertaining And Family Enjoyment
- Three Bathrooms
- Bi Fold Doors Over Looking Garden

Description

This stunning property brought to the market in great condition throughout measuring 2206 Sq Ft comprises of an inviting entrance hall with storage cupboards, two reception rooms, a utility room, downstairs WC, modern fitted kitchen and dining room with bifold doors overlooking and providing access to the garden.

Rising to the first floor enjoys four double bedrooms and three bathrooms.

A large front driveway creating space for off street parking for multiple vehicles, also access to the garage. To the rear boasts a beautiful garden with a swimming pool and an outbuilding.

Situation

Windmill Hill is perfectly positioned in Ruislip Manor just moments from the High Street and its multitude of shops, restaurants, bus links and Metropolitan/Piccadilly line train station. There are a number of popular local schools within close proximity including Warreneder primary school and Bishop Ramsey senior school. The A40/M40 and M4 are a short drive away offering access to London, Heathrow and the Home Counties.



Floor Plans

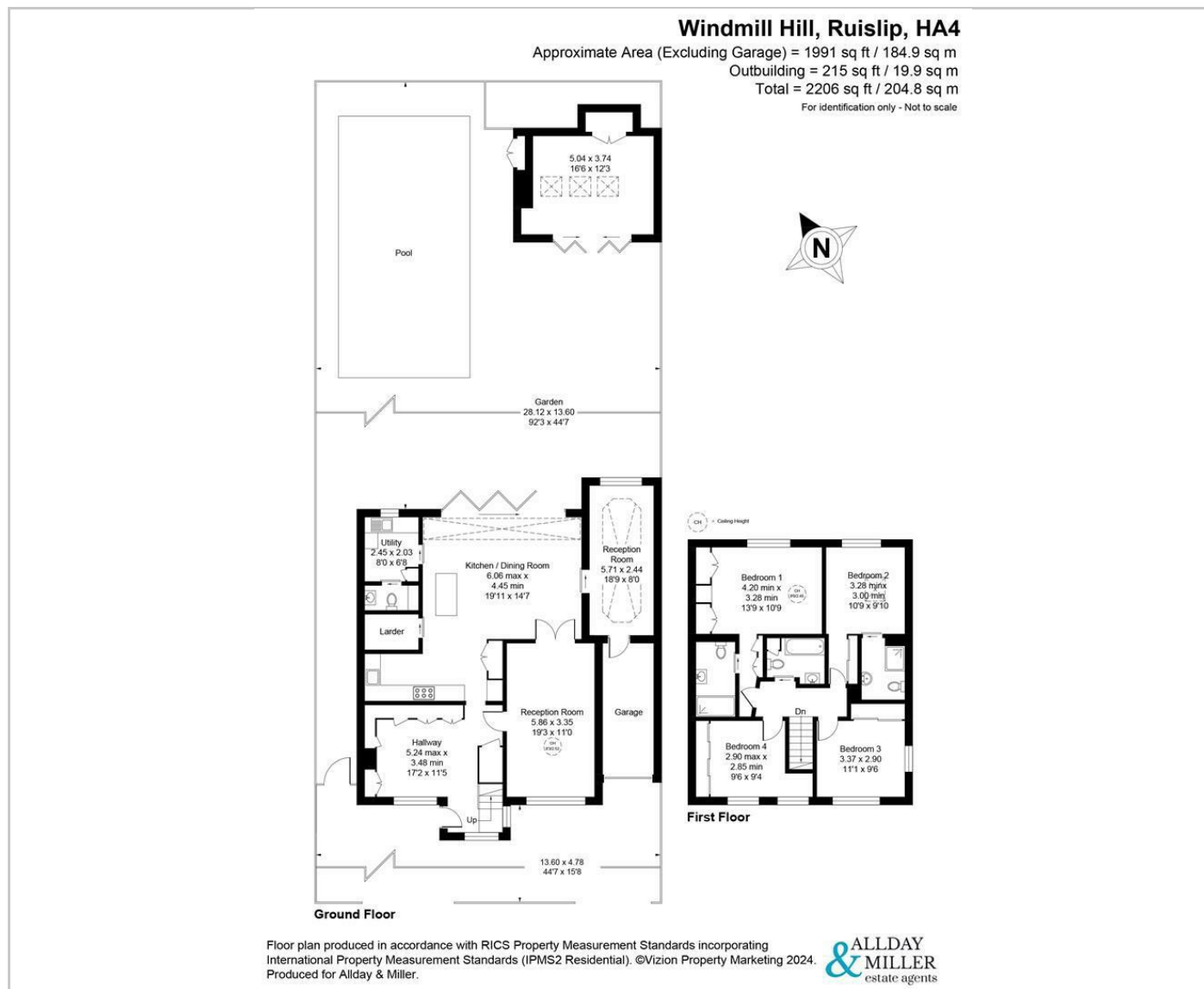

Area Map

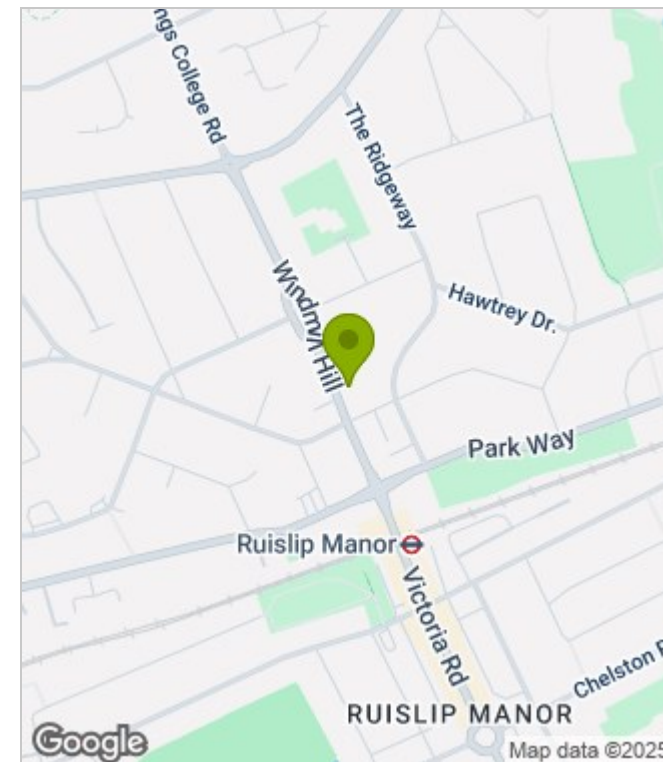

Energy Performance Graph

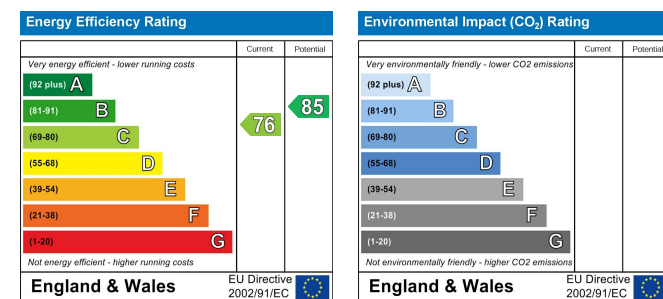

These particulars, whilst believed to be accurate are set out as a general outline only for guidance and do not constitute any part of an offer or contract. Intending purchasers should not rely on them as statements of representation of fact, but must satisfy themselves by inspection or otherwise as to their accuracy. No person in this firm's employment has the authority to make or give any representation or warranty in respect of the property.