



5 Westbourne Avenue Gloucester Street, Hull
Hull

Guide Price £60,000

WIGWAM

5 Westbourne Avenue Gloucester Street

Hull, Hull

Guide price - £60,000 - £65,000.

This mid-terraced property is available with no onward chain. The ground floor briefly comprises a lounge, dining area, kitchen, and bathroom. To the first floor, there are two double bedrooms. Externally, the property benefits from a low-maintenance rear yard.

This property is situated off Hessle Road, close to local shops, amenities and well-regarded schools such as Sirius West Academy and Christopher Pickering Primary School. There are excellent bus routes to and from the Hull City Centre and surrounding areas such as Hessle and Anlaby.

Council Tax band: A

Tenure: Freehold

EPC Energy Efficiency Rating: D

EPC Environmental Impact Rating:

- MID-TERRACED
- 2 BEDROOMS
- NO CHAIN
- 2 RECEPTION ROOMS
- FREEHOLD
- CLOSE TO AMENITIES





Lounge

With carpet flooring, double glazed window, radiator and doors leading to the dining area.

Dining Area

With carpet flooring, radiator, stairs leading to the first floor and open arch leading to the kitchen.

Kitchen

With vinyl flooring, laminate work surfaces, space for appliances, double glazed window, sink/drain, doors leading to the rear yard and downstairs bathroom.

Bedroom 1

With carpet flooring, radiator and double glazed window.

Bedroom 2

With carpet flooring, radiator and double glazed window.

Outside

With a low maintenance rear yard.





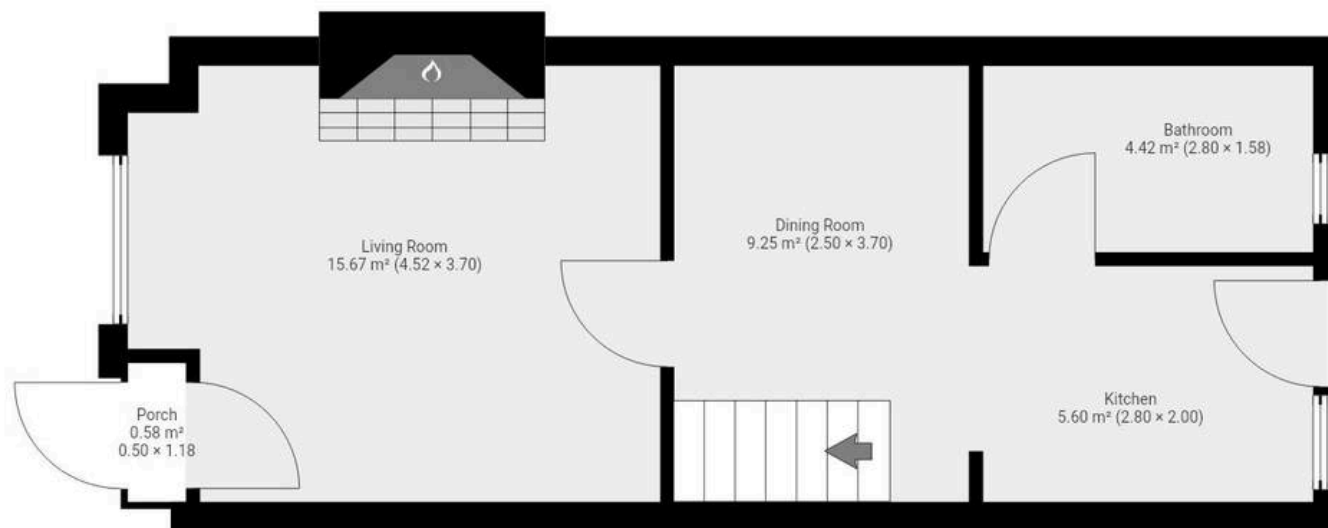



Wigwam

Block A, Unit 7B, Flemingate, Beverley - HU17 0NQ

01482505152 • hello@wigwamhomes.co.uk • www.wigwamhomes.co.uk