



Westbourne Avenue , Hull, HU4

Asking Price £68,000











Westbourne Avenue, Hull, HU4

This mid-terraced property is available with no onward chain. The ground floor briefly comprises a lounge, dining area, kitchen, and bathroom. To the first floor, there are two double bedrooms. Externally, the property benefits from a low-maintenance rear yard.

This property is situated off Hessle Road close to local shops, amenities and well-regarded schools such as Sirius West Academy and Christopher Pickering Primary School. There are excellent bus routes to and from the Hull City Centre and surrounding areas such as Hessle and Anlaby.

Score	Energy rating	Current	Potential
92+	A		
81-91	B		81 B
69-80	C		
55-68	D		
39-54	E	54 E	
21-38	F		
1-20	G		

KEY FEATURES

- MID-TERRACED
- 2 BEDROOMS
- NO CHAIN
- 2 RECEPTION ROOMS
- FREEHOLD
- CLOSE TO AMENITIES

DETAILS

Lounge

With carpet flooring, double glazed window, radiator and doors leading to the dining area.

Dining Area

With carpet flooring, radiator, stairs leading to the first floor and open arch leading to the kitchen.

Kitchen

With vinyl flooring, laminate work surfaces, space for appliances, double glazed window, sink/drainage, doors leading to the rear yard and downstairs bathroom.

Bedroom 1

With carpet flooring, radiator and double glazed window.

Bedroom 2

With carpet flooring, radiator and double glazed window.

Outside

With a low maintenance rear yard.

Viewings

Strictly by appointment with selling agents. Please contact Wigwam Homes today to book your viewing.

Fixtures & Fittings

Various fixtures and fittings may be available by separate negotiation and need to be confirmed prior to processing a formal offer.

Free Market Appraisals / Property Valuations

We at Wigwam Homes are delighted to offer any homeowner a FREE no obligation valuation on your property. Call today to book! Interested in selling? We offer zero tie-in periods and no-sale NO-fee!

Call us now on 01482 50 51 52 to book a valuation.

Free Mortgage Consultations

At Wigwam Homes we have our own independent mortgage advisors with access to over 90 lenders. With so many mortgage products on the market, an independent advisor can show you all the various options and help you discover which one is right for you. We can also help with any property, income and personal insurances which you may need to complete your mortgage application.

About Us

At Wigwam Homes we take pride in the success we achieve for our clients. Whether it is selling your properties, finding your forever home, searching for a long-term rental investment or looking to profit from onward selling, the Wigwam team is here to guide you through the housing market.

Disclaimer

Here at Wigwam Homes we try to ensure that all information in the advertisements are correct. However, we do advise any potential buyers to conduct their own viewing. The Agent has not checked the legal documentation to verify legal status of the property or the validity of any guarantee. A buyer must assume the information is incorrect, until it has been verified by their own solicitors. The measurements supplied are for general guidance, and as such must be considered as incorrect. A buyer is advised to re-check the measurements themselves before committing. Nothing concerning the type of construction or the condition of the structure is to be implied from the photograph of the property. These details are prepared as a general guide only, and should not be relied upon as a basis to enter into a legal contract, or to commit expenditure. An interested party should consult their own surveyor, solicitor or other professionals before committing themselves to any expenditure.

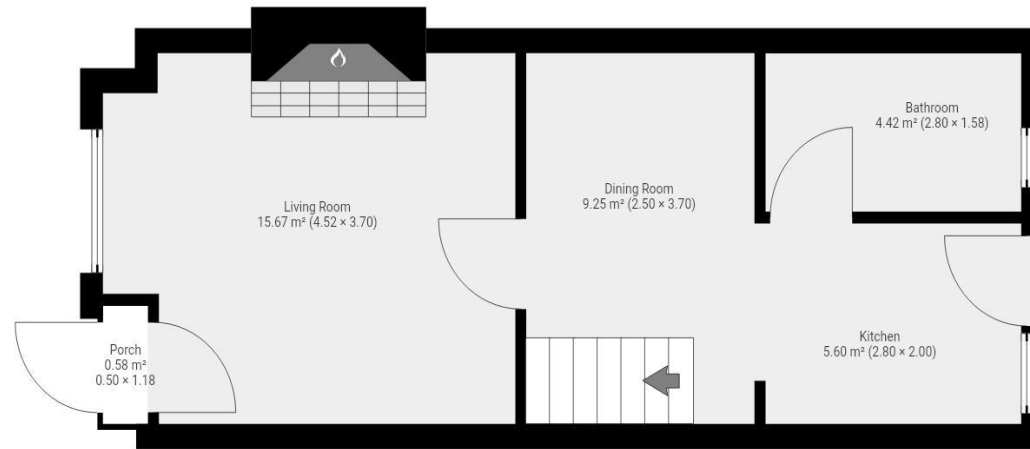

This floor plan is provided without warranty of any kind. All measures have been taken to ensure quality and accuracy, however we disclaim any warranty including, without limitation, satisfactory quality or accuracy of dimensions.