

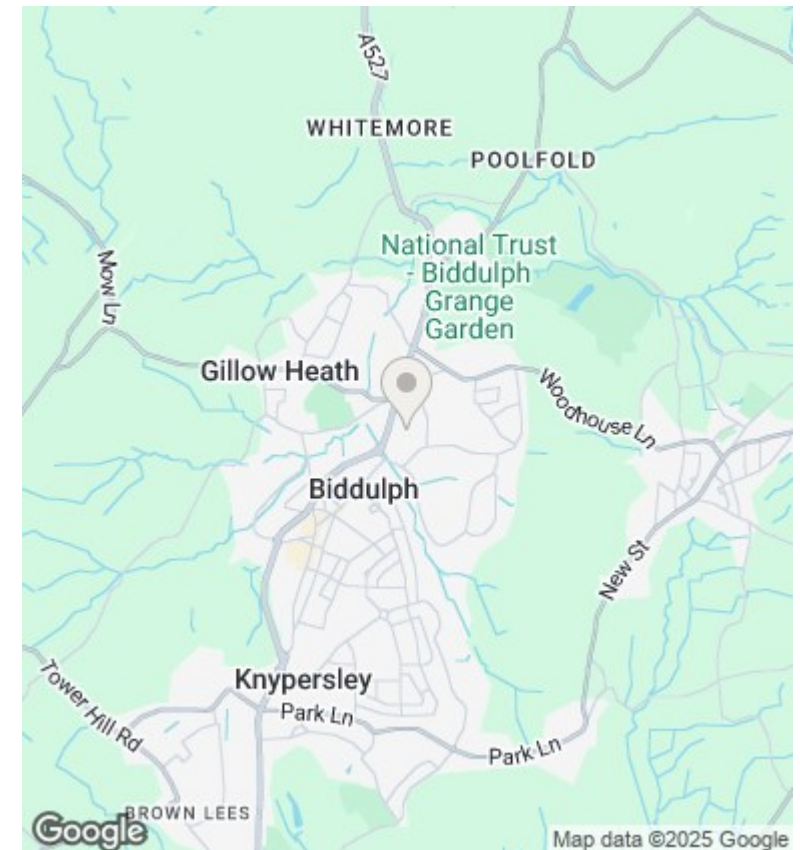

27 Fountain Court, Biddulph, ST8 6UP

Asking Price £425,000

- Corner Plot Position
- Extensive Lounge/ Diner
- Utility Room And Ground Floor WC
- Sought After Residential Area
- Four Bedroom Detached Home
- Kitchen Having On-Trend Units And Central Island
- Four Good Sized Bedrooms Ideal For Families
- Double Driveway And Integral Garage Providing Ample Off-Road Parking
- Conservatory With Garden Views
- Family Bathroom With Separate Shower

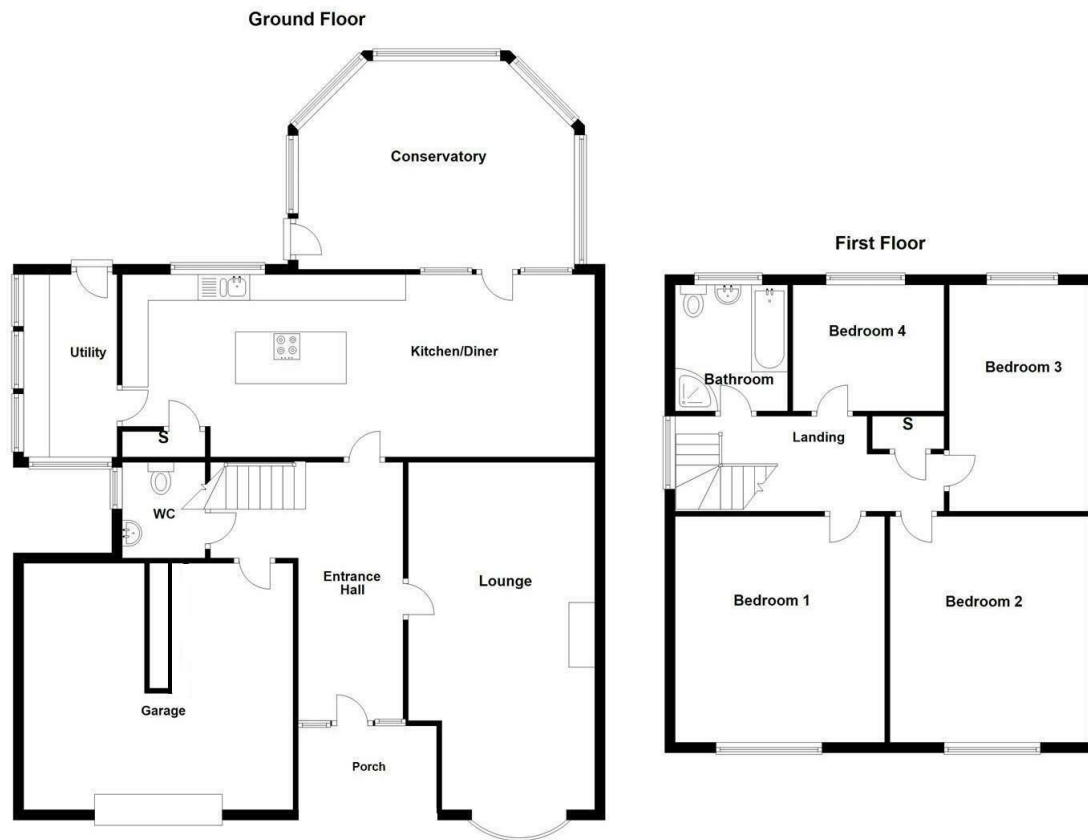

Directions

Viewings

Viewings by arrangement only. Call 01782 522117 to make an appointment.

Council Tax Band

E

EPC Rating:

D

Energy Efficiency Rating		
	Current	Potential
Very energy efficient - lower running costs		
(92 plus) A		
(81-91) B		77
(69-80) C		
(55-68) D	59	
(39-54) E		
(21-38) F		
(1-20) G		
Not energy efficient - higher running costs		
England & Wales	EU Directive 2002/91/EC	