

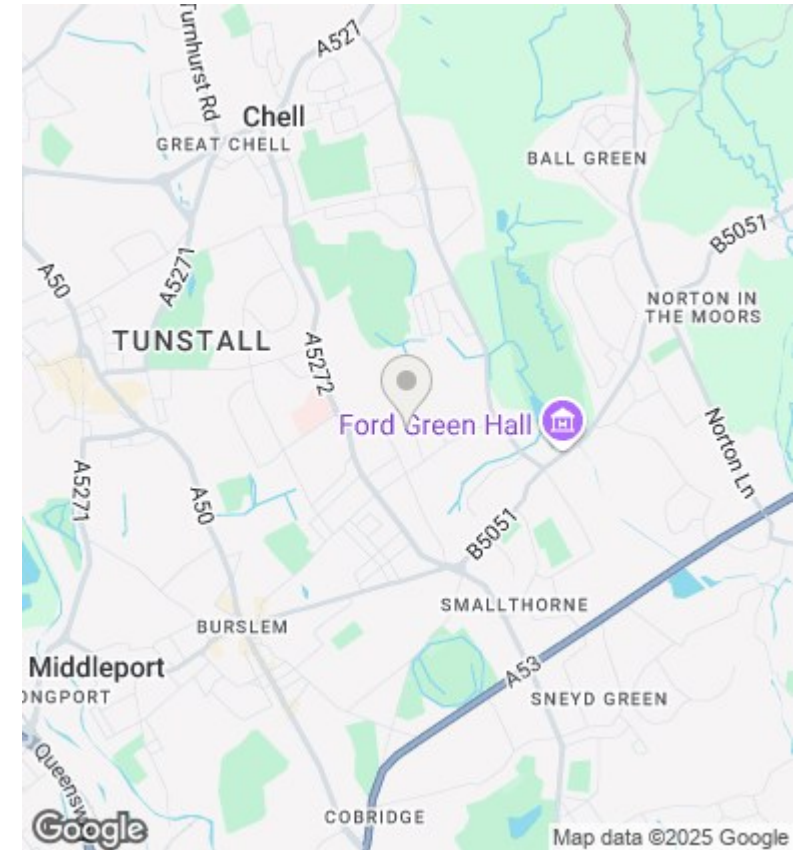

|., 3 Bream Way, Stoke-On-Trent, Staffordshire, ST6 7PW

Asking Price £250,000

- Stunning Extended Detached Family Home
- Spacious Lounge With Feature Fireplace
- Stunning & Spacious Extended Dining Kitchen With Modern Units, Integrated Appliances & Patio Doors
- Separate Utility Room, Access To Integral Garage & Ground Floor Cloakroom
- Three Bedrooms With Fitted Wardrobes & Spacious Family Bathroom
- Pattern Imprinted Drive Providing Off Road Parking & Access To Garage
- Well Maintained Low Maintenance Rear Garden
- Viewing Essential

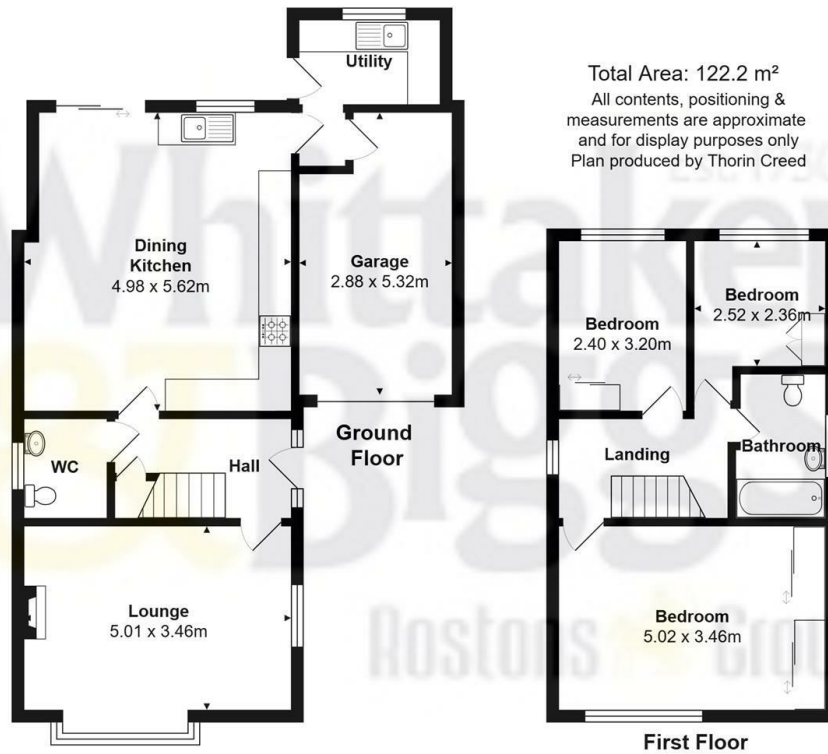

Directions

Viewings

Viewings by arrangement only. Call 01782 522117 to make an appointment.

Council Tax Band

C

EPC Rating:

Energy Efficiency Rating		
	Current	Potential
Very energy efficient - lower running costs		
(92 plus) A		
(81-91) B		
(69-80) C		
(55-68) D		
(39-54) E		
(21-38) F		
(1-20) G		
Not energy efficient - higher running costs		
England & Wales	EU Directive 2002/91/EC	