

117 John Street, Biddulph, Staffordshire, ST8 6HP

Asking Price £175,000

- Characterful Semi-Detached Home
- Spacious Kitchen With Walk-In Pantry
- Timber Summerhouse To The Head Of The Garden
- Three Bedrooms Plus Dressing Room
- Two Reception Rooms With Feature Fireplaces
- Located Close To Biddulph's Amenities
- Entrance Hall With Minton Tiled Floor
- French Doors Leading Onto The Garden
- Suitable For A Variety Of Purchaser's

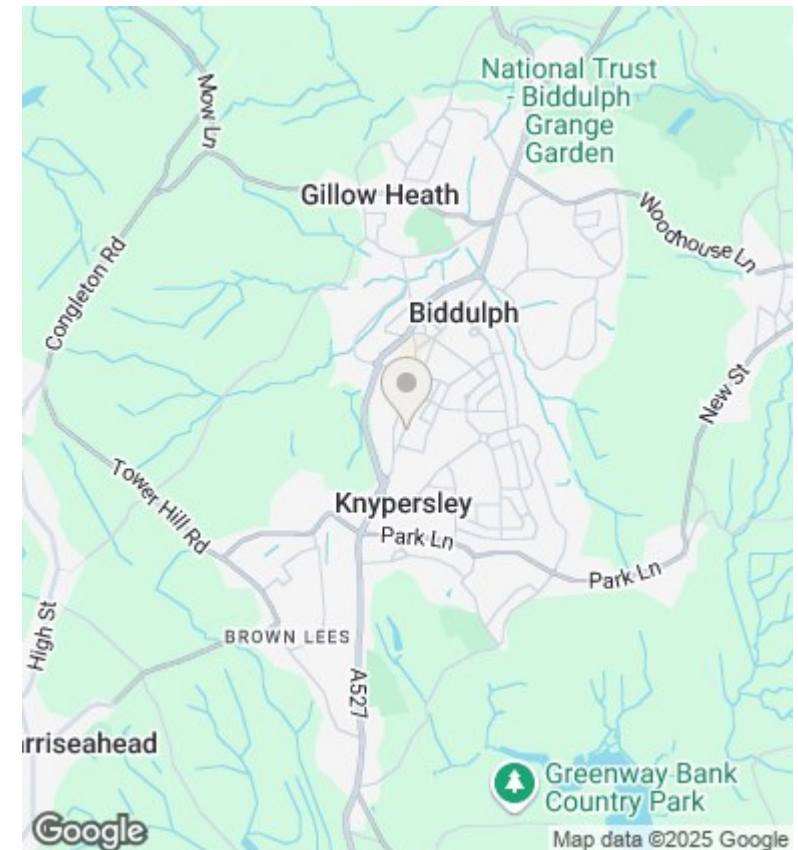
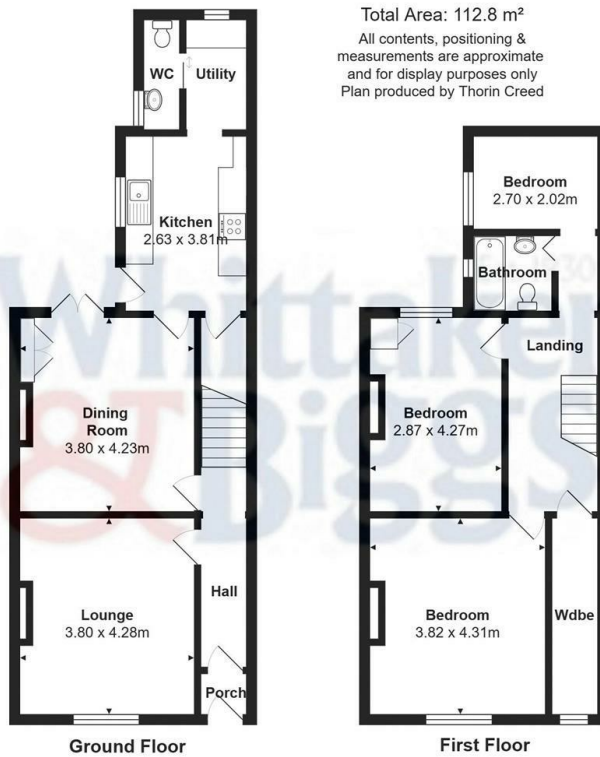

Directions

Viewings

Viewings by arrangement only. Call 01782 522117 to make an appointment.

Council Tax Band

B

EPC Rating:

| Energy Efficiency Rating | | |
|---|-------------------------|-----------|
| | Current | Potential |
| Very energy efficient - lower running costs | | |
| (92 plus) A | | |
| (81-91) B | | |
| (69-80) C | | |
| (55-68) D | | |
| (39-54) E | | |
| (21-38) F | | |
| (1-20) G | | |
| Not energy efficient - higher running costs | | |
| England & Wales | EU Directive 2002/91/EC | |