



## 9 Northfield Drive, Biddulph, Staffordshire, ST8 7DU

Asking Price £245,000

- Traditional Detached Bungalow With Accommodation Over Two Floors
- Two Ground Floor Bedroom & First Floor Bedroom & Bathroom
- Extended Having A sizable Utility Room & Modern Shower Room
- Spacious Lounge & Breakfast Kitchen
- Attractive Front & Rear Gardens
- Drive, & Garage
- No Upward Chain



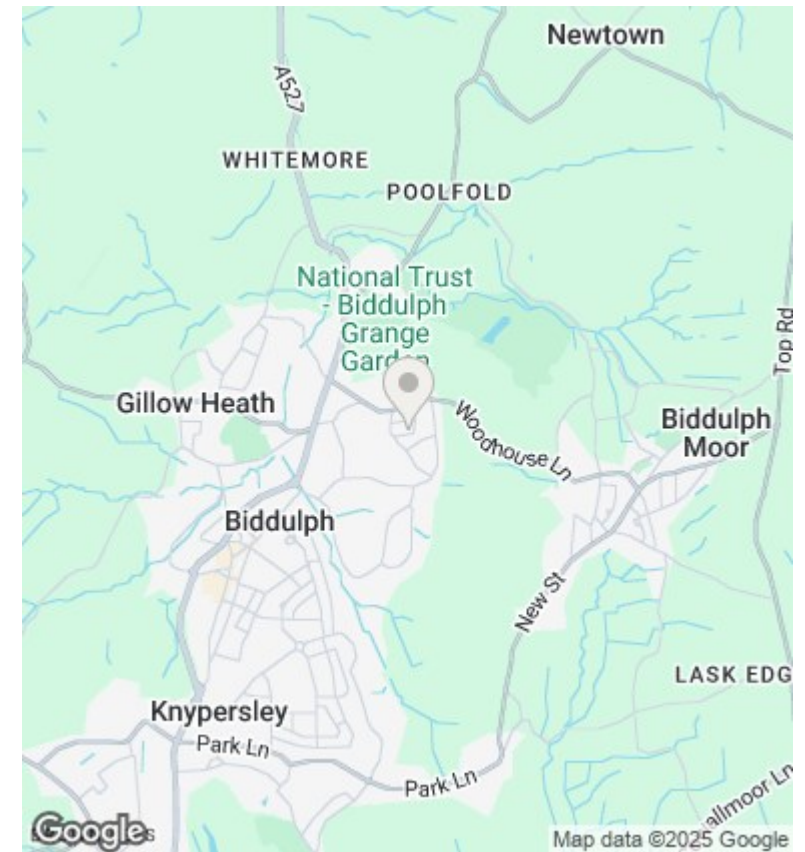
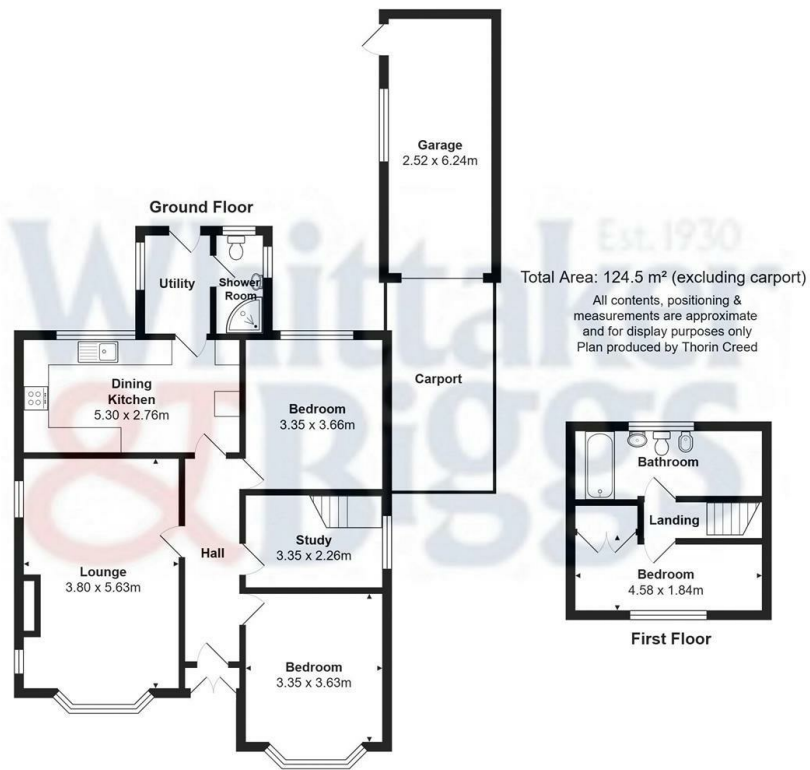

## Directions

## Viewings

Viewings by arrangement only. Call 01782 522117 to make an appointment.

## Council Tax Band

C

## EPC Rating:

D

Energy Efficiency Rating		
	Current	Potential
Very energy efficient - lower running costs		
(92 plus) <b>A</b>		
(81-91) <b>B</b>		78
(69-80) <b>C</b>		
(55-68) <b>D</b>	56	
(39-54) <b>E</b>		
(21-38) <b>F</b>		
(1-20) <b>G</b>		
Not energy efficient - higher running costs		
England & Wales		EU Directive 2002/91/EC