

## Astley Close, WA4 6RB

£275,000

🛏 2 🚿 1 🚗 3



A spacious semi-detached bungalow occupying a favourable position in the popular location of Astley Close.

This charming family home has been well maintained. To the ground floor, features include; entrance hall, lounge, dining room, kitchen, bathroom, conservatory and a further sitting room which can be re-configured to create a third bedroom. To the first floor there are two good sized bedrooms. Outside there is a low maintenance, private rear garden, a substantial sized garage and driveway parking.

Early Viewing Essential. No Chain Delay With This Sale.

## Key Features

- Semi-Detached Bungalow
- Popular Location
- Spacious Accomodation
- Rear Garden
- Driveway Parking
- Garage
- Well Maintained Throughout
- No Chain Delay
- 
- 

Approx Gross Internal Area  
112 sq m / 1211 sq ft

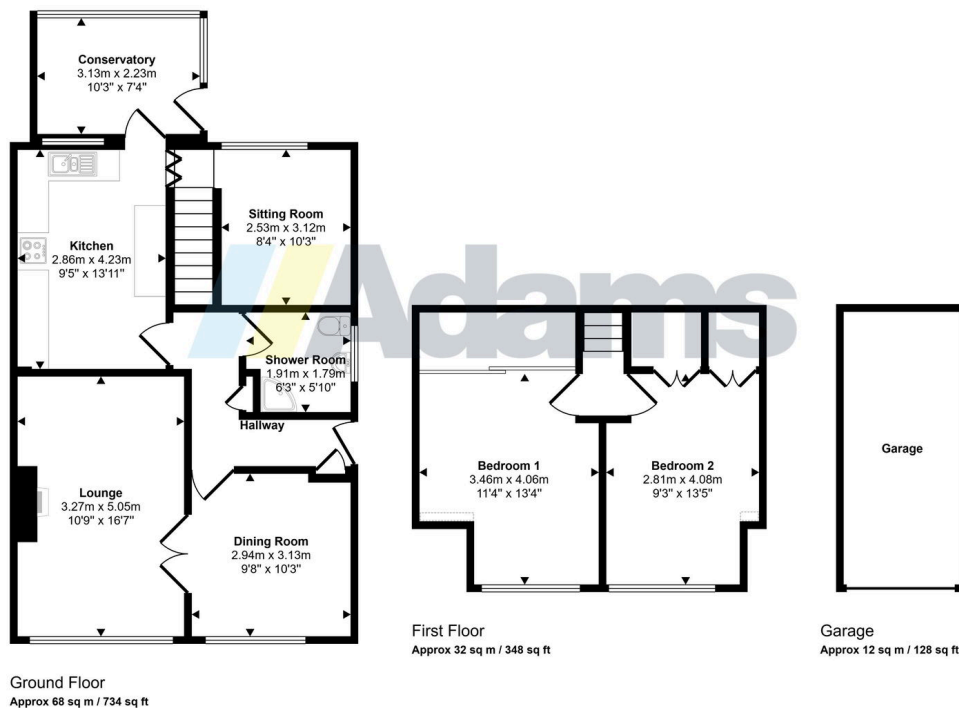

Denotes head height below 1.5m

This floorplan is only for illustrative purposes and is not to scale. Measurements of rooms, doors, windows, and any items are approximate and no responsibility is taken for any error, omission or mis-statement. Icons of items such as bathroom suites are representations only and may not look like the real items. Made with Made Snappy 360.