



Oulton Court, Grappenhall, Warrington

£80,000

1 1 1



****GROUND FLOOR RETIREMENT APARTMENT****

A ground floor retirement apartment forming part of the popular Oulton Court development in Grappenhall.

Features briefly include; entrance hall, lounge / dining room with direct access to the communal gardens, kitchen, bedroom with fitted wardrobes and shower room.

Residents within the Oulton Court development benefit from a dedicated house manager, communal lounges, a shared community kitchen and laundry facilities.

Externally there are lovely communal gardens and a residents parking area with barrier controlled access.

Viewing Advised. No Chain Delay With This Sale.

Viewing

By prior appointment through our Stockton Heath office on 01925-398343.

Note

All measurements are approximate. No appliances or central heating systems referred to within these particulars have been tested and therefore their working order cannot be verified. Floor plans are for guide purposes only and all dimensions are approximate and are not to be used for room and furniture planning.

Agents Notes

PLEASE NOTE: PETS ARE NOT PERMITTED AT THIS DEVELOPMENT

AGE RESTRICTION: OVER 55's ONLY



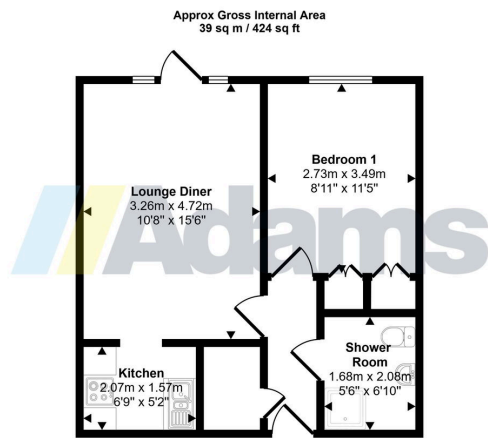

Floorplan

This floorplan is only for illustrative purposes and is not to scale. Measurements of rooms, doors, windows, and any items are approximate and no responsibility is taken for any error, omission or mis-statement. Icons of items such as bathroom suites are representations only and may not look like the real items. Made with Made Snappy 360.

- Ground Floor Apartment
- Popular Retirement Development
- Lounge With Direct Garden Access
- One Bedroom With Fitted Wardrobes
- Refitted Shower Room
- On Site House Manager
- Residents Lounge, Laundry & Kitchen
- Communal Parking & Gardens
- Viewing Advised
- No Chain Delay

