

£950 Per Month

Per Month

Runnacles Way, Felixstowe

Located in a popular and convenient part of Felixstowe, this modern 1-bedroom end-terrace property offers stylish, low-maintenance living.

Beautifully presented throughout, the home boasts a spacious lounge filled with natural light, a contemporary fitted kitchen, and a generously sized double bedroom. The modern bathroom is sleek and

well-finished, complementing the overall standard of the property.

Situated close to local amenities, transport links, and Felixstowe's vibrant seafront, this is a fantastic opportunity to own a turn-key property in a desirable coastal location. Parking for one vehicle.

Call the Oakheart Lettings Team today to book a viewing!







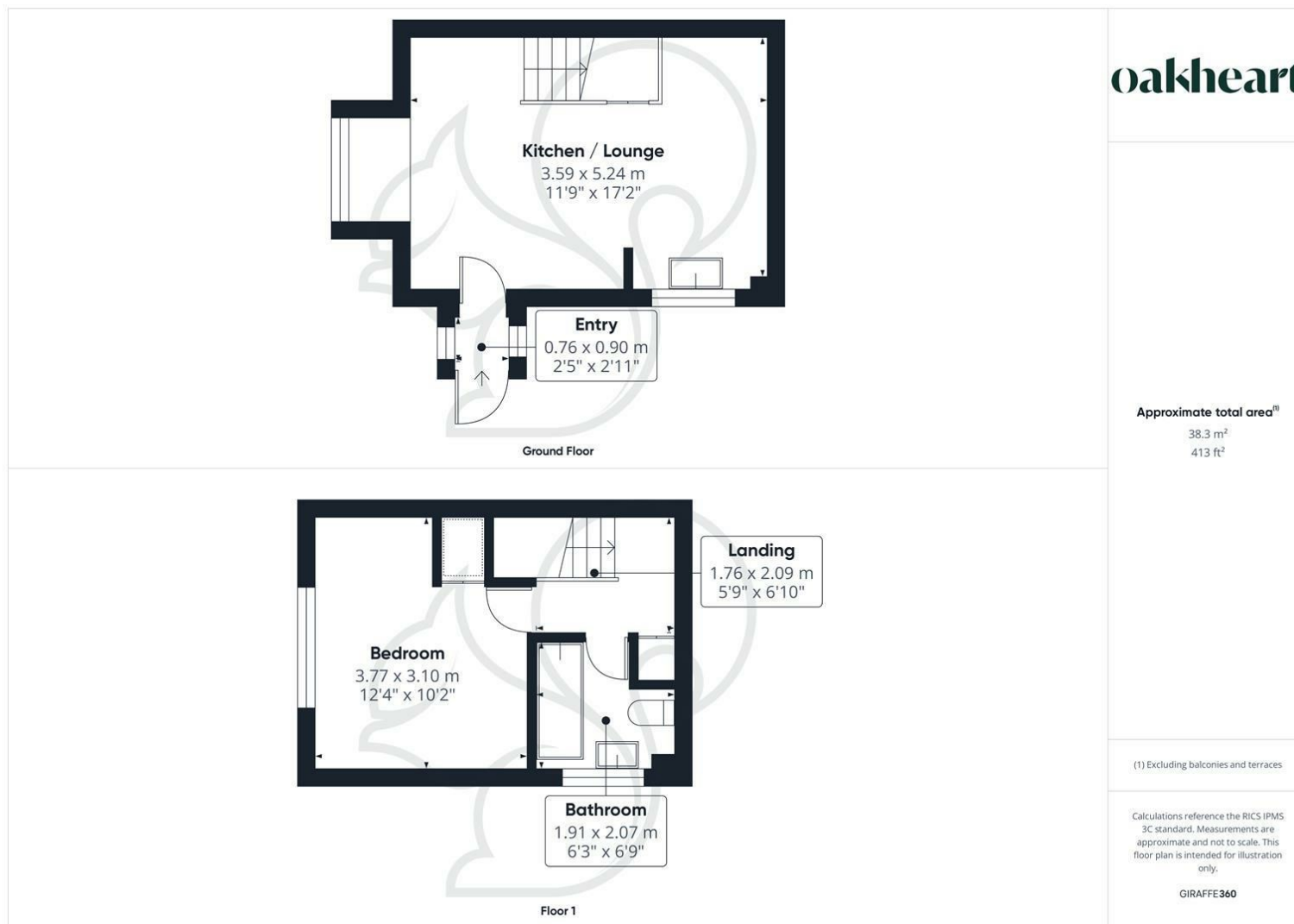

oakheart

Date Available:

1st July 2025

Local Authority:

East Suffolk

Council Tax Band:

A

Energy Efficiency Rating

	Current	Potential
Very energy efficient - lower running costs		
(92 plus) A		
(81-91) B		
(69-80) C		
(55-68) D	53	59
(39-54) E		
(21-38) F		
(1-20) G		
Not energy efficient - higher running costs		
England & Wales	EU Directive 2002/91/EC	

Agents Note: Whilst every care has been taken to prepare these particulars, they are for guidance purposes only. All measurements are approximate and are for general guidance purposes only and whilst every care has been taken to ensure their accuracy, they should not be relied upon.

Oakheart Lettings T/A Thompsons Estate Agents

01473 251907

suffolklettings@oakheart.co.uk

12 Upper Brook Street, Ipswich, Suffolk, IP4 1EF

Thompsons
ESTB 1933

oakheart