

**£1,100 Per Month**

Per Month

Sassoon Crescent, Stowmarket



A modern and well presented two bedroom house which is located in a popular and vibrant development. Situated just a short distance to transport links, the town centre and an array of local shops and amenities.

The accommodation comprises an entrance hall with downstairs WC and storage, a good sized open plan

living room with a modern fitted kitchen featuring some appliances, two double bedrooms with the one featuring an ensuite shower room and a family sized bathroom with shower over the bath. Externally there is an enclosed rear garden and off street parking,













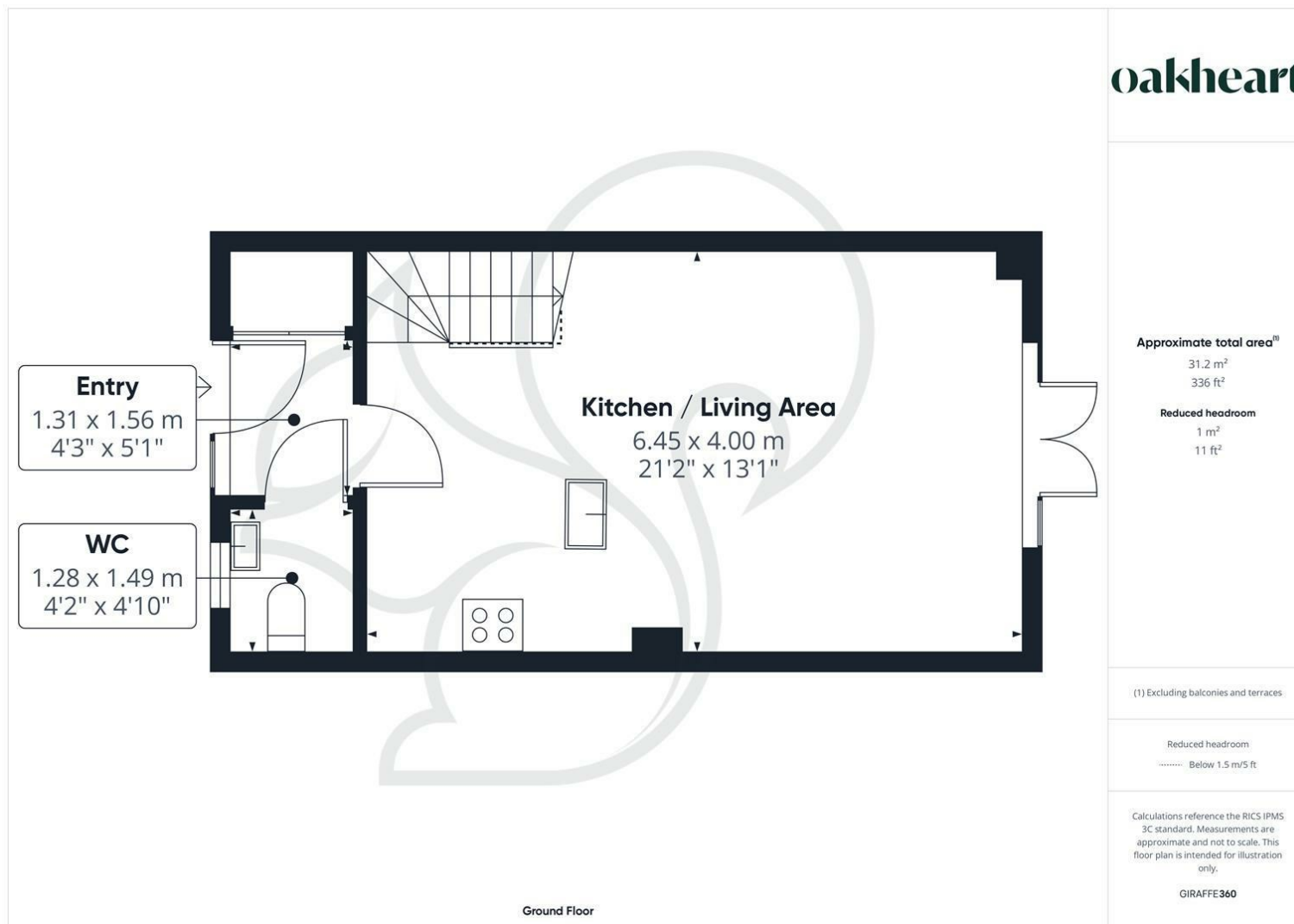

**Date Available:**  
3rd July 2025

**Local Authority:**

**Council Tax Band:**  
B

### Energy Efficiency Rating

	Current	Potential
Very energy efficient - lower running costs		
(92 plus) <b>A</b>		<b>96</b>
(81-91) <b>B</b>	<b>82</b>	
(69-80) <b>C</b>		
(55-68) <b>D</b>		
(39-54) <b>E</b>		
(21-38) <b>F</b>		
(1-20) <b>G</b>		
Not energy efficient - higher running costs		
<b>England &amp; Wales</b>	EU Directive 2002/91/EC	

Agents Note: Whilst every care has been taken to prepare these particulars, they are for guidance purposes only. All measurements are approximate and are for general guidance purposes only and whilst every care has been taken to ensure their accuracy, they should not be relied upon.

Oakheart Lettings - Suffolk  
01473 251907  
suffolklettings@oakheart.co.uk  
12 Upper Brook Street, Ipswich, Suffolk, IP4 1EF

*Thompsons*  
ESTD 1933

**oakheart**