



HILDEN
Management

Crabble Hill, Dover, CT17 0FA

Offers In Region Of £220,000

🛏️ 2 🍳 1 🛋️ 1

- Offered with no onward chain – move straight in!
- Two secure underground parking spaces
- Stunning open-plan kitchen/living space with integrated appliances & breakfast bar
- Excellent location close to amenities and transport links
- Two generously sized bedrooms on the upper floor
- Long Lease!
- Immaculate condition throughout.



Stylish Open-Plan Duplex – No Chain!

Set across two floors, this modern two-bedroom apartment combines space and style with impressive open-plan living. The sleek kitchen features integrated appliances and a striking breakfast bar, flowing into a bright reception area that's perfect for entertaining.

Upstairs offers two generous bedrooms and a luxury family bathroom, while a downstairs WC and two secure underground parking spaces add extra convenience.

Ready to move straight into – book your viewing today!





GROUND FLOOR

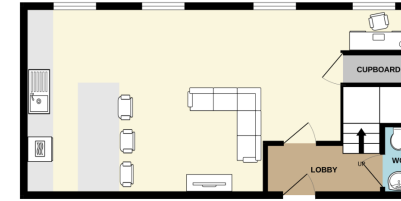

1ST FLOOR



Find an energy certificate (i)

English | [Cymraeg](#)

Energy performance certificate (EPC)

| | | | |
|--|---------------|--------------------|--------------------------|
| 28 Clock Tower Lofts The Park Hill CRABBLE HILL S20 0ES CT17 0FA | Energy rating | Valid until | 27 January 2031 |
| | C | Certificate number | 0106-1382-0330-1025-3993 |

Property type
Top-floor maisonette

Total floor area
86 square metres

Rules on letting this property

Properties can be let if they have an energy rating from A to E.
You can read [guidance for landlords on the regulations and exemptions](#) (<https://www.gov.uk/guidance/landlord-energy-efficiency-guidance>)

Energy rating and score

This property's energy rating is C. It has the potential to be C.

[See how to improve this property's energy efficiency.](#)

Hilden Management Limited
Ground Floor, 2 Jubilee Way Faversham, Kent, ME13 2GD
01795 581005
info@hilden.management

hilden.management

Registered Office Address: Dry Close, Newbery Lane, Misterton, Somerset, TA18 8NE.
Company Number: 15048475

