



6 Chesworth Gardens, Horsham, West Sussex RH13 5AR
£1,350 Per month

& LINES
James

6 Chesworth Gardens

*** FULLY BOOKED FOR VIEWINGS *** PHENOMENAL INTEREST MORE PROPERTIES URGENTLY REQUIRED. A most attractive two bedroom cottage style semi detached house situated in a quiet cul-de-sac close to the town centre.

A two bedroom cottage style house positioned close to both the town centre, mainline station and picturesque countryside. Good sized lounge, Fitted kitchen/Breakfast room, Two double bedrooms, Modern bathroom with shower, showing in front

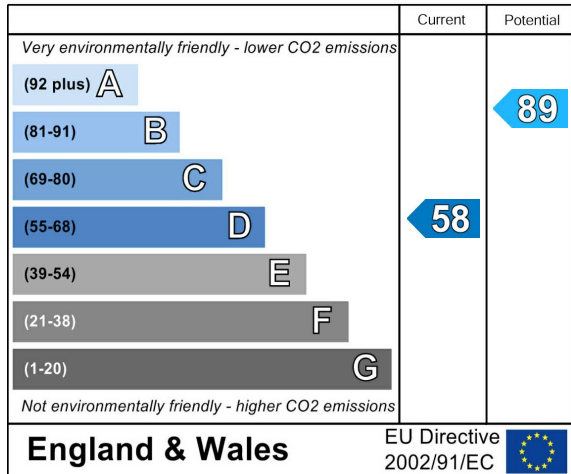
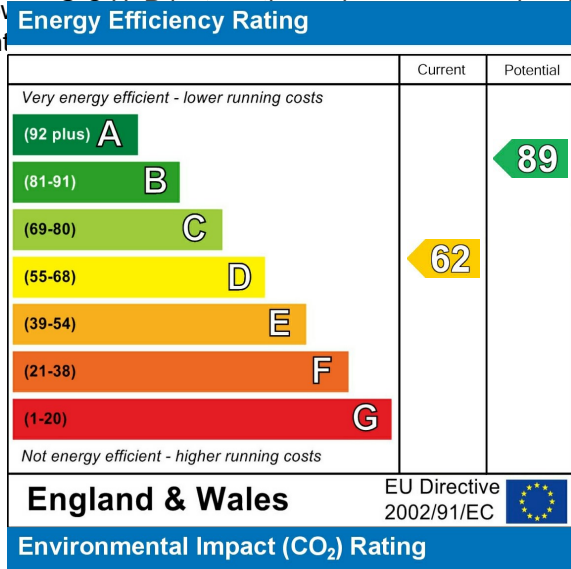

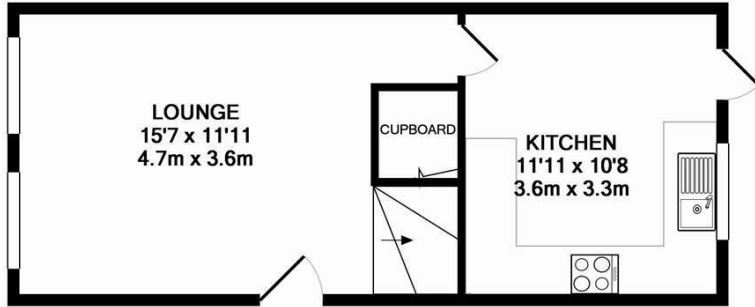

GROUND FLOOR
APPROX. FLOOR
AREA 345 SQ.FT.
(32.1 SQ.M.)

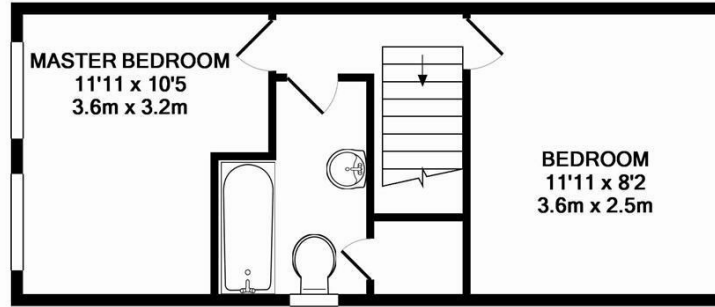

1ST FLOOR
APPROX. FLOOR
AREA 345 SQ.FT.
(32.1 SQ.M.)

TOTAL APPROX. FLOOR AREA 690 SQ.FT. (64.1 SQ.M.)

Whilst every attempt has been made to ensure the accuracy of the floor plan contained here, measurements of doors, windows, rooms and any other items are approximate and no responsibility is taken for any error, omission, or mis-statement. This plan is for illustrative purposes only and should be used as such by any prospective purchaser. The services, systems and appliances shown have not been tested and no guarantee as to their operability or efficiency can be given
Made with Metropix ©2013

