



**Chestnut Gardens, Horsham, RH12 2NG**  
**£1,300 Per month**



## 5 Chestnut Gardens

- GROUND FLOOR MAISONETTE
- TWO BEDROOMS
- WELL PRESENTED
- UNFURNISHED
- EPC RATING D
- COUNCIL TAX BAND C
- 12 MONTHS +
- DEPOSIT £1500.00
- AVAILABLE NOW

A two bedroom ground floor maisonette situated in quiet development in walking distance of the station and town centre.

A two bedroom maisonette which is presented in good order having undergone some refurbishments which include newly fitted kitchen, redecoration and new carpets to the lounge and bedrooms. Accommodation comprises: Entrance hall, fitted kitchen, lounge with large window and patio door to the communal garden, large double bedroom with built in wardrobe, further bedroom also with built in wardrobe, bathroom with separate W.C.

The property is double glazed throughout with electric heating.

The landlord has requested No pets or Children.



& LINES  
*James*



# GROUND FLOOR

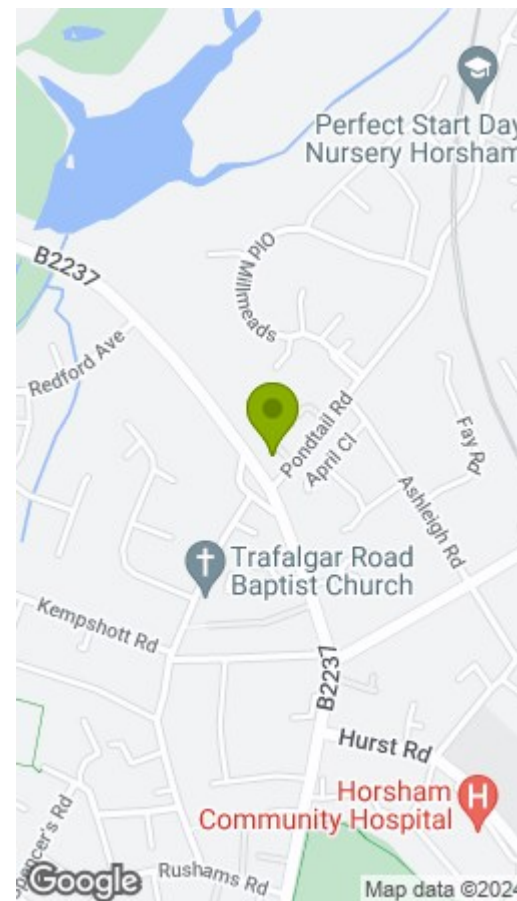
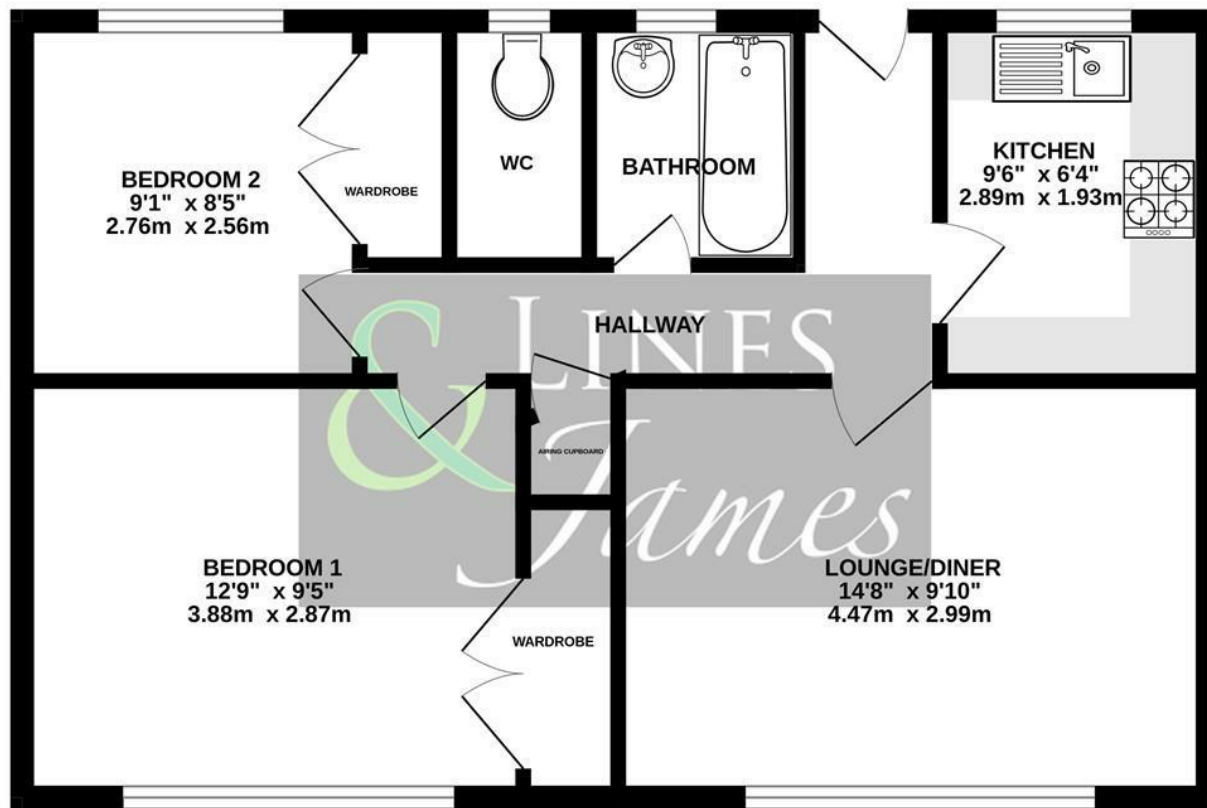

Energy Efficiency Rating		Environmental Impact (CO <sub>2</sub> ) Rating	
	Current	Potential	
Very energy efficient - lower running costs			Very environmentally friendly - lower CO <sub>2</sub> emissions
(92-100) <b>A</b>			(81-91) <b>B</b>
(81-91) <b>B</b>			(69-80) <b>C</b>
(69-80) <b>C</b>			(55-68) <b>D</b>
(55-68) <b>D</b>			(39-54) <b>E</b>
(39-54) <b>E</b>			(21-38) <b>F</b>
(21-38) <b>F</b>			(1-20) <b>G</b>
(1-20) <b>G</b>			Not environmentally friendly - higher CO <sub>2</sub> emissions
Not energy efficient - higher running costs			Not energy efficient - higher running costs
		65	70
<b>England &amp; Wales</b>	EU Directive 2002/91/EC		<b>England &amp; Wales</b> EU Directive 2002/91/EC

Measurements are approximate and not to scale. Bedroom measurements do not take into account the fitted wardrobes. This plan is for illustrative purposes only and should only be used as such by any prospective tenant. No responsibility is taken for any error, omission or mis-statement. Made with Metropix ©2024



24 Worthing Road, Horsham, West Sussex, RH12 1SL  
 Tel: 01403 210088  
 lettings@linesandjames.com  
 www.linesandjames.com

MANAGING PROPERTIES ...

*Finding Homes ...*

