



Arundel Close, Southwater, West Sussex RH13 9XD
£1,050 Per month

& LINES
James

Arundel Close, Southwater

A well presented one bedroom ground floor maisonette situated in the village of Southwater benefiting from its own private garden, garage and parking.

Lines and James are pleased to market this well presented one bedroom ground floor maisonette situated in the village of Southwater within walking distance of local amenities.

The accommodation comprises: Entrance hall with storage, double bedroom with fitted wardrobes, bathroom with shower over bath, modern fitted kitchen with appliances and living room with patio door to private rear garden which includes a shed with power.

Additional benefits include a garage and off road parking.

Sorry no pets



Energy Efficiency Rating		Current	Potential
<i>Very energy efficient - lower running costs</i>			
(92 plus) A			
(81-91) B			
(69-80) C			
(55-68) D		67	71
(39-54) E			
(21-38) F			
(1-20) G			
<i>Not energy efficient - higher running costs</i>			
England & Wales		EU Directive 2002/91/EC	

Environmental Impact (CO ₂) Rating		Current	Potential
<i>Very environmentally friendly - lower CO₂ emissions</i>			
(92 plus) A			
(81-91) B			
(69-80) C			
(55-68) D		58	61
(39-54) E			
(21-38) F			
(1-20) G			
<i>Not environmentally friendly - higher CO₂ emissions</i>			
England & Wales		EU Directive 2002/91/EC	





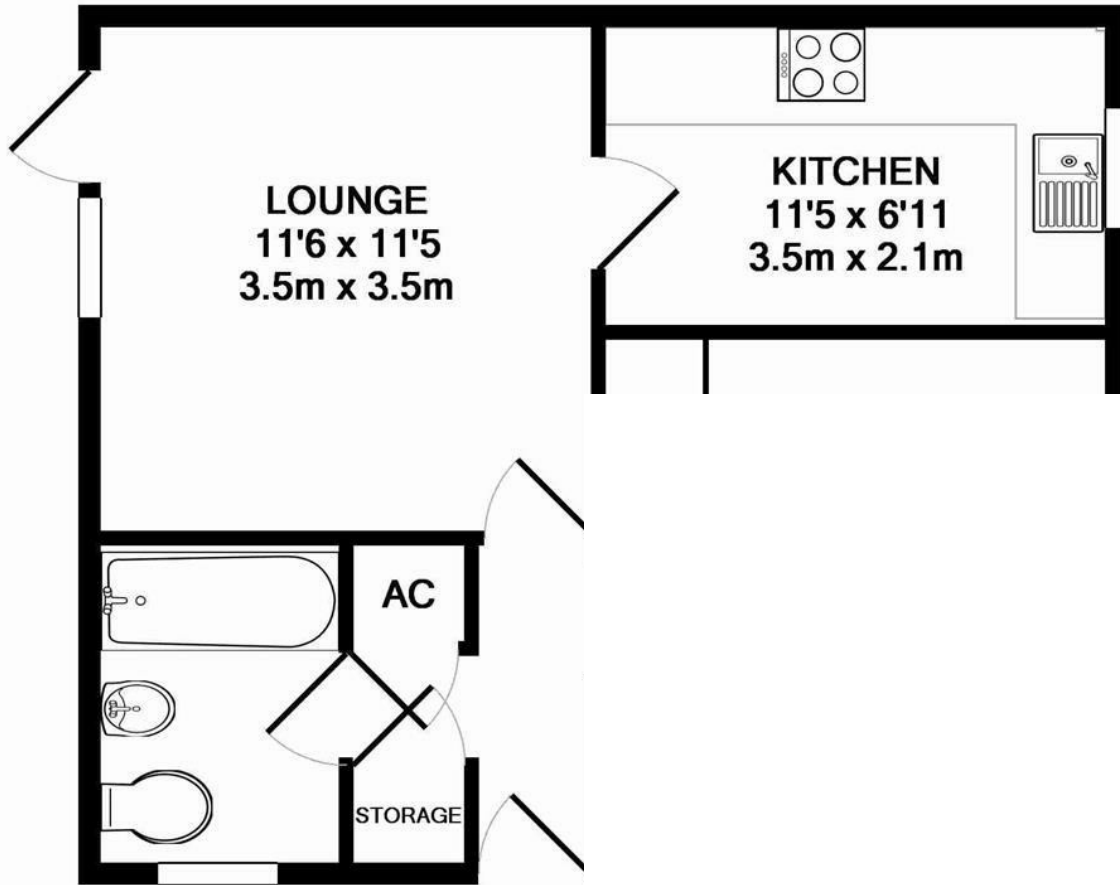

TOTAL APPROX. FLOOR AREA 380 SQ.FT. (35.3 SQ.M.)

Measurements are approximate and not to scale. Bedroom measurements do not take into account the fitted wardrobes. This plan is for illustrative purposes only and should only be used as such by any prospective tenant. No responsibility is taken for any error, omission or mis-statement.
Made with Metropix ©2015

