



## Jersey Court Dairy Close

, London, SW6 4HB

**Asking price £900,000**

A two bedroom, two bathroom top floor penthouse apartment in the heart of Parsons Green with views of Central London.

Located on the sixth floor with lift access, this two double bedroom apartment with plenty of storage throughout is unique, stand alone with no neighbours either side of the apartment and only three other apartment on the same floor. With two separate modern bathrooms, one en-suite and a modern kitchen. The living room is bright and beautifully presented with wooden flooring throughout, leading out on to a large North-East al fresco balcony, which has wonderful views across the London skyline. There is an allocated parking space, bike storage and porter.

Jersey Court located in one of the best locations in Fulham being right in the heart of Parsons Green itself with shops, cafes, restaurants and convenient underground station (District Line - Zone 2) close to hand.

- Two double bedrooms
- Two bathrooms (one en-suite)
- 6th floor
- Lift access
- Porter
- Bike storage
- Off road allocated parking space
- EPC: C
- Very close to Parsons Green

### Viewing

Please contact our Hume Homes Office on 07714 659 220 if you wish to arrange a viewing appointment for this property or require further information.





Floor Plan

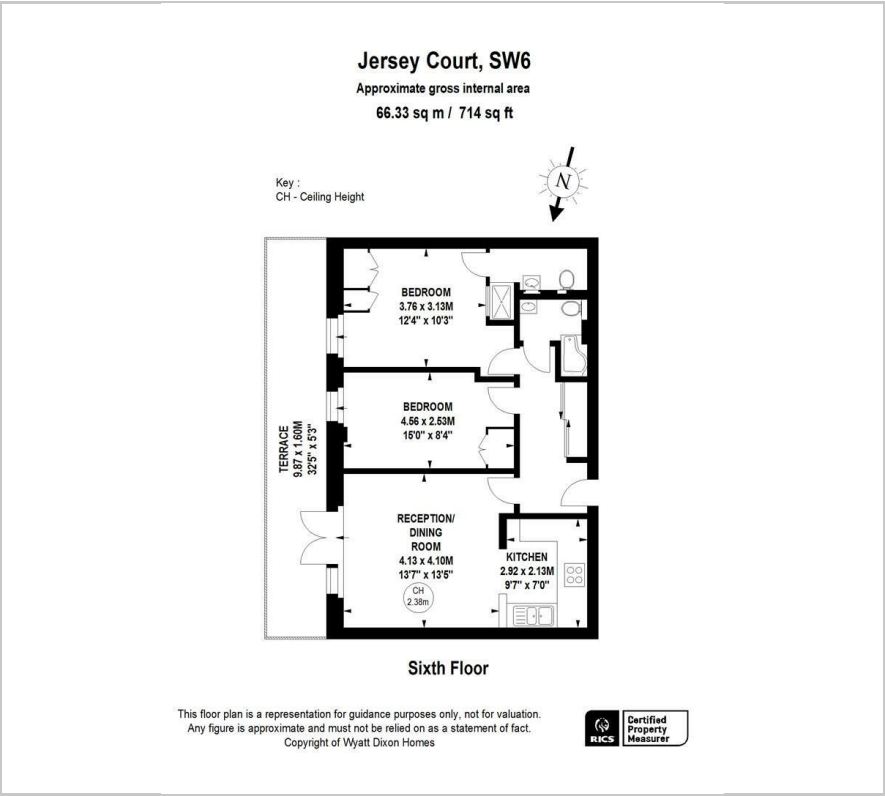

Area Map



Energy Efficiency Graph

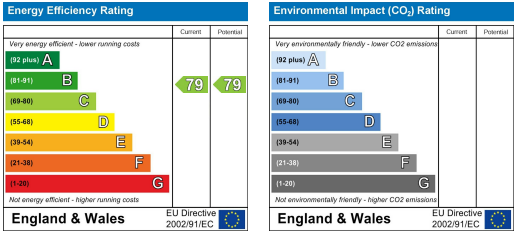

These particulars, whilst believed to be accurate are set out as a general outline only for guidance and do not constitute any part of an offer or contract. Intending purchasers should not rely on them as statements of representation of fact, but must satisfy themselves by inspection or otherwise as to their accuracy. No person in this firms employment has the authority to make or give any representation or warranty in respect of the property.