

PRIME LOCATION



APARTMENT 009, ASHTED WHARF, GLASSWATER LOCKS

Asking price

£289,950

FEATURES

- £30,000 Below Market Value
- Prime Investment Area
- August 2025 Completion
- 5 Minute Walk To HS2 Station
- Onsite Concierge, Gym, Cinema & Games Room
- South-Facing Balcony With Canal Views

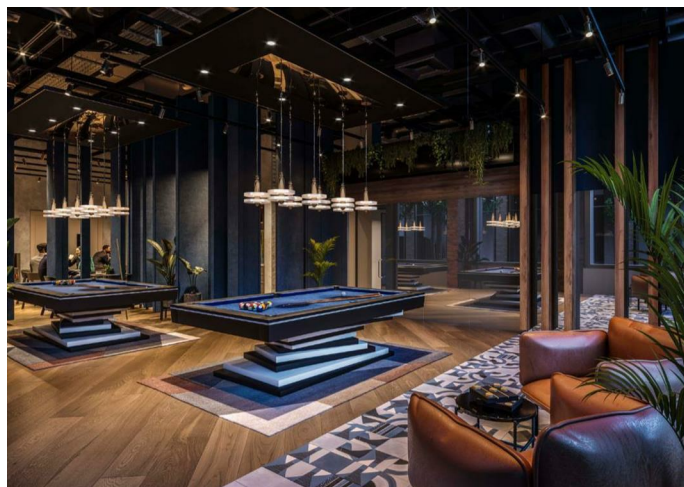

Canal-Facing 1 Bedroom Apartment - Glasswater Locks, Birmingham

****Below Market Value****

Discover unbeatable value with this stylish new build apartment in the highly desirable Glasswater Locks development on Belmont Row, offered below market value. Whether you're a first-time buyer or an investor, this is a prime opportunity to secure a modern home in one of Birmingham's most up-and-coming areas.

Set across 478 square feet, the apartment features a smart, light-filled layout designed for comfort and functionality. The open reception area is perfect for relaxing or entertaining, while the generously sized bedroom offers a peaceful retreat. A sleek, modern bathroom adds a touch of luxury with high-quality fixtures.

Just a 5-minute walk from the new HS2 station, this location is a commuter's dream and a strategic investment hotspot. With excellent transport links, local amenities, green spaces, and a thriving dining scene all within easy reach, the lifestyle on offer is both convenient and exciting.

More than just a place to live, this property represents a forward-thinking investment in a rapidly developing area. Don't miss your chance to own a standout home at exceptional value.

Lease Term: 250 years

Estimated Completion: August 2025

Purchase Available Through Contract Reassignment



Call us on

0121 667 0343

hello@swift-property.co.uk

www.swift-property.co.uk

Agents Note: Whilst every care has been taken to prepare these particulars, they are for guidance purposes only. All measurements are approximate and are for general guidance purposes only and whilst every care has been taken to ensure their accuracy, they should not be relied upon and potential buyers are advised to recheck the measurements.

