



258 Liverpool Road South, Merseyside, L31 7DH

Offers In Excess Of £130,000

Berkeley Shaw Real Estate are delighted to bring to the sales market this two bedroom ground floor apartment situated in this popular and sought after residential area, conveniently located for local amenities including Maghull central square. This home is offered with NO CHAIN.

The well planned and presented accommodation has the benefit of double glazing, electric storage heaters and briefly comprises, communal hallway, private entrance hall, living room with bay window, kitchen with fitted units including oven and hob, two bedrooms and bathroom with electric shower over the bath. There are communal parking spaces to front and communal gardens.

Get in touch to book a viewing straight away!

Leasehold with a peppercorn rent
999 years from 29th September 1964



Entrance Hall

Carpeted and painted

Living Room

14'8 x 11'9 (4.47m x 3.58m)

Carpeted and painted

Kitchen

12'9 x 8'8 (3.89m x 2.64m)

Painted and part tiled, vinyl floor

Bedroom 1

12'10 x 10'11 (3.91m x 3.33m)

Carpeted and painted

Bedroom 2

9'7 x 6'8 (2.92m x 2.03m)

Carpeted and painted

Bathroom

9'1 x 5'5 (2.77m x 1.65m)

Tiled and painted

Front Walled Garden

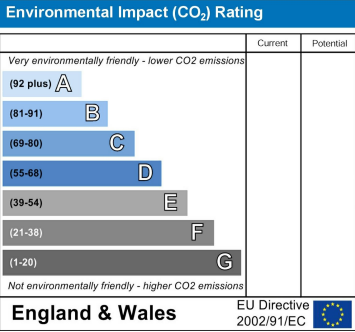
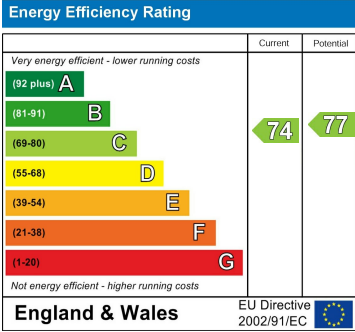

GROUND FLOOR
682 sq.ft. (63.4 sq.m.) approx.

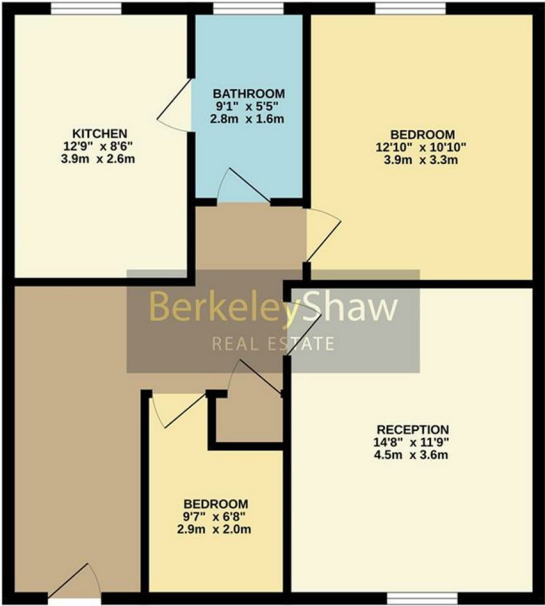

TOTAL FLOOR AREA - 682 sq.ft. (63.4 sq.m.) approx.
Whilst every attempt has been made to ensure the accuracy of the floorplan contained herein, measurements of doors, windows, rooms and any other items are approximate and no responsibility is taken for any error, omission or misstatement. This plan is for illustrative purposes only and should be used as such by only prospective purchaser. The services, systems and appliances shown have not been tested and no guarantee as to their operation or efficiency can be given.
Made with Metreplan 10025



Berkeley Shaw Estate Agents Limited.
Company No. 0784754

Berkeley Shaw Real Estate Limited.
Company No. 05206927

