

# DURDEN & HUNT

INTERNATIONAL



## Peaches Road, Colchester CO1

£1,500 Per Month

- Available Now
- Kitchen With Integrated Appliances
- Primary Bedroom With En Suite
- Family Bathroom
- Off Road Parking And Garage
- Good Sized Garden
- Two Further Bedrooms
- Modern Townhouse
- Generous Lounge
- Downstairs WC

1-3 Crouch Street, Colchester, CO3 3EN

<https://www.durdenandhunt.co.uk>

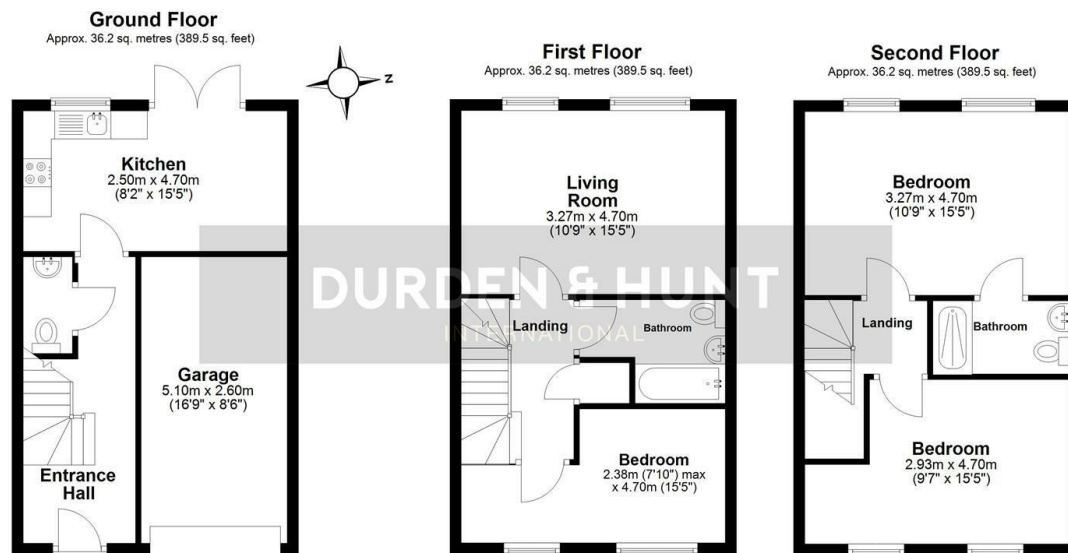

Total area: approx. 108.6 sq. metres (1168.6 sq. feet)

All measurements have been taken as a guide to prospective buyers only and are not precise. This plan is for illustrative purposes only and no responsibility for any error, omission or misstatement. The services, systems and appliances shown have not been tested and no guarantee as to their operability or efficiency can be given. Measurements may have been taken from the widest area and may include wardrobe/cupboard space. No guarantee is given to any measurements including total areas. Buyers are advised to take their own measurements.

© @modephotouk | www.modephoto.co.uk  
Plan produced using PlanUp.

Peache Road, Colchester



## Viewings

Viewings by arrangement only. Call to make an appointment.

## Council Tax Band

D

## EPC Rating:

C

Energy Efficiency Rating		
	Current	Potential
Very energy efficient - lower running costs		
(92 plus) <b>A</b>		88
(81-91) <b>B</b>	77	
(69-80) <b>C</b>		
(55-68) <b>D</b>		
(39-54) <b>E</b>		
(21-38) <b>F</b>		
(1-20) <b>G</b>		
Not energy efficient - higher running costs		
<b>England &amp; Wales</b>	EU Directive 2002/91/EC	