



GORDON MANSIONS
LONDON, WC1E

GRANT J BATES
— PROPERTY —



An interior designed four-bedroom lateral apartment in a charming mansion block in Fitzrovia

GJB

Gordon Mansions, London, WC1E

Leasehold

- Mansion Block
- Historic Connections
- Lateral Space
- 1750 Sq Ft
- Four Bedrooms
- Interior Designed
- Amazing Location
- First Floor
- Ample Period Detail
- Chain Free

Grant J Bates

Director

07868 848 732

grant@grantjbates.com



Description

This elegant first-floor apartment in a red-brick building was once home to Sir John Hurt, acclaimed for roles in *The Elephant Man*, *Alien*, and *Harry Potter*. Offering approx. 1,750 sq ft across a single level, it combines period grandeur with cinematic history in the heart of Fitzrovia.

The entrance hall impresses with Savuti wallpaper, original wood flooring, and high ceilings. The main reception room, ideal for entertaining, features full-width windows, an elegant fireplace, and ornate ceiling detail, with vibrant furnishings adding warmth and colour.

A moody hallway leads to a luxurious bathroom with a freestanding tub, a walk-in wardrobe (or fourth bedroom), and two large, stylish bedrooms—one with Liberty wallpaper, original flooring, sash window, and playful colour-blocked walls. A third bedroom sits quietly at the front.

The kitchen offers cottage charm with painted tiles, a pink Smeg fridge, range cooker, breakfast nook, and pantry—plus a guest WC and utility room. Here you could add a second bathroom, as well as

at other points such as the walk in wardrobe/fourth bedroom, or the storage cupboard.

Situation

Gordon Mansions lies in the heart of Fitzrovia, near Charlotte Street's celebrated restaurants, cosy cafés, and lively pubs. Cultural landmarks like The British Museum and local galleries are close, with Soho, Covent Garden, and Oxford Street nearby. Regent's Park offers green space just minutes away, and the area includes top-rated schools. Rich in literary and artistic heritage—from Virginia Woolf to Bob Marley—Fitzrovia is a rare mix of period charm and cosmopolitan energy, making Gordon Mansions truly special. Gardens are all moments from the property. Transport options, should they be needed are provided by Gloucester Road, Earls Court, and South Kensington Underground Stations. An ideally located charming London townhouse offering the best the city has to offer.

Additional Information

Local Authority: Camden

Council Tax Band: TBC

EPC Rating: D





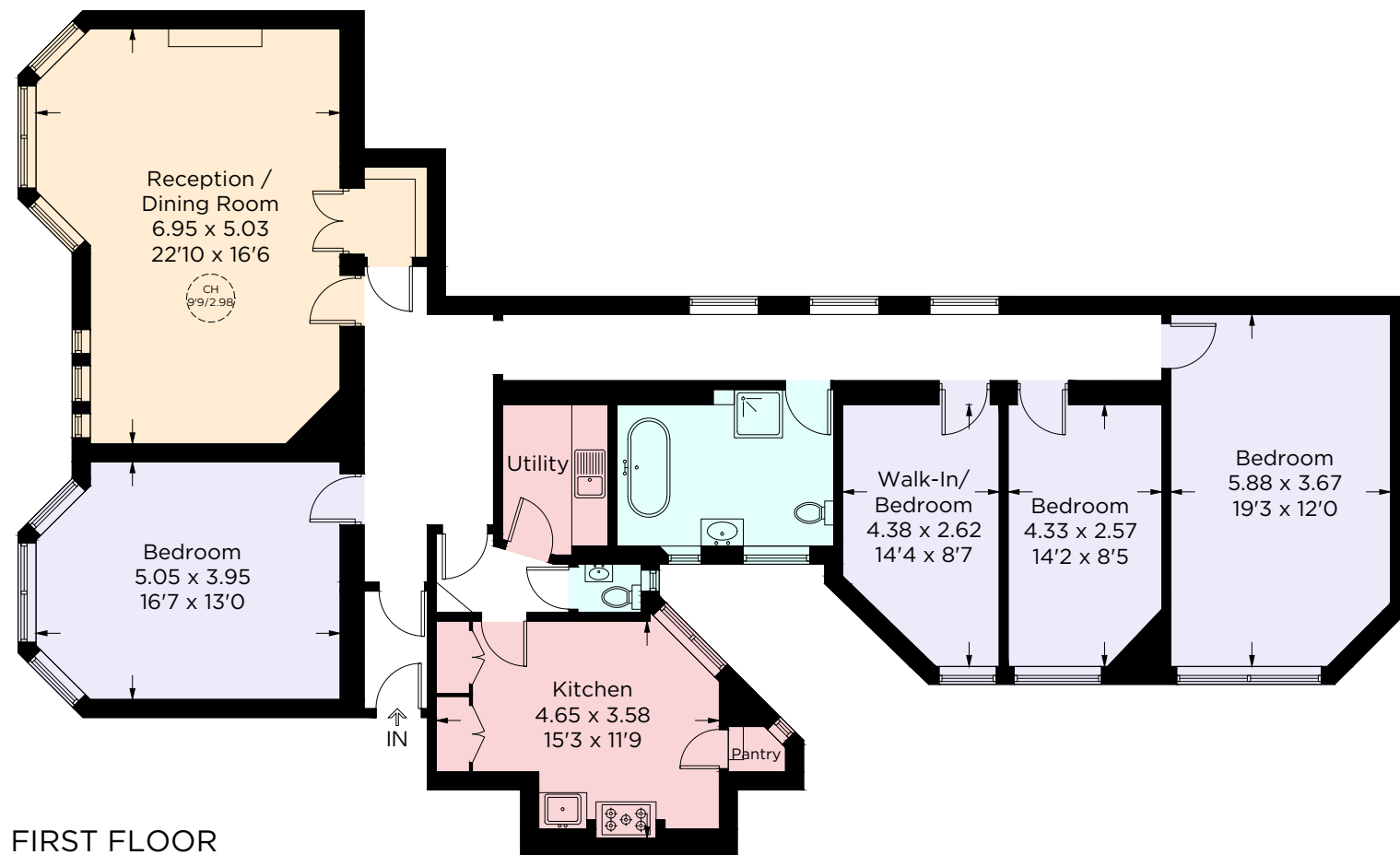

Gordon Mansions

Approximate Gross Internal Area = 162.5 sq m / 1749 sq ft

Important Notice: These sales particulars are prepared as a general guide only. We have not carried out a survey or tested appliances/fitings etc. Measurements are estimated and rounded, they are taken between the internal wall surfaces and therefore included cupboards and other joinery. The details should not be relied upon for carpets, floor coverings, fixtures, fittings, furnishings et al. All fixtures, fittings, furnishings, kitchen appliances, whether fitted or not, are deemed removable by the vendor unless otherwise stated or agreed specifically as part of any eventual sale.