







79 Hawksley Avenue

Newbold • Chesterfield • S40 4TJ

Guide Price £240,000 - £250,000

Extremely well presented two-bedroomed semi detached property in a prime location. Completely renovated internally to a high standard throughout featuring an extended kitchen diner, two double bedrooms, enclosed garden and detached garage. You will enter the property through the side entrance, leading to a traditional bay-windowed living room featuring a charming log burner. On the opposite side of the hallway, you'll find an extended open-plan kitchen and dining area with shaker-style cupboards. The kitchen is equipped with an integrated fridge freezer, Belfast sink, dishwasher, and washing machine. Additionally, the kitchen area includes a convenient downstairs WC and storage cupboard. The first floor features the principal bedroom with a bay window and a cast iron fireplace. There is also a generously sized second double bedroom. The traditionally updated and fully tiled bathroom includes a three-piece suite with a shower over the bath. The loft is accessible via a pull-down ladder and is fully boarded, complete with power sockets and a Velux window. Externally, the property boasts an east-facing rear garden with two sitting areas. The first sitting area features wooden decking, while the second is paved with Indian stone. To the side of the property, there is a detached garage that can be accessed from the front or through the garden via the side entrance. The property is within walking distance of the town centre and benefits from excellent transport links and bus services. It is also conveniently positioned close to various amenities and points of interest.





- Two Double Bedroom Semi-Detached House
- Completely Renovated & Extended To The Rear
- Bay Windowed Living Room With Log Burner
- Shaker Style Dining Kitchen
- Ground Floor W.C
- Superb Three-Piece Bathroom
- Generous Driveway & Detached Garage
- Enclosed Rear Garden With Decking & Patio
- Freehold
- Council Tax Band B





Ground Floor

Approx. 56.0 sq. metres (602.4 sq. feet)



First Floor

Approx. 35.3 sq. metres (379.9 sq. feet)

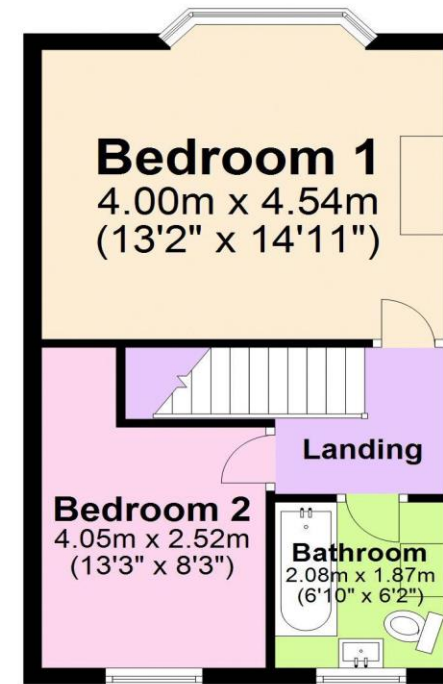

Total area: approx. 91.3 sq. metres (982.4 sq. feet)

