

London Road, SW16

£1,800 Per calendar month

A well-presented two bedroom flat in a purpose-built block featuring a spacious open-plan kitchen/ reception room, two good-sized bedrooms and a modern bathroom. Ideally located for transport links and local amenities. Suitable for professional couple or sharers.

The property offers easy access to Norbury High Street where a range of amenities and transport links can be found. Norbury Station has direct links London Victoria and London Bridge.

Features

- Two Double Bedrooms
- Open plan Reception Room
- One Bathroom
- Excellent Transport Links
- Close to Local Amenities
- Built in Wardrobes

London Road,
London, SW16

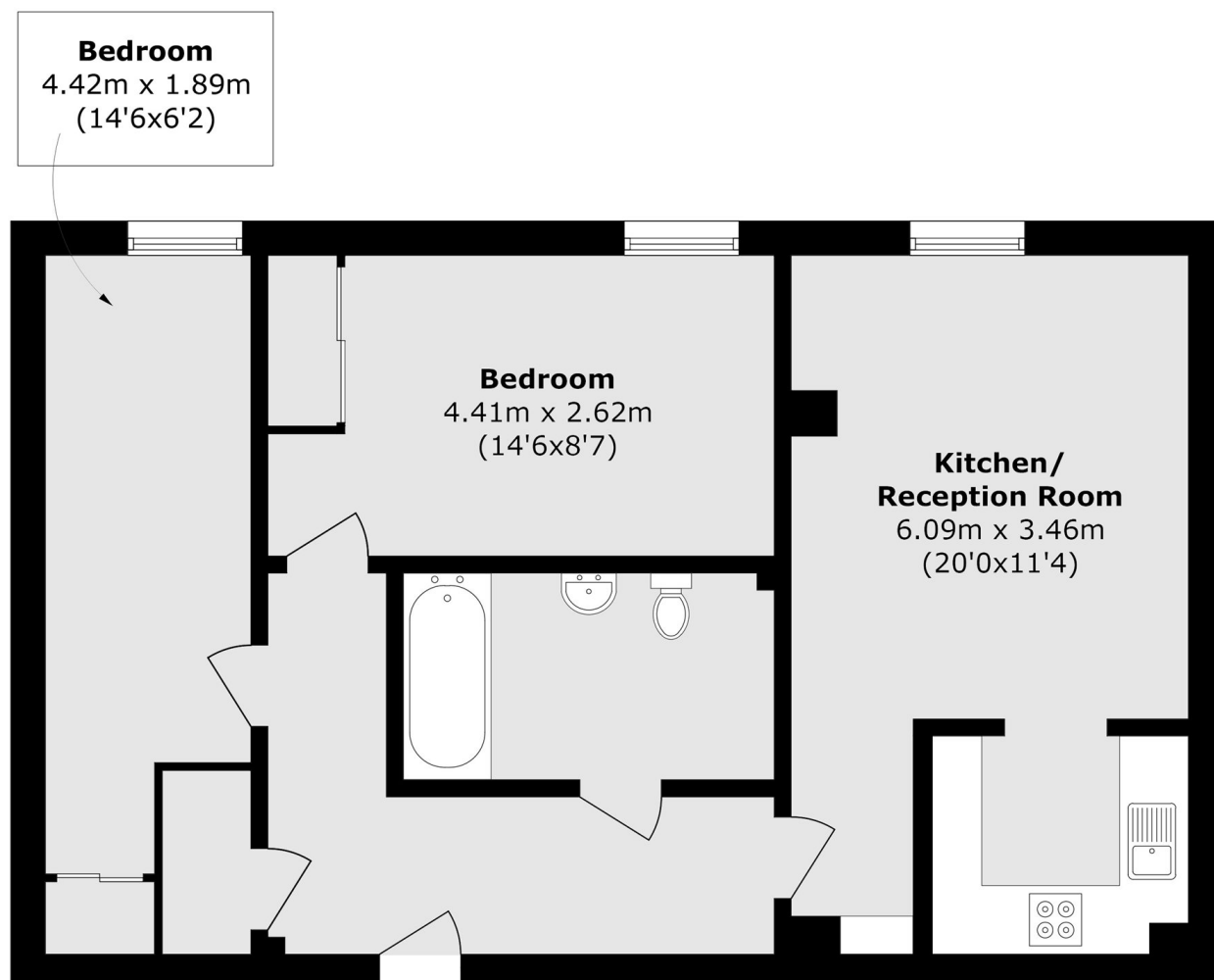

Total area (approx.): 60.6 sq. m (652.2 sq. ft)