



Bishops Park Road, SW16  
£425,000

**Dexters**



## Bishops Park Road, SW16

Located moments from Norbury station, this three double bedroom, ground floor apartment is presented in excellent condition. Benefiting from a private garden and share of freehold.

The accommodation consists of three double bedrooms, reception room opening to a modern kitchen, updated bathroom and private rear garden.

Bishops Park Road is conveniently situated just 0.2 Miles from Norbury train station and the town centre, which offers a variety of local restaurants and shops. The property also benefits from easy access to local schools, including state and grammar schools, and the open green space of Norbury Park, making it an ideal location for families.

### Features

- Three bedrooms
- Ground floor
- Private garden
- Moments from station
- Share of freehold
- EPC











# Bishops Park Road, London, SW16

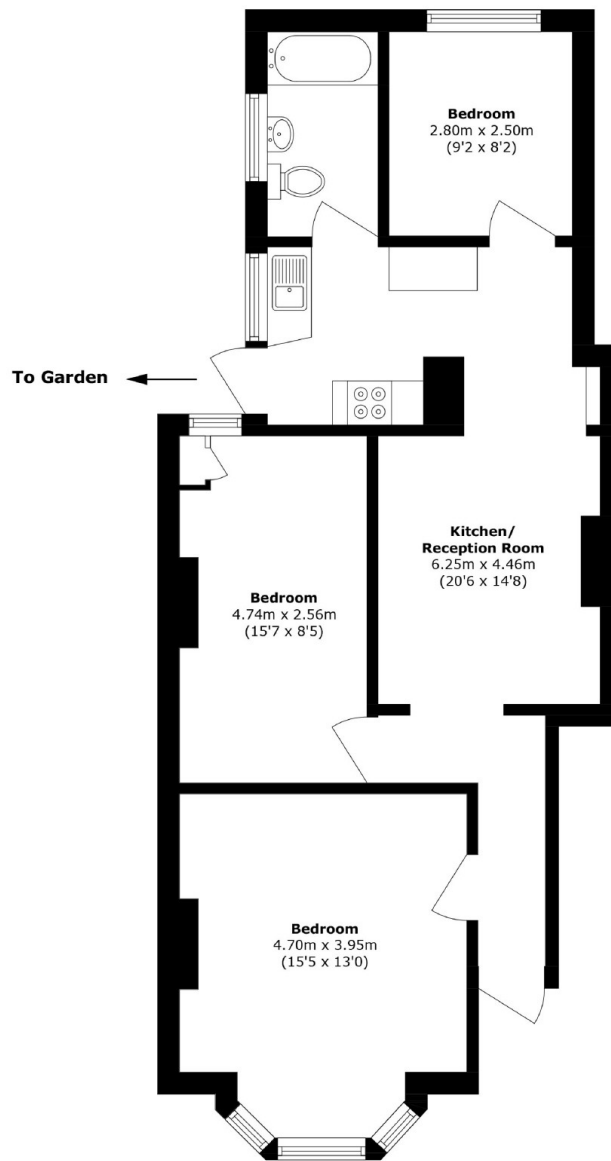

Total area (approx.): 69.3 sq. m (745.9 sq. ft)

## Dexters

Norbury  
1341 London Road  
Norbury  
SW16 4BE  
Sales  
020 8629 8028

Energy Rating: D. We aim to make our particulars both accurate and reliable. However they are not guaranteed; nor do they form part of an offer or contract. If you require clarification on any points then please contact us, especially if you're traveling some distance to view. Please note that appliances and heating systems have not been tested and therefore no warranties can be given as to their good working order.

 **RICS** | Regulated  
Estate Agent  
and Letting Agent

[dexters.co.uk](https://www.dexters.co.uk)