



## Crescent Way, SW16

£1,700 Per calendar month

Presenting a modern two bedroom conversion flat situated on a popular street in the highly desirable area close to Streatham Common. The property has recently been converted and has been finished to a very high standard.

### Features

Brand New Two Bedroom  
Conversion Flat  
Finished To High Standard  
Open Plan Kitchen/Reception  
Room  
Great Size Double Bedrooms  
Contemporary Bathroom  
Close To Streatham Common

# Crescent Way, London, SW16

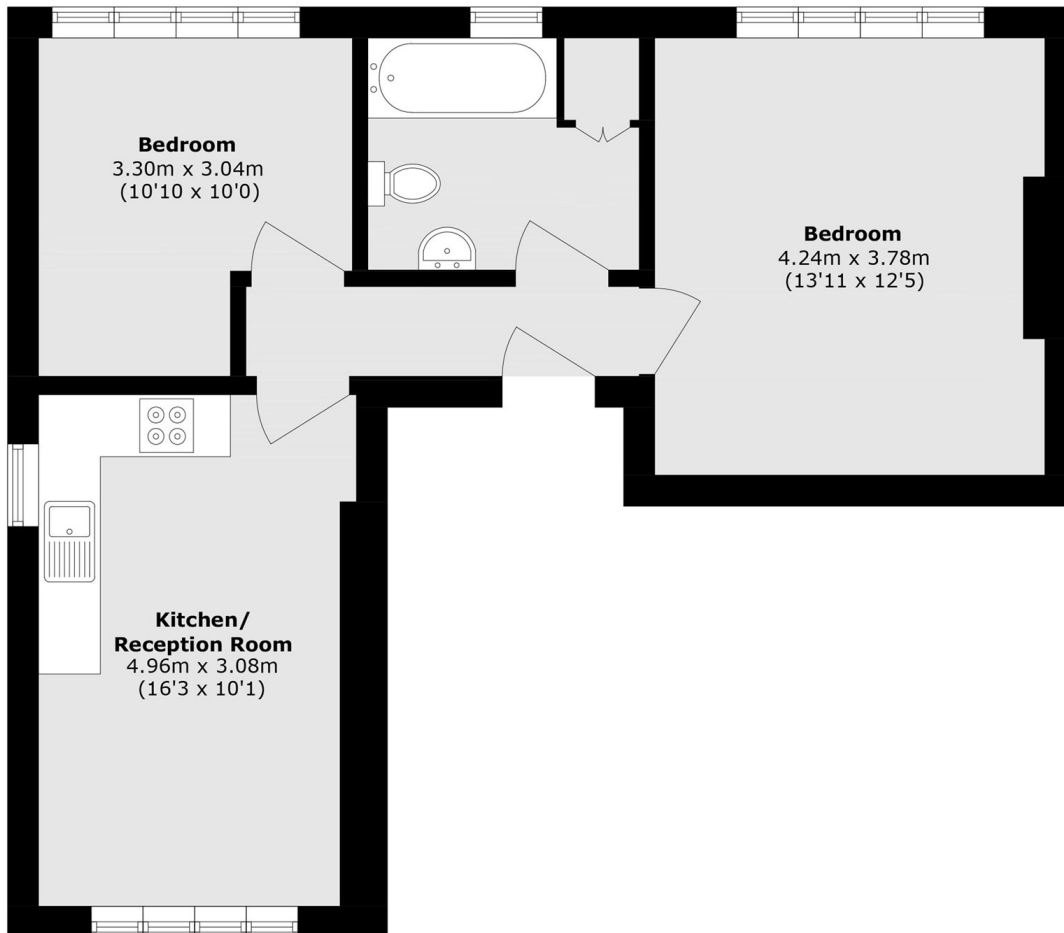

Total area (approx.): 51.4 sq. m (553.2 sq. ft)