

Tamworth Lane, CR4

£2,700 Per calendar month

This attractive four double-bedroom house has been neutrally decorated throughout and offers well-proportioned accommodation ideal for family living. The property comprises a bright and spacious reception room, a separate modern kitchen, four bedrooms, two bathrooms and a private garden.

Tamworth Lane is conveniently situated within close proximity to excellent local transport links, including numerous bus routes and rail services from Mitcham Eastfields Station, providing easy access to Central London and surrounding areas.

Features

- Four Bedrooms
- Private Garden
- Modern Kitchen
- Modern Bathroom
- Two Bathrooms
- Great Transport Links

Tamworth Lane, Mitcham, CR4

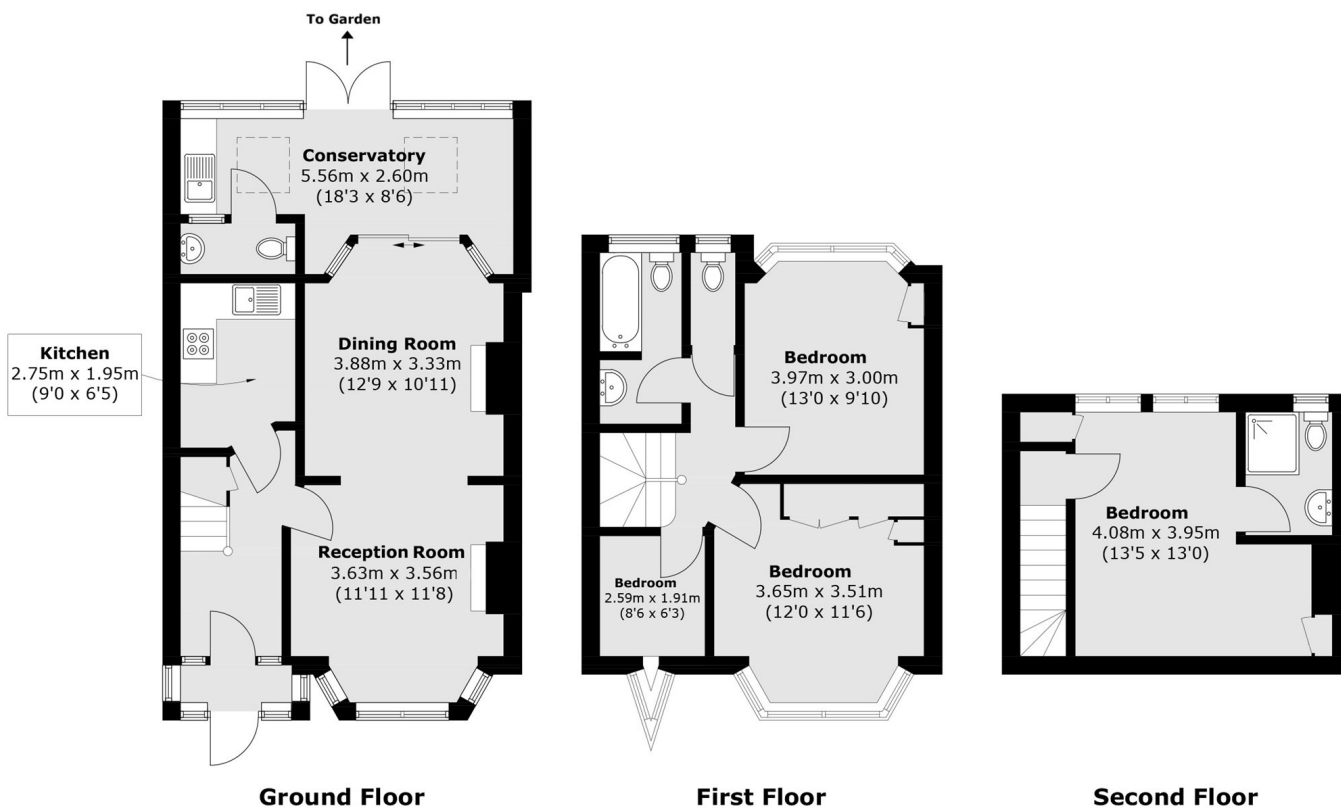

Total area (approx.): 111 sq. m (1,194.8 sq. ft)

Dexters

Norbury
1341 London Road
Norbury
SW16 4BE
Lettings
020 8629 8029

Energy Rating: . We aim to make our particulars both accurate and reliable. However they are not guaranteed; nor do they form part of an offer or contract. If you require clarification on any points then please contact us, especially if you're traveling some distance to view. Please note that appliances and heating systems have not been tested and therefore no warranties can be given as to their good working order.

 **RICS** | Regulated
Estate Agent
and Letting Agent

[dexters.co.uk](https://www.dexters.co.uk)