



London Road, SW16

£185,000

A well presented, one bedroom apartment with private balcony. Ideally located just 0.4 Miles from Norbury station making a perfect buy to let.

Radnor House is set just off Norbury town centre. The nearest mainline station, Norbury, is only 0.4 Miles away, offering regular rail services to London Bridge and London Victoria. The area is well served by highly regarded schools, with Norbury Park and Streatham Common also nearby, providing excellent recreational facilities.

Features

- One bedroom apartment
- Openplan living
- Modern finish
- Balcony
- 0.4 miles to station
- EPC: C

London Road,
London, SW16

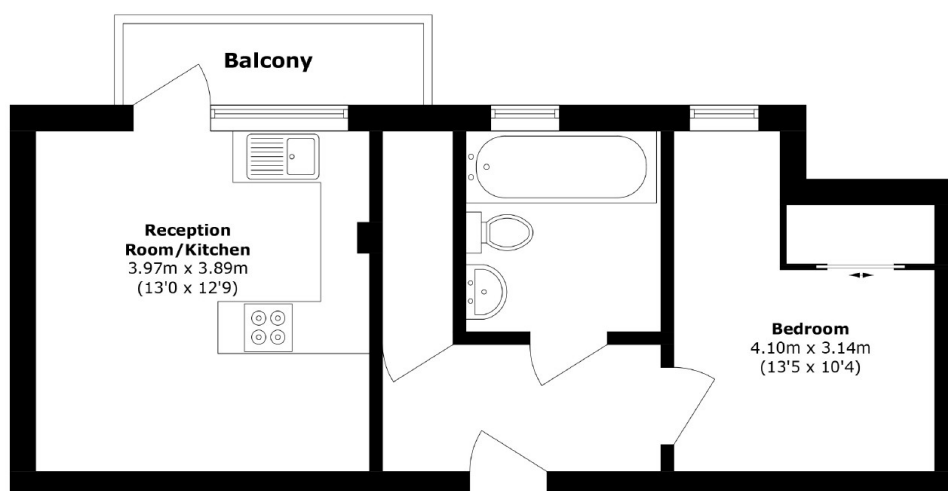

Total area (approx.): 40.0 sq. m (430.5 sq. ft)

Balcony area (approx.): 3.3 sq. m (35.5 sq. ft)

Dexters

Norbury
1341 London Road
Norbury
SW16 4BE
Sales
020 8629 8028

Energy Rating: C. We aim to make our particulars both accurate and reliable. However they are not guaranteed; nor do they form part of an offer or contract. If you require clarification on any points then please contact us, especially if you're traveling some distance to view. Please note that appliances and heating systems have not been tested and therefore no warranties can be given as to their good working order.

 **RICS** | Regulated
Estate Agent
and Letting Agent

[dexters.co.uk](https://www.dexters.co.uk)