



Sherwood Avenue, SW16

£550,000

A three bedroom family home with an updated kitchen and bathroom located in Streatham Vale.

Sherwood Avenue is ideally placed for two mainline stations with links to London Victoria, London Bridge as well as trains to East Croydon for Gatwick Airport. Streatham High Road is close by as are the open spaces of Streatham Common and the Rookery.

Features

- Three bedrooms
- Double reception
- Chain free
- Large garden
- Separate kitchen
- EPC



Sherwood Avenue, SW16

The accommodation comprises a through reception room with modern galley kitchen. Upstairs are two double bedrooms, a further single bedroom and an updated family bathroom. Outside the garden is south facing with additional rear access and garage.



Sherwood Avenue, London, SW16

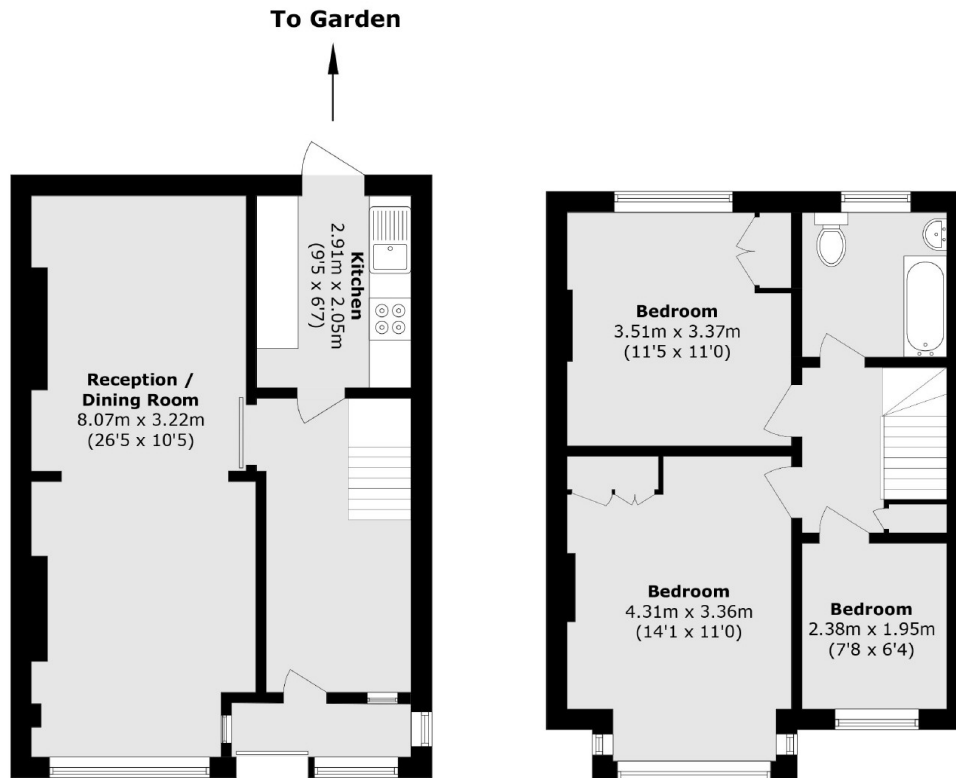

Total area (approx.): 84.49 sq. m (909.45 sq. ft)