



Fairview Road, SW16

£700,000

A four bedroom, end of terrace Edwardian home located just 0.1 miles from Norbury train station. Energy rating: E.

Fairview Road is conveniently situated just 0.1 Miles from Norbury train station and the town centre, which offers a variety of local restaurants and shops. The property also benefits from easy access to local schools, including state and grammar schools, and the open green space of Norbury Park, making it an ideal location for families.

Edwardian house, End of terrace, Four bedrooms, 0.1 miles from station, West facing garden, Energy rating: E

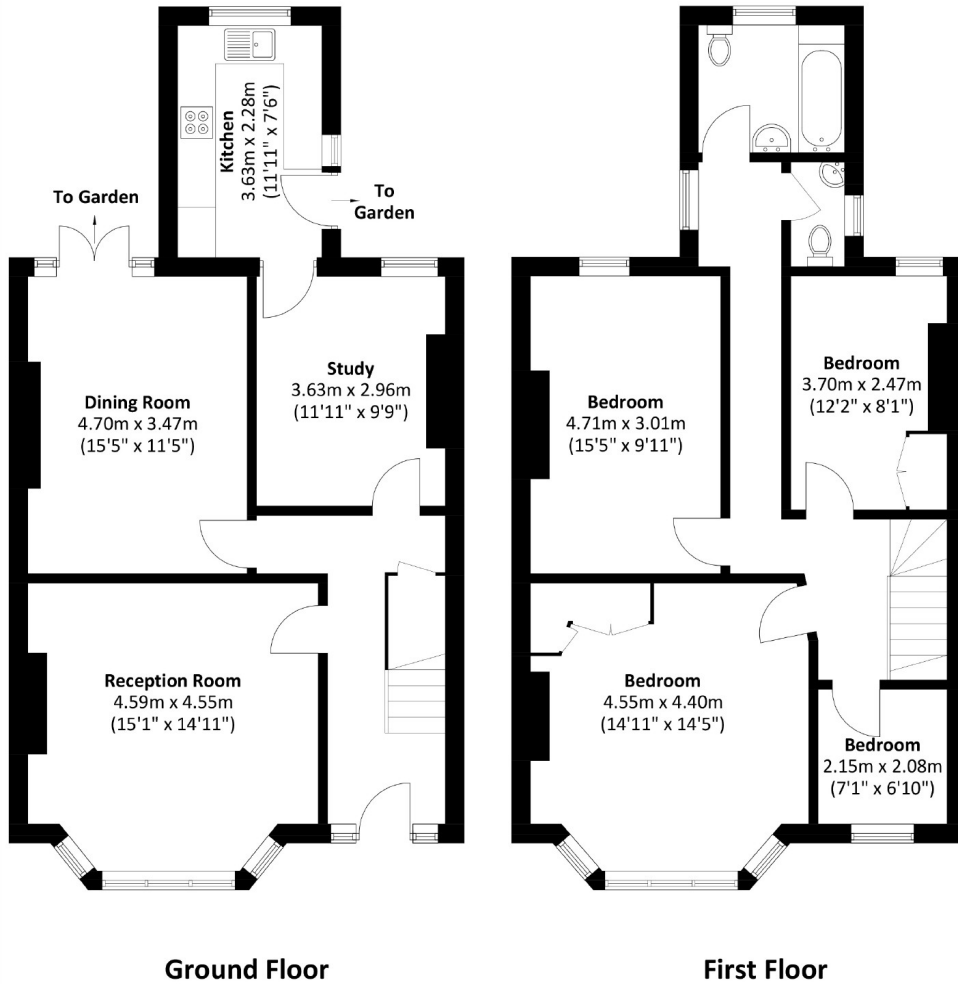

Total area: Approx. 137.2 sq. meters (1476.8 sq. feet)

James Alexander
1341 London Road,
Norbury, SW16 4BE
020 8629 8028
norburysales@jamesalexander.com

Energy Rating: E We aim to make our particulars both accurate and reliable. However they are not guaranteed; nor do they form part of an offer or contract. If you require clarification on any points then please contact us, especially if you're travelling some distance to view. Please note that appliances and heating systems have not been tested and therefore no warranties can be given as to their good working order.