



Victoria Road, Finsbury Park, London, United Kingdom, N4

£2,200 pcm

Beautifully presented, this two double bedroom, top-floor split-level period flat is set on a popular residential road close to excellent transport and shopping amenities. The property offers a spacious open-plan kitchen and reception room, two well-proportioned double bedrooms and a modern bathroom with shower. Wooden flooring runs throughout, while large sash windows allow natural light to flood the space, creating a bright and welcoming home. The location is ideal for commuters, with Finsbury Park Underground, Crouch Hill Overground and Haringay mainline stations all within approximately a ten-minute walk. Finsbury Park, with its fantastic outdoor facilities, and the Parkland Walk are close by, along with the wide selection of shops, cafés and restaurants along Stroud Green Road and Crouch End Broadway.

Hobarts Estate Agents
23 Ferme Park Road, Stroud Green, London, N4 4DS
stroudgreen@hobarts.co.uk
www.hobarts.co.uk
442083429000



- Two double bedrooms
- Open plan reception to modern kitchen
- Wooden floors
- Close to Finsbury Park transport hub
- Close to green spaces of Finsbury Park and The Parkland Walk
- Top floor split level
- Bathroom with shower
- Large sash windows
- Near excellent shops and amenities

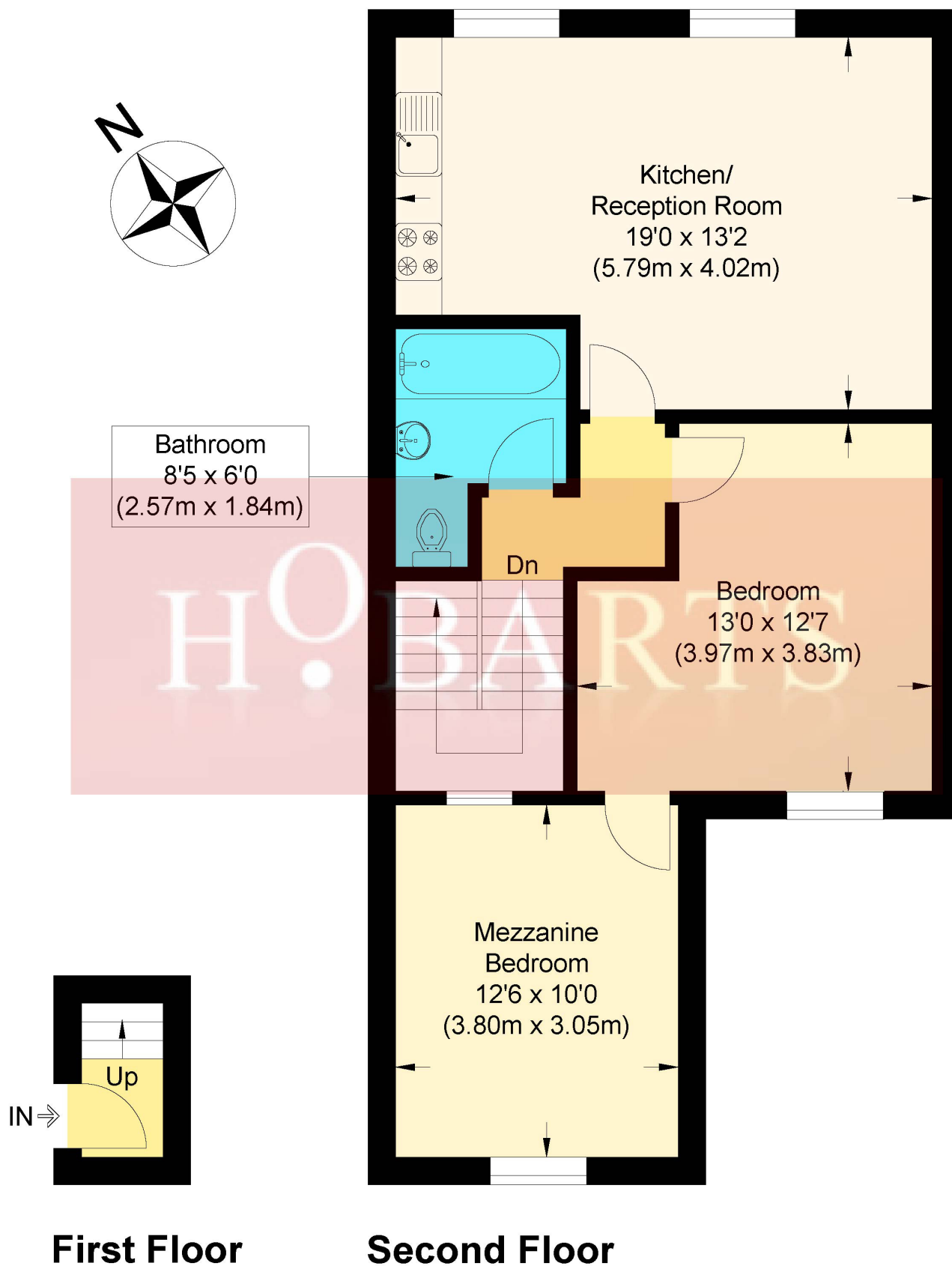

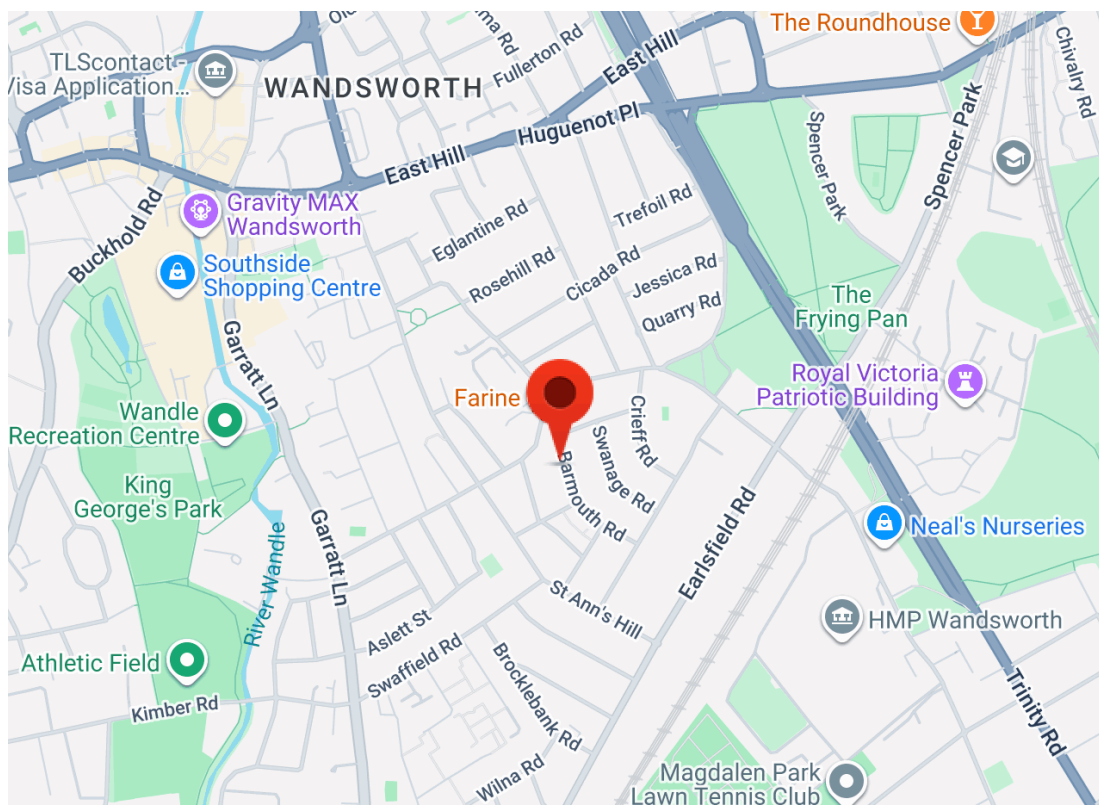

Score	Energy rating	Current	Potential
92+	A		
81-91	B		
69-80	C	73 C	79 C
55-68	D		
39-54	E		
21-38	F		
1-20	G		

Tenure:

Ground rent:

Service Charges:

Local Authority:

Viewings:

Strictly by appointment via
HOBARTS ESTATE AGENTS
442083429000

Contact:

23 Ferme Park Road, Stroud
Green, London, N4 4DS

stroudgreen@hobarts.co.uk
www.hobarts.co.uk

rightmove

PrimeLocation.com

homes24.co.uk

Zoopla.co.uk

propertyfinder.com



These property details, including measurements, floor plans and items depicted in photographs etc. are intended only as a brief guide to prospective purchasers and are not intended to be relied upon for any purpose whatsoever. Any interested party should satisfy themselves by inspection or otherwise as to the correctness of each statement contained in these details.