



Crouch End, N4 4SS

£1,800 pcm

Beautiful One-Bedroom Apartment set on the first floor of a charming converted Victorian House, offering a blend of period character and modern comfort. Spacious reception room, open to a stylish kitchen, ideal for both relaxing and entertaining. The property benefits from abundant natural light with its South-facing aspect, enhanced by refurbished sash windows and elegant wooden flooring throughout. Location being Just a 15-minute walk to Finsbury Park Underground Station (Victoria & Piccadilly lines, National Rail) and only 5 minutes from the vibrant heart of Crouch End.

Hobarts Estate Agents
23 Ferme Park Road, Stroud Green, London, N4 4DS
stroudgreen@hobarts.co.uk
www.hobarts.co.uk
442083429000



- Open-plan kitchen/reception
- Refurbished sash windows
- Views of the city in winter
- Crouch End Broadway a short walk

- Bathroom with shower
- Overlooks The Parkland Walk
- Wooden floors

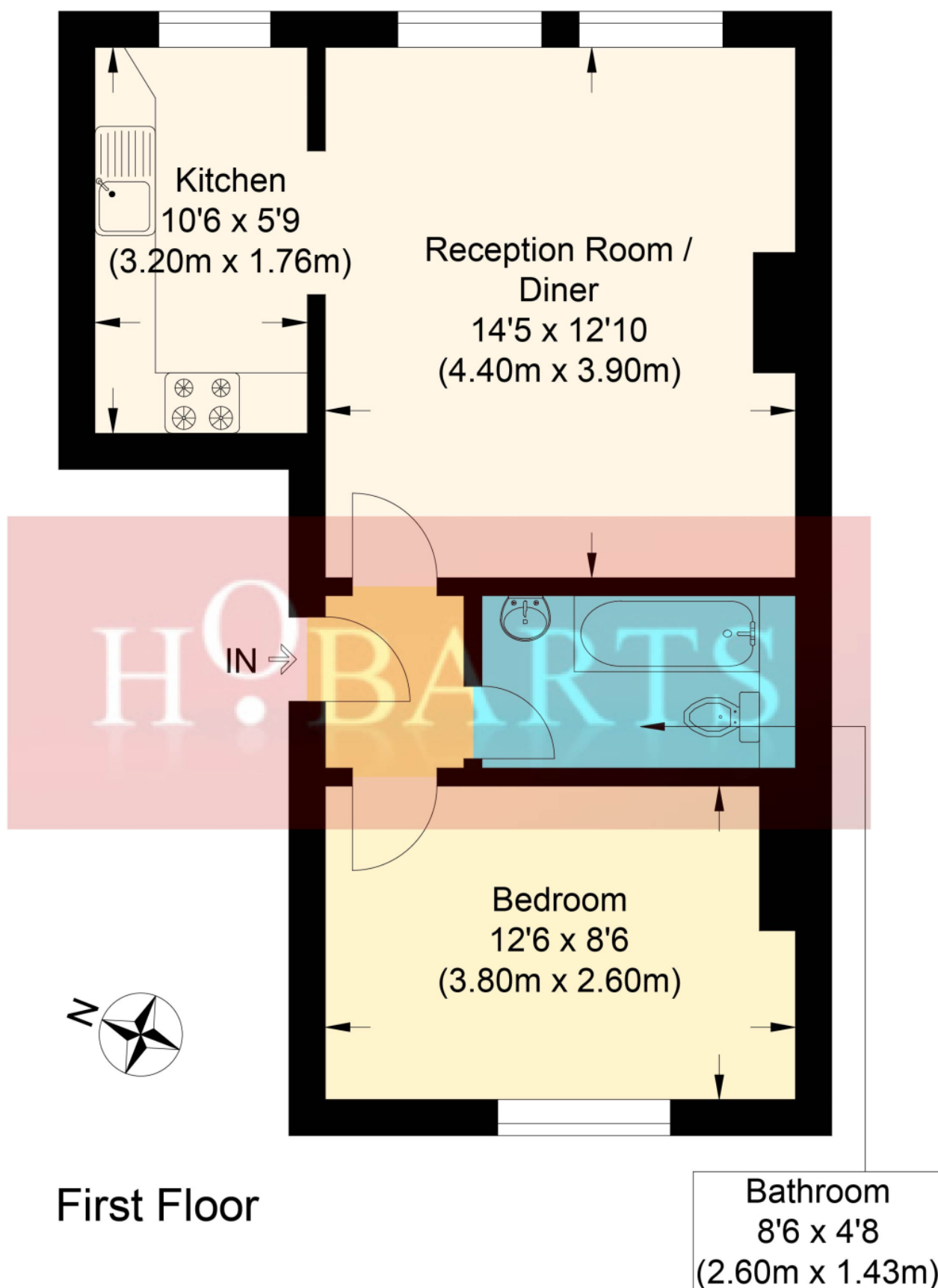
**Mount View Road N4**

Approximate Gross Internal Floor Area : 40.20 sq m / 432.70 sq ft

Illustration for identification purposes only, measurements are approximate, not to scale.

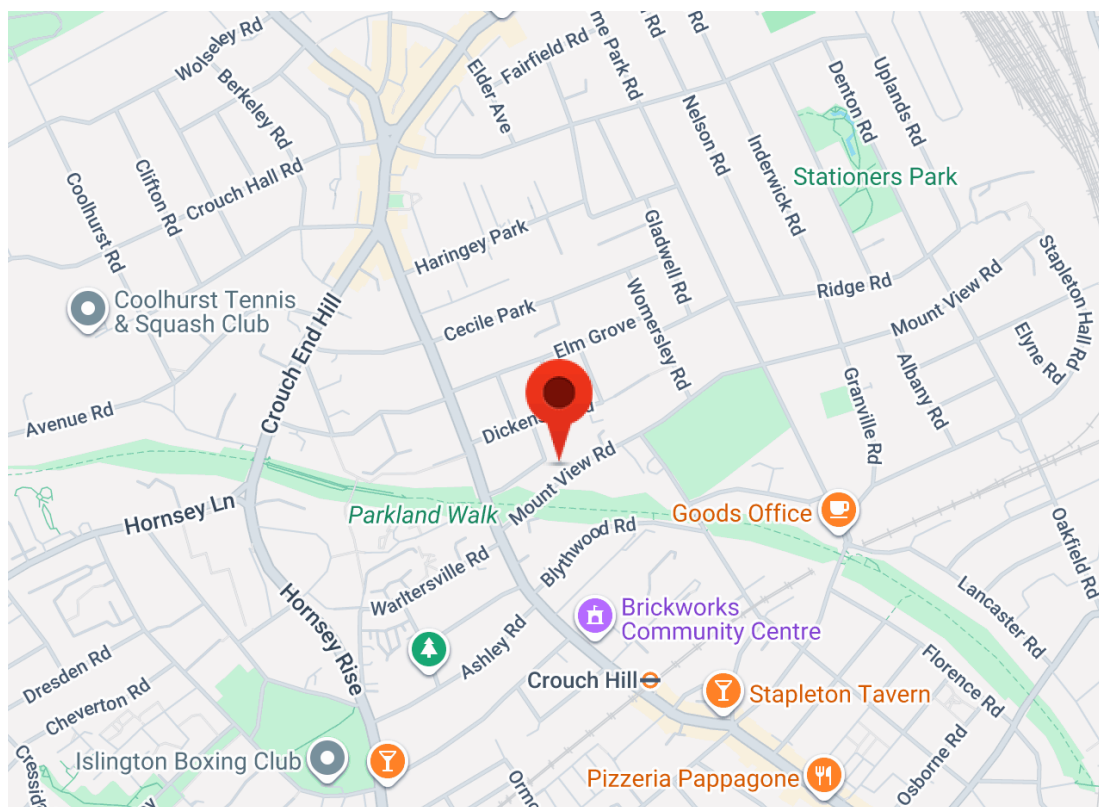

Score	Energy rating	Current	Potential
92+	A		
81-91	B		
69-80	C		
55-68	D		61 D
39-54	E	44 E	
21-38	F		
1-20	G		

Tenure:**Ground rent:****Service Charges:****Local Authority:****Viewings:**

Strictly by appointment via
HOBARTS ESTATE AGENTS
442083429000

Contact:

23 Ferme Park Road, Stroud
Green, London, N4 4DS

stroudgreen@hobarts.co.uk
www.hobarts.co.uk

rightmove

PrimeLocation.com

homes24.co.uk

Zoopla.co.uk

propertyfinder.com



These property details, including measurements, floor plans and items depicted in photographs etc. are intended only as a brief guide to prospective purchasers and are not intended to be relied upon for any purpose whatsoever. Any interested party should satisfy themselves by inspection or otherwise as to the correctness of each statement contained in these details.