



Ossian Road, Stroud Green, N4

£2,200 pcm

Superb opportunity to let this first floor, split-level two bedroom flat completely re furnished from top to bottom. Modern kitchen opening to reception, modern shower room, two double bedrooms. Benefits from new wood effect flooring, double glazed windows, new boiler and kitchen appliances. The Parkland Walk on your doorstep. Local amenities on Stroud Green Road and Crouch End Broadway close by. Transport connections at Finsbury Park tube and Crouch Hill over ground. Furnished/part furnished, available now. Close to local amenities, transport links and green spaces.

Hobarts Estate Agents  
23 Ferme Park Road, Stroud Green, London, N4 4DS  
stroudgreen@hobarts.co.uk  
www.hobartsproperty.co.uk  
442083429000







- Refurbished through out
- Split Level Victorian House
- Modern shower room
- Crouch Hill over ground
- Crouch End Broadway

- Two double bedrooms
- Open plan reception to kitchen
- The Parkland Walk on your doorstep
- Finsbury Park tube

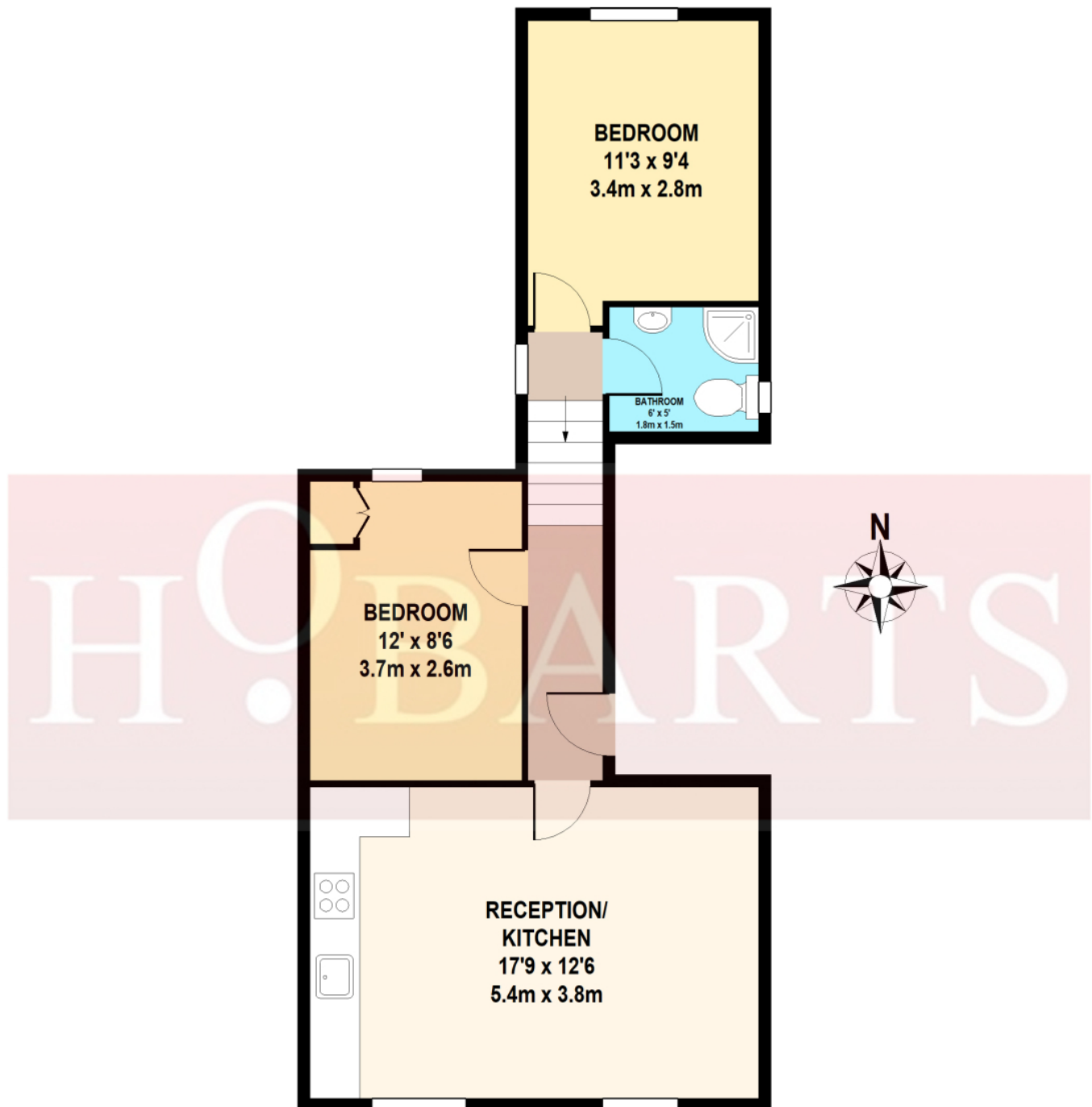

FIRST FLOOR

OSSIAN ROAD  
TOTAL APPROX. FLOOR AREA 528 SQ.FT. (49 SQ.M.)

Whilst every attempt has been made to ensure the accuracy of the floor plan contained here, measurements of doors, windows, rooms and any other items are approximate and no responsibility is taken for any error, omission, or mis-statement.

This plan is for illustrative purposes only and should be used as such by any prospective purchaser.

The services, system and appliances shown have not been tested and no guarantee as to their operability or efficiency can be given.



Score	Energy rating	Current	Potential
92+	A		
81-91	B		
69-80	C	79 C	79 C
55-68	D		
39-54	E		
21-38	F		
1-20	G		

**Tenure:****Ground rent:****Service Charges:****Local Authority:****Viewings:**

Strictly by appointment via  
HOBARTS ESTATE AGENTS  
442083429000

**Contact:**

23 Ferme Park Road, Stroud  
Green, London, N4 4DS

stroudgreen@hobarts.co.uk  
www.hobartsproperty.co.uk

rightmove

PrimeLocation.com

homes24.co.uk

Zoopla.co.uk

propertyfinder.com



These property details, including measurements, floor plans and items depicted in photographs etc. are intended only as a brief guide to prospective purchasers and are not intended to be relied upon for any purpose whatsoever. Any interested party should satisfy themselves by inspection or otherwise as to the correctness of each statement contained in these details.