



Mermaid Court, Railway Approach, Haringey, N4 1RG

Asking Price £360,000

This one-bedroom, top-floor apartment boasts an enviable location, just a stone's throw from Harringay Station and within walking distance of the vibrant Green Lanes shopping and dining district. The property also benefits from proximity to local grocery stores, coffee shops, Finsbury Park, and the charming Crouch End area.

The apartment features a spacious living area with an open-plan kitchen/diner, a generous double bedroom, and a separate bathroom. Additional benefits include two storage cupboards, attic storage, and off-street parking.

Offered chain-free, this property represents an excellent opportunity for a wide range of buyers.

Hobarts Estate Agents
 23 Ferme Park Road, Stroud Green, London, N4 4DS
stroudgreen@hobarts.co.uk
www.hobartsproperty.co.uk
 442083429000



- Kitchen/Diner
- Double Bedroom
- Just minutes' walk from Harringay Station
- Offered Chain-free
- Attic Storage
- Spacious Living Area
- Storage Cupboards
- Just minutes' walk from local amenities
- Off-Street Parking Space

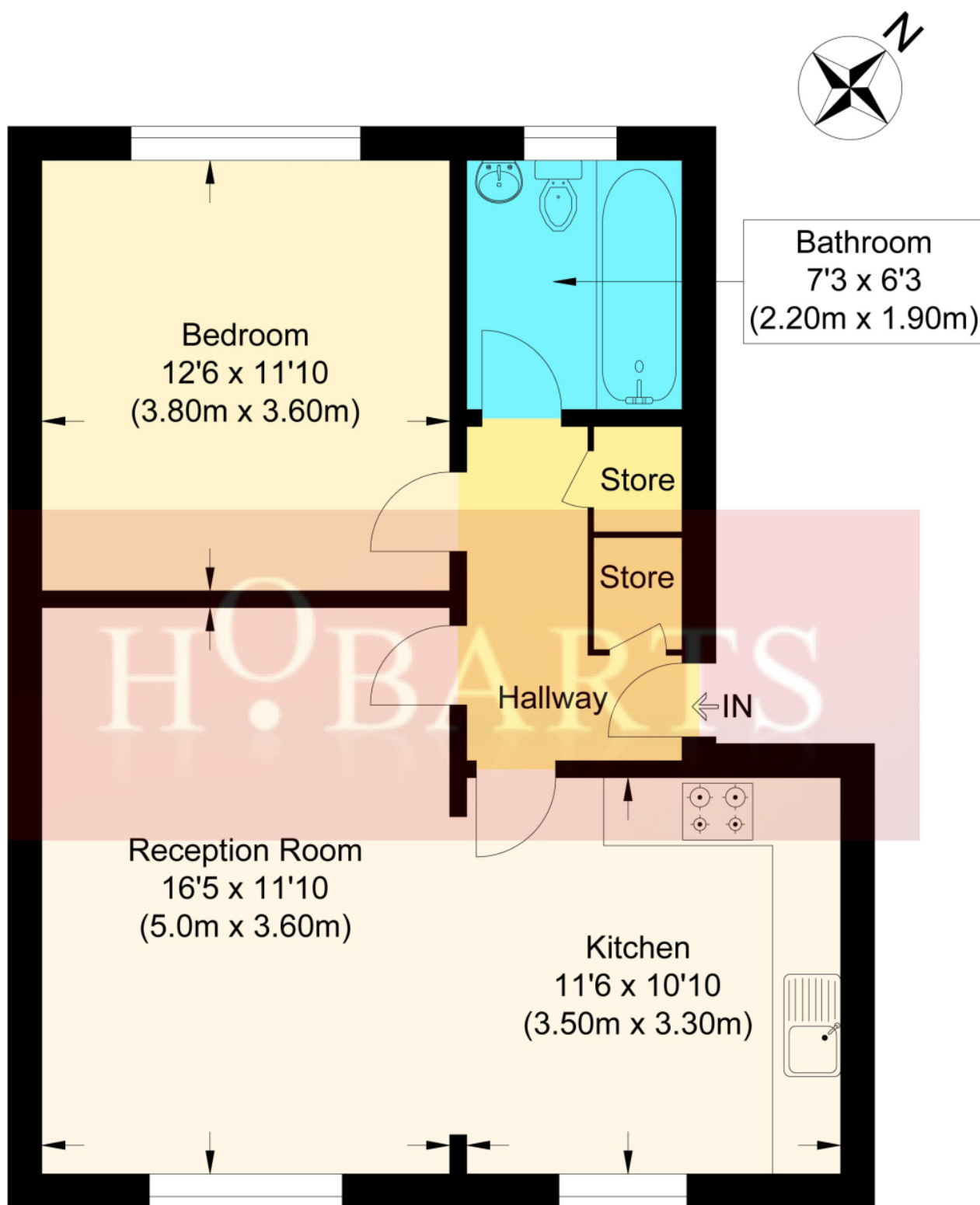

Third Floor

Marmaid Court

Approximate Gross Internal Floor Area : 55.50 sq m / 597.39 sq ft

Illustration for identification purposes only, measurements are approximate, not to scale.

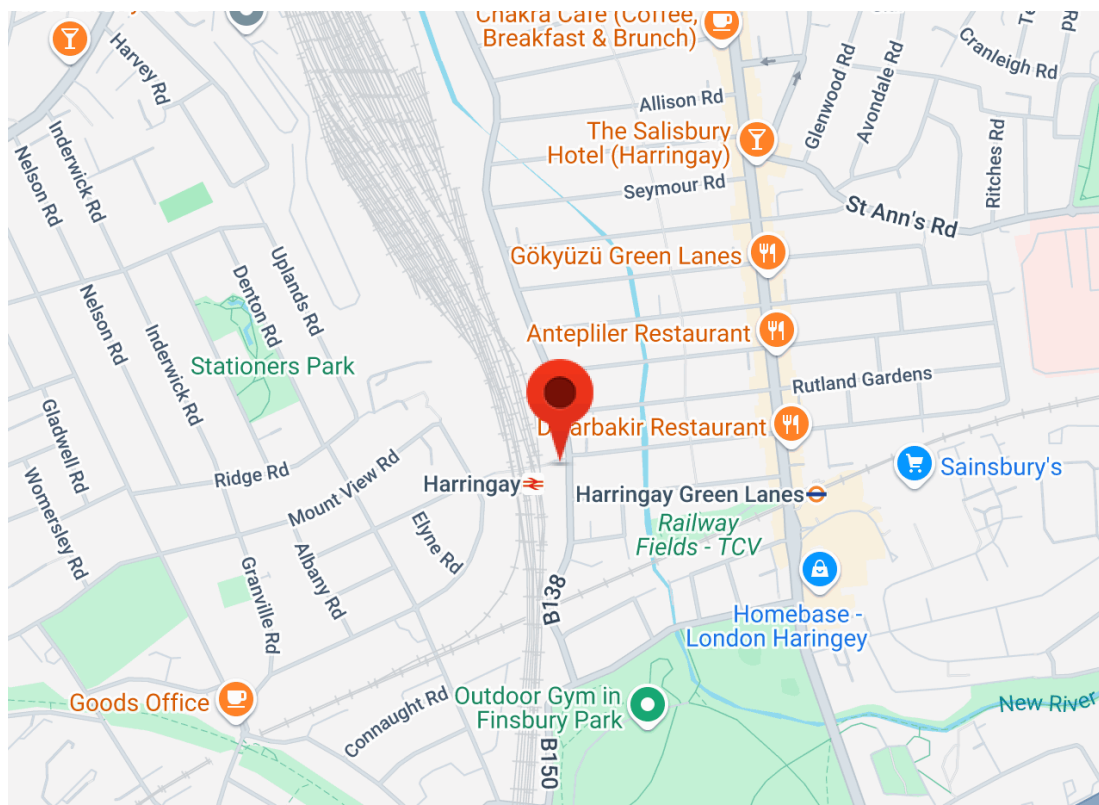

Score	Energy rating	Current	Potential
92+	A		
81-91	B		
69-80	C	75 C	77 C
55-68	D		
39-54	E		
21-38	F		
1-20	G		

Tenure:

Leasehold

Ground rent:**Service Charges:****Local Authority:****Viewings:**

Strictly by appointment via
HOBARTS ESTATE AGENTS
442083429000

Contact:

23 Ferme Park Road, Stroud
Green, London, N4 4DS

stroudgreen@hobarts.co.uk
www.hobartsproperty.co.uk

rightmove

PrimeLocation.com

homes24.co.uk

Zoopla.co.uk

propertyfinder.com



These property details, including measurements, floor plans and items depicted in photographs etc. are intended only as a brief guide to prospective purchasers and are not intended to be relied upon for any purpose whatsoever. Any interested party should satisfy themselves by inspection or otherwise as to the correctness of each statement contained in these details.